

# LEVELLERS

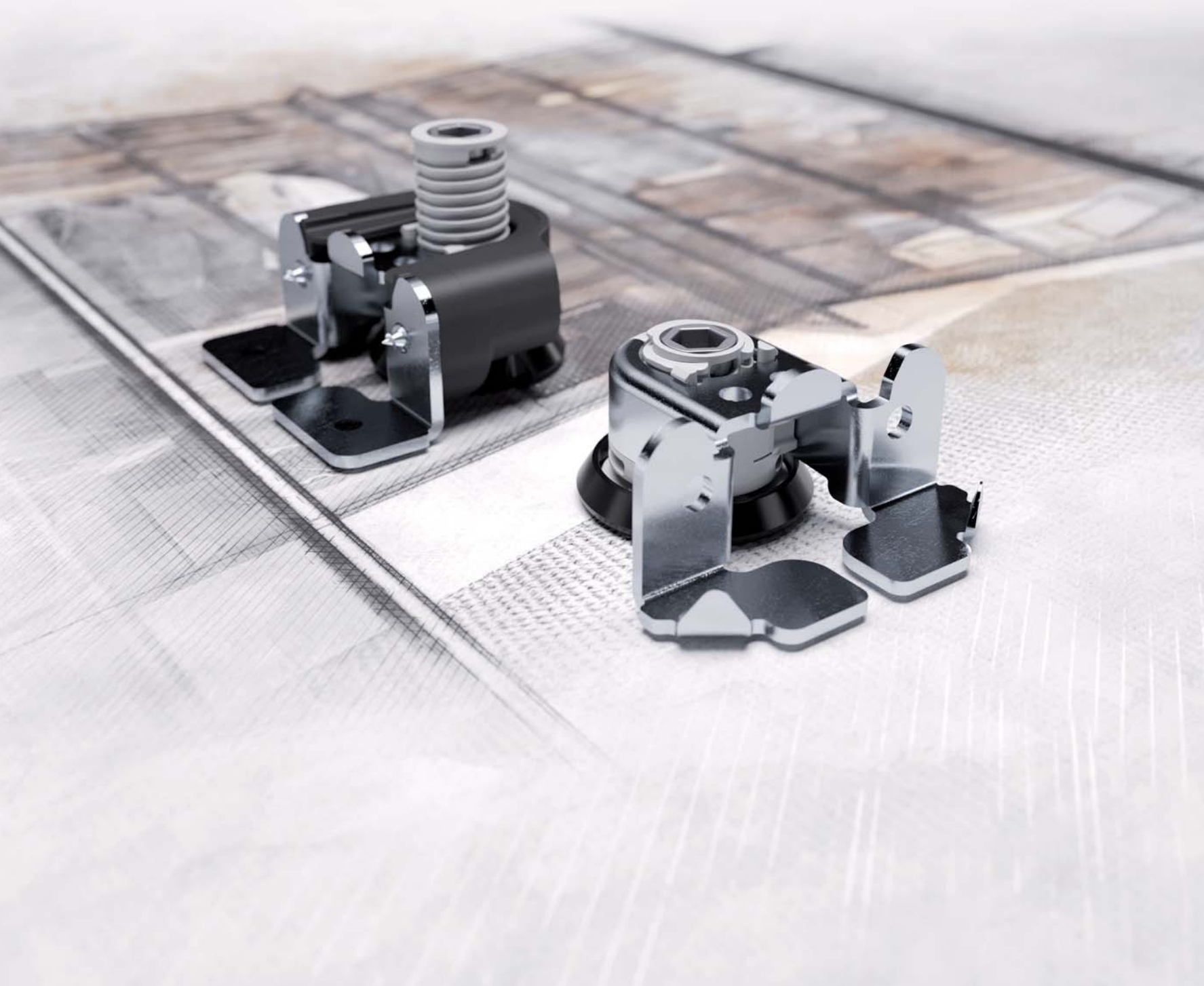



# SYMBOLS AND FINISHES LEGEND

## SYMBOLS

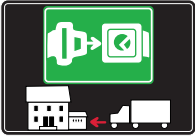

= SHELF SAFELY LOCKED DURING TRANSPORTATION AND AT HOME.



= ANTI-TURNOVER LOCKING SYSTEM



= NORMS / PATENTS



= PHILLIPS / POZIDRIV



= WITH BUFFER



= PART NO.



= BLADE SLOT



= WITH MAGNET



= PCS. PER PACKAGE



= COMBI SLOT



= HEXAGONAL SOCKET



= NEWTON



= CAPACITY LOADING



= HEXALOBULAR SOCKET



= FRICTION



= WOOD / GLASS THICKNESS



= COUNTERSUNK HEAD



= AUTOMATIC



= HOLE DIAMETER



= PAN HEAD



= DROP DOWN



= DIAMETER



= FLANGE HEAD



= LENGTH



= FLAT HEAD



= STANDARD HINGE



= HEIGHT



= TRILOBULAR SCREW



= KIMANA HINGE



= RIGHT VERSION



= SELF-TAPPING SCREW



= FLAP HINGE



= LEFT VERSION



= EURO THREAD



= WITH SPRING



= SETTING CODE



= METRIC THREAD



= WITHOUT SPRING



= PCS. PER PAD



= PRE-INSERTED SCREW



= REVERSED SPRING



= CUT ON REQUEST



= PRE-INSERTED SCREW AND SPREADING BUSH



= SELF ADHESIVE



= WITH FLANGE

NOTE: Printing errors and omissions may exist despite our best efforts to ensure accuracy. We reserve the right to alter specifications without notice.

## MATERIALS

**ZA** = Zinc Alloy

**ST** = Steel

**HSS** = High Speed Steel

**BR** = Brass

**ABS** = Acrylonitrile Butadiene Styrene

**ZAnk** = Nickel-plated Zinc Alloy

**STzk** = Zinc-plated Steel

**AL** = Aluminium

**WD** = Wood

**EVA** = Ethylene Vinyl Acetate

**EP** = **ENGINEERING PLASTIC**

+ **EP** = other engineering plastic available on request

**SR** = **SOFT RUBBER**

+ **SR** = other soft rubber available on request

**EPn** = Natural Engineering Plastic

**EPc** = Clear Engineering Plastic

**SRn** = Natural Soft Rubber

**EPw** = White Engineering Plastic

**EPg** = Grey Engineering Plastic

**SRw** = White Soft Rubber

**EPwg** = Water Green Engineering Plastic

**EPa** = Anthracite Engineering Plastic

**SRb** = Black Soft Rubber



## FINISHES



+ **OTHER FINISHES AVAILABLE ON REQUEST**

PART NO.	FINISHES	PART NO.	FINISHES	PART NO.	FINISHES
00	Insignificant finish	IF	Middle Grey	RO	Red
AA	Natural	IJ	Light Grey	UT	T-Met 9007
AB	White	IL	Grey 20	UZ	T-Met
AE	White 9010	IN	Grey met. 26	WA	Bronzed
EA	Black	JB	Bright Aluminium	WI	Burnished
EC	Matt Black	JC	Aluminium - Chrome	XD	Satin-finished Steel
EE	Anthracite	JD	Matt Aluminium	YA	Nickel-plated
EW	Grey 9007	JE	Satin-finished Aluminium	YB	Bright Nickel-plated
FU	Gunmetal	JF	Aluminium - Brass	YC	Matt Nickel-plated
FV	Gunmetal V52	JG	Aluminium 5	YD	Satin-finished Nickel-plated
GR	Raw	JL	Aluminium PE 11	YQ	Black Nickel
HA	Brass-Plated	JM	Aluminium RAL 9006	Z9	Black Zinc
HH	Tropicalized	KA	Chrome	ZA	Zinc alloy
HL	Raw Brass	KB	Bright Chrome	ZN	Zinc-plated
HX	Graphite	KC	Matt Chrome	ZQ	Bright Gold
IA	Grey	LD	Brown 8019	ZY	Titanium
IB	Metallic Grey	NN	Metallic Beige	ZZ	Clear

## Table of contents

INTEGRATO TECH	10.1
INTEGRATO TECH "Z"	10.7
INTEGRATO WITH ZINC ALLOY FOOT	10.9
INTEGRATO WITH ENGINEERING PLASTIC FOOT	10.15
INTEGRATO SPACERS	10.21
INTEGRATO Z	10.23
LH7.20 ADJUSTABLE LEVELLER	10.25
REKORD 12	10.27
DRILLING JIG FOR REKORD 12	10.33
LEVELLER Ø 14	10.35
ATACAMA	10.40
LH60.20 ADJUSTABLE LEVELLER	10.43
ATACAMA J	10.45
ATACAMA J WITH HEIGHT ADAPTER	10.50





INTEGRATO TECH



175 Kg per piece 

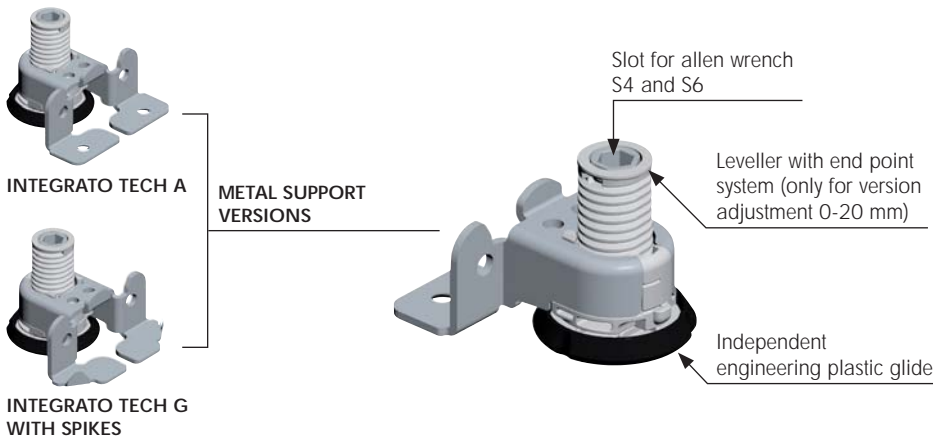

INSTALLATION

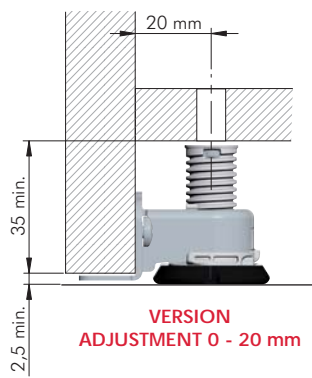
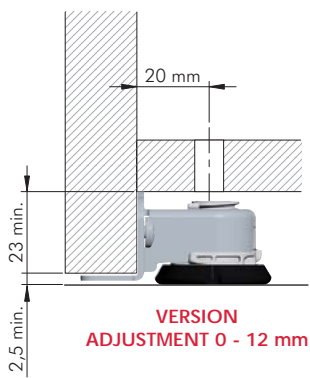
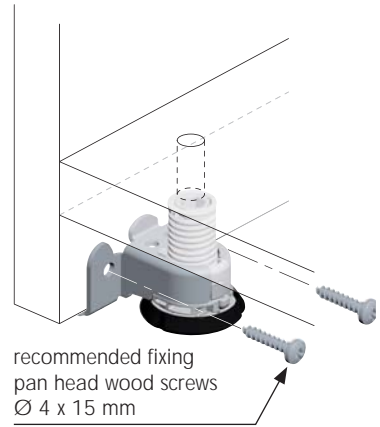

ADJUSTMENT

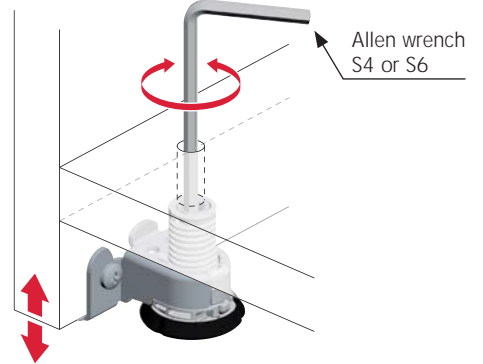

10

INTEGRATO TECH PRE-INSERTED SCREW FIXING



INSTALLATION

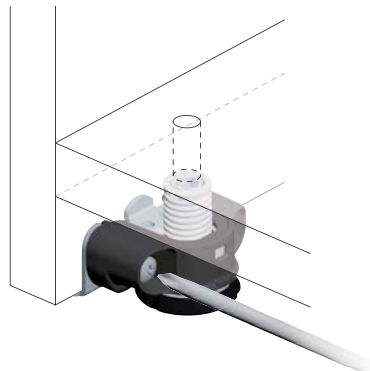

ACCESSORIES

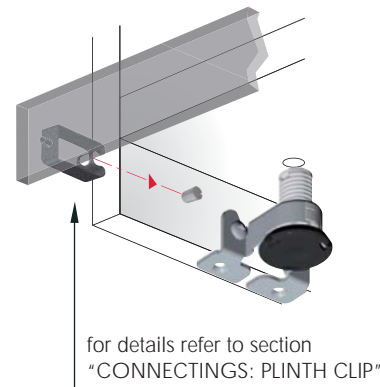

for details refer to section "CONNECTINGS: PLINTH CLIP"



## INTEGRATO TECH "A" ADJUSTMENT 12 mm

**ADJUSTMENT 0 - 12 mm**

= S4, S6

ST ZA EP = 200 pcs.

---

**3505001000**

## INTEGRATO TECH "A" ADJUSTMENT 12 mm WITH PRE-MOUNTED SCREWS

**ADJUSTMENT 0 - 12 mm**

= S4, S6

ST ZA EP = 200 pcs.

---

**3505002000**



**INTEGRATO TECH "A" ADJUSTMENT 20 mm**

**ADJUSTMENT 0 - 20 mm**

= S4, S6

ST ZA EP = 200 pcs.

|

**3505003000**

**INTEGRATO TECH "A" ADJUSTMENT 20 mm WITH PRE-MOUNTED SCREWS**

**ADJUSTMENT 0 - 20 mm**

= S4, S6

ST ZA EP = 200 pcs.

|

**3505004000**



## INTEGRATO TECH "G" ADJUSTMENT 12 mm

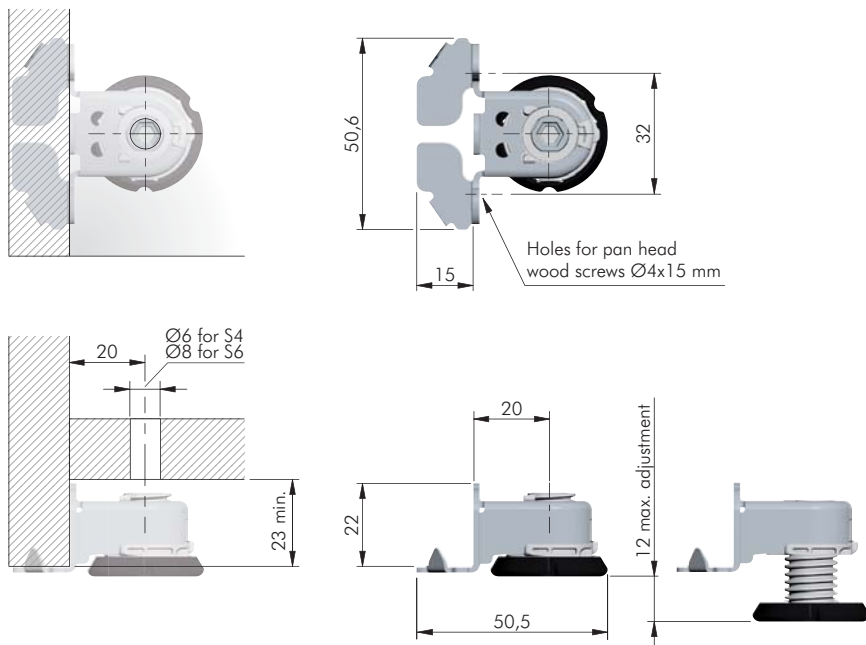

**ADJUSTMENT 0 - 12 mm**

= S4, S6

ST ZA EP = 200 pcs.

|

**3506001000**



## INTEGRATO TECH "G" ADJUSTMENT 12 mm WITH PRE-MOUNTED SCREWS

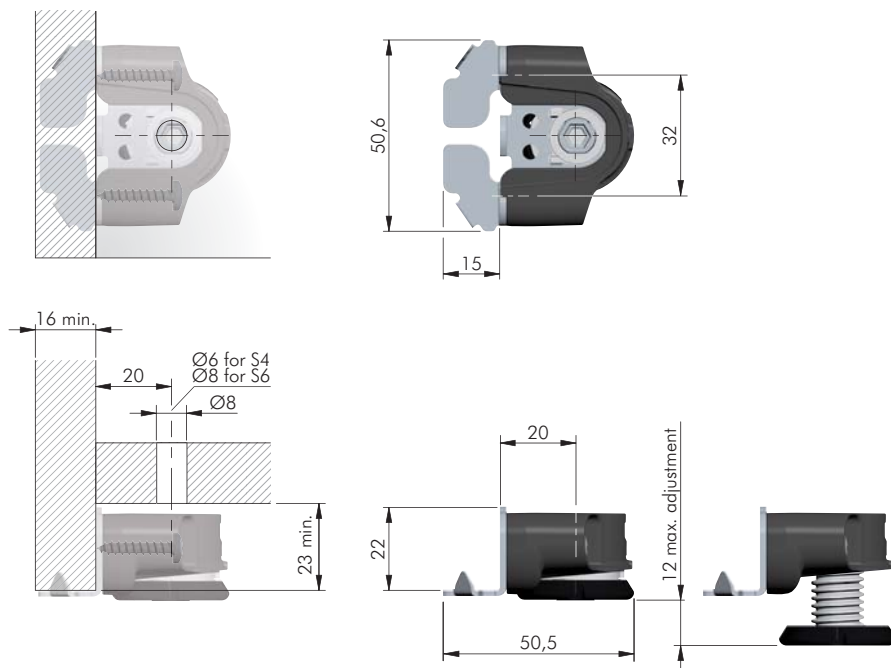

**ADJUSTMENT 0 - 12 mm**

= S4, S6

ST ZA EP = 200 pcs.

|

**3506002000**





**INTEGRATO TECH "G" ADJUSTMENT 20 mm**

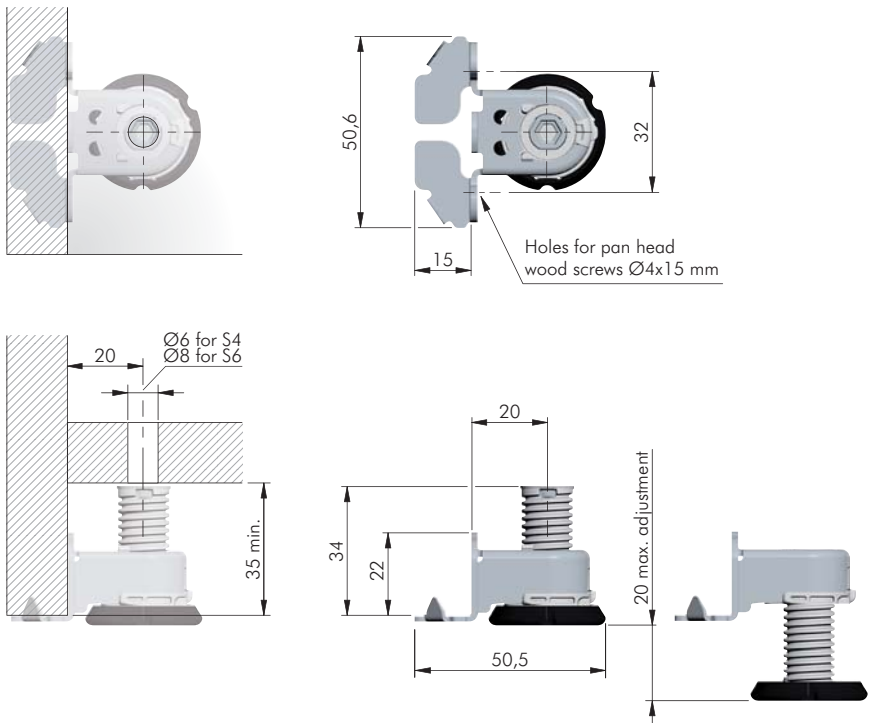

ADJUSTMENT 0 - 20 mm

= S4, S6  
 = 200 pcs.

**3506003000**



**INTEGRATO TECH "G" ADJUSTMENT 20 mm WITH PRE-MOUNTED SCREWS**

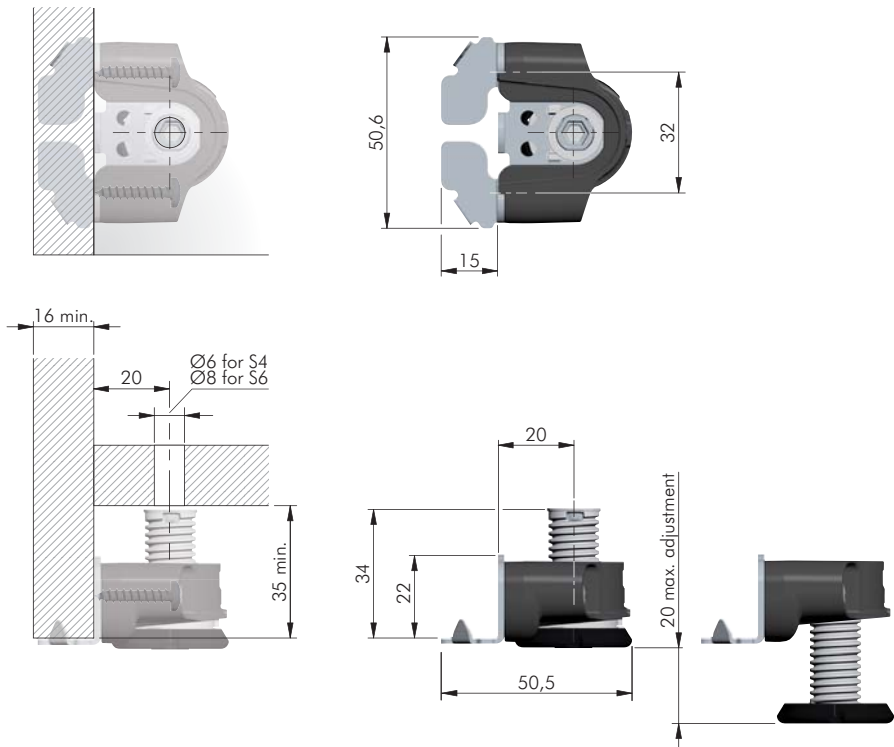

ADJUSTMENT 0 - 20 mm

= S4, S6  
 = 200 pcs.

**3506004000**





## INTEGRATO TECH FIXING ACCESSORY

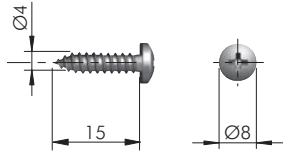

= Ø 3 mm	+
= PZ2	
ST	= 1000 pcs.
<b>60103230ZN</b>	

## INTEGRATO TECH ACCESSORIES

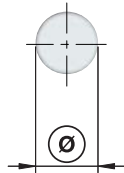
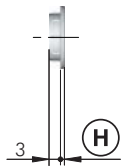
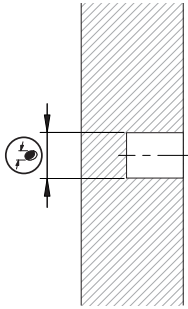

= Ø 8 mm	+			
EP				
<b>23002010AB</b>	Ø 8	Ø 11	1	5000

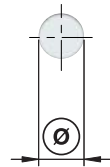
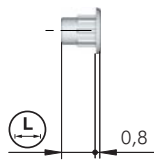
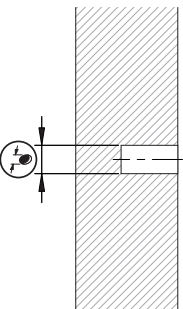

= Ø 6 mm	+			
EP				
<b>23001060AB</b>	Ø 6	Ø 9,4	7	5000



# INTEGRATO TECH "Z"



175 Kg per piece

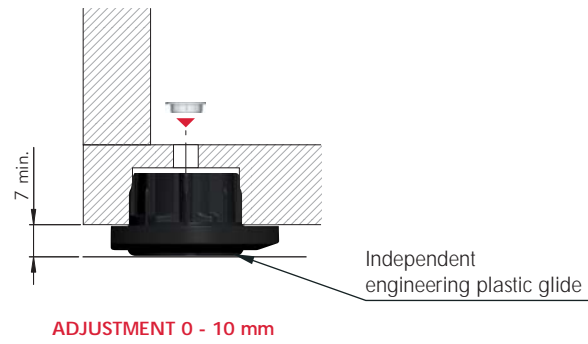

## INSTALLATION

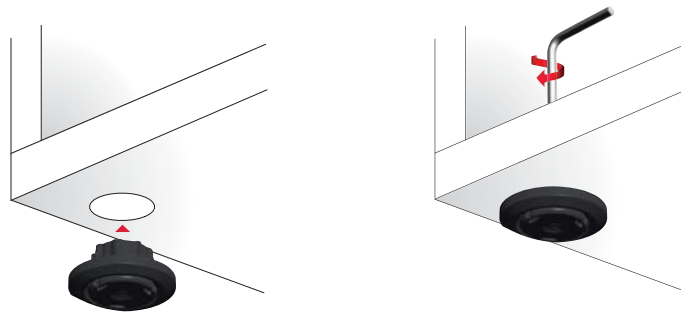

## ADJUSTMENT







# LEVELLERS

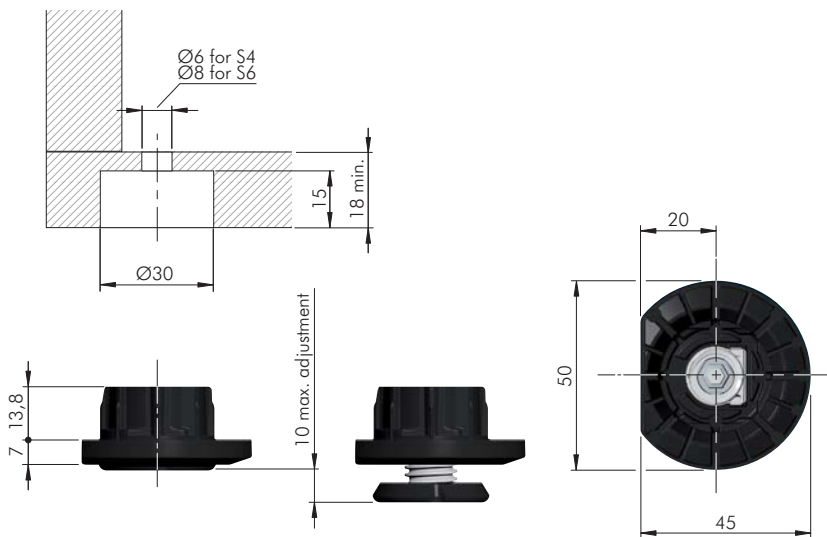

= S4, S6  
 = 250 pcs.  
  
**35070010EA**



## INTEGRATO TECH "Z" ACCESSORIES

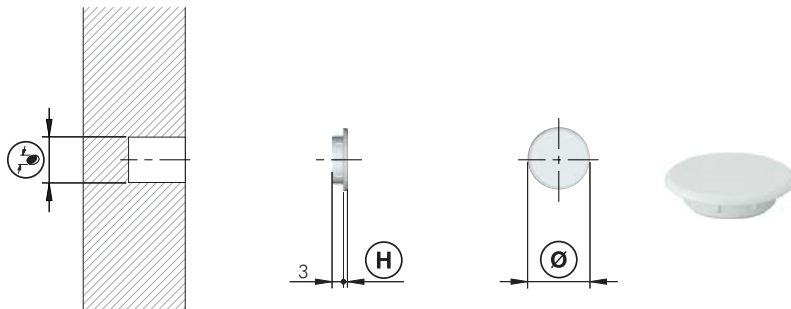

= Ø 8 mm   
  
  
**23002010AB**    Ø 8    Ø 11    1    5000

10

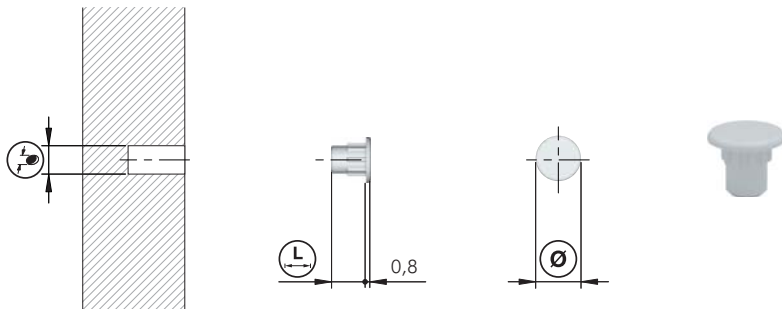

= Ø 6 mm   
  
  
**23001060AB**    Ø 6    Ø 9,4    7    5000



INTEGRATO WITH ZINC ALLOY FOOT



175 Kg per piece

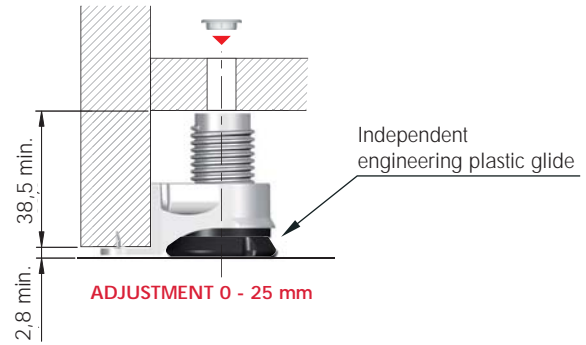
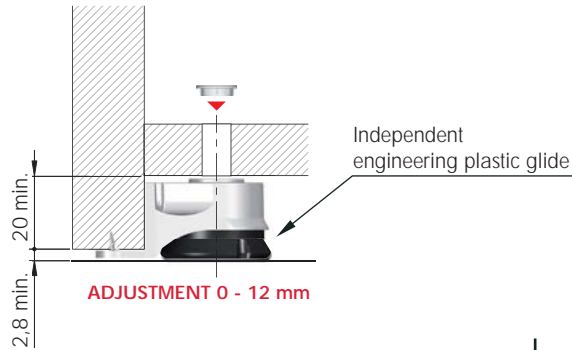

INSTALLATION

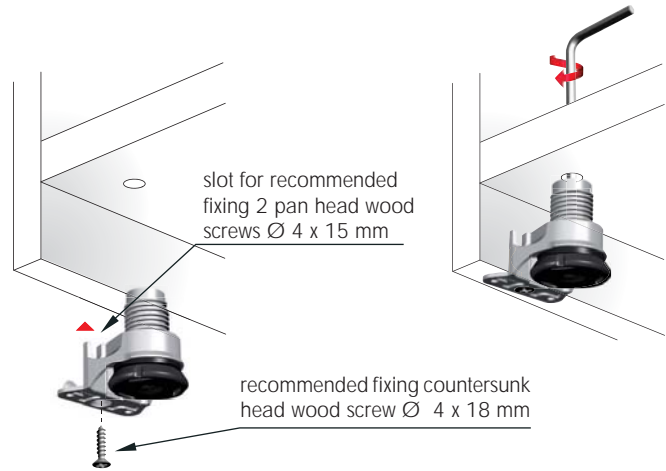
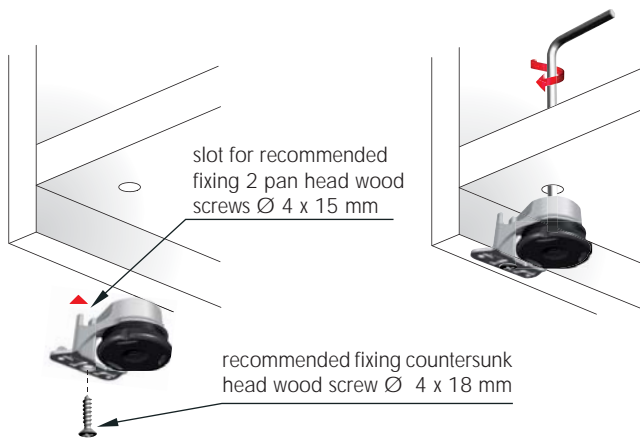

ADJUSTMENT

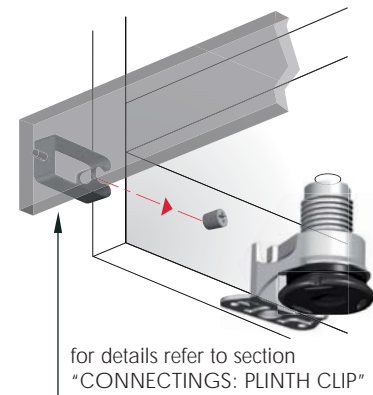
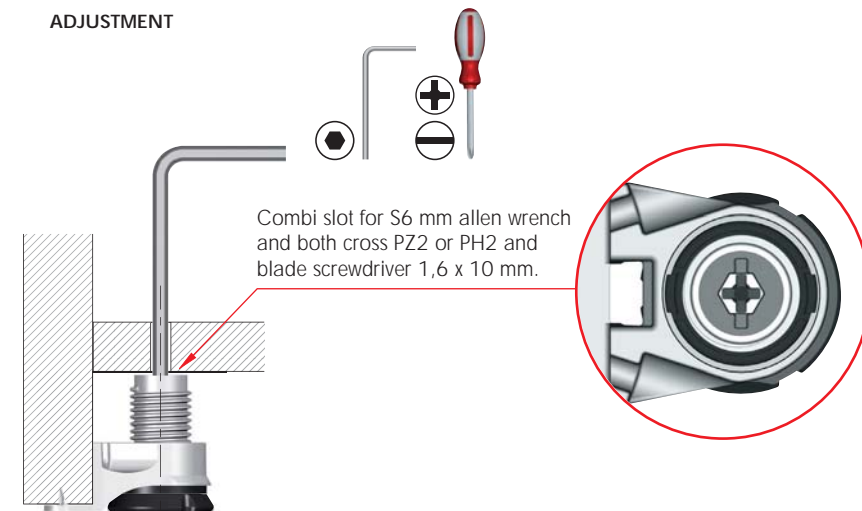

## INTEGRATO A

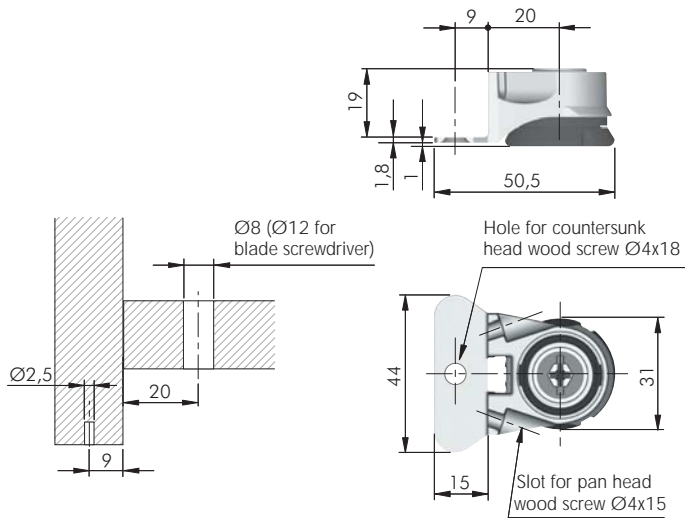

### ADJUSTMENT 0 - 12 mm

ZA	EP	= 300 pcs.		
<b>3010101000</b>		S6 mm	PZ2 - PH2	1,6x10 mm
<b>3010104000</b>		S4/S6 mm	-	-

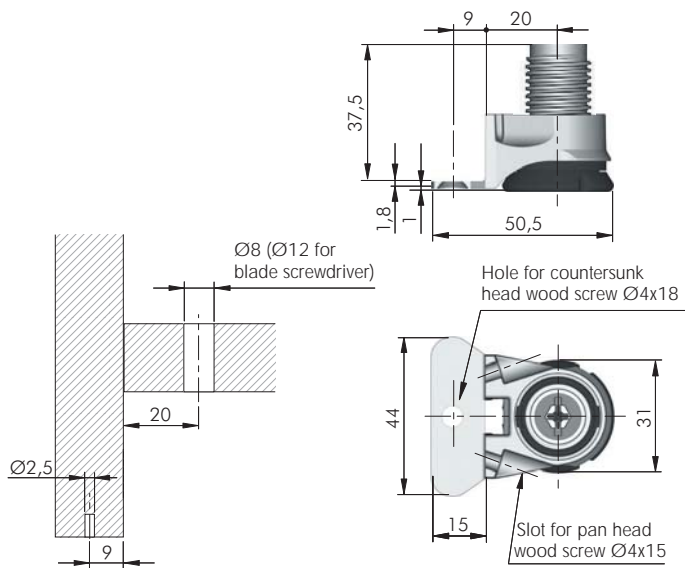

### ADJUSTMENT 0 - 25 mm

ZA	EP	= 250 pcs.		
<b>3010102000</b>		S6 mm	PZ2 - PH2	1,6x10 mm
<b>3010105000</b>		S4/S6 mm	-	-



## INTEGRATO B

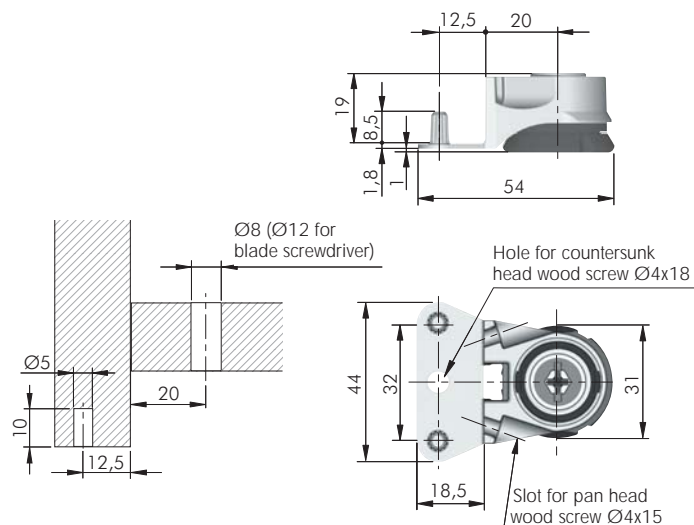

### ADJUSTMENT 0 - 12 mm

	= S6		= PZ2 PH2		= 1,6x10 mm
ZA	EP	= 250 pcs.			
		<b>3010201000</b>			



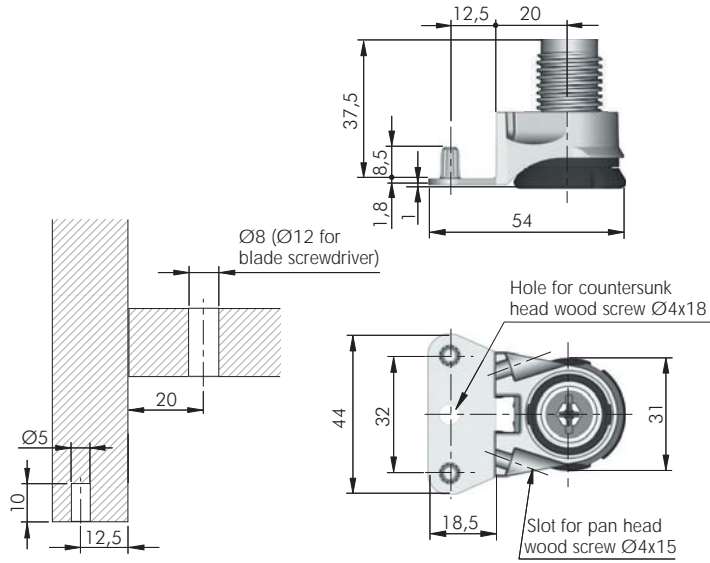

ADJUSTMENT 0 - 25 mm

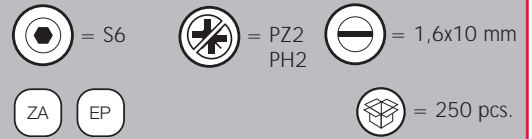

3010202000



## INTEGRATO C

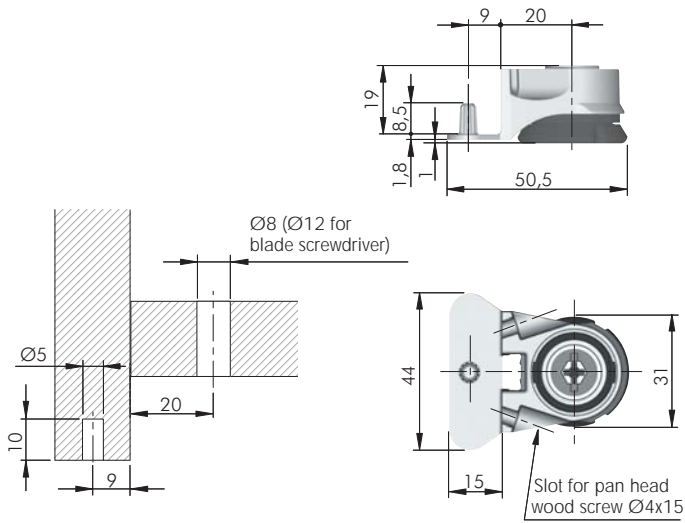

ADJUSTMENT 0 - 12 mm

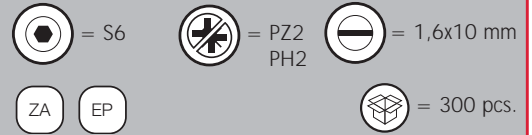

3010301000

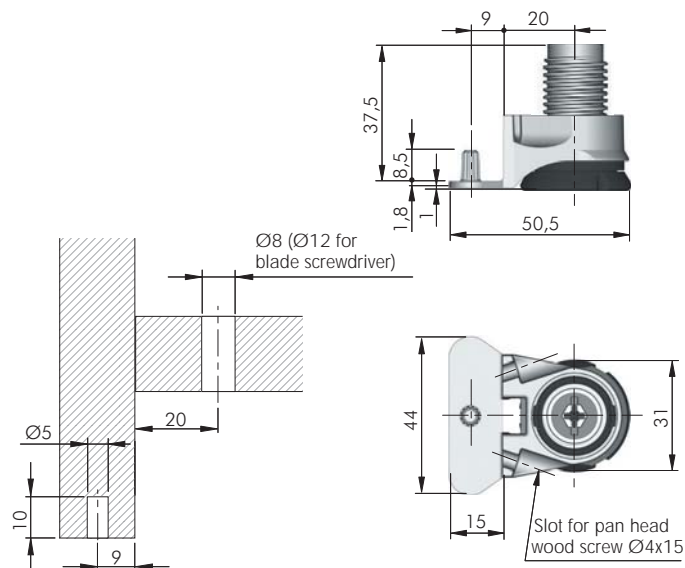

ADJUSTMENT 0 - 25 mm

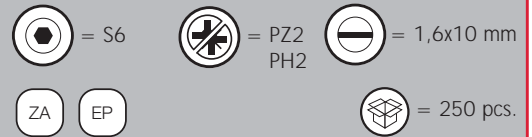

3010302000





## INTEGRATO D

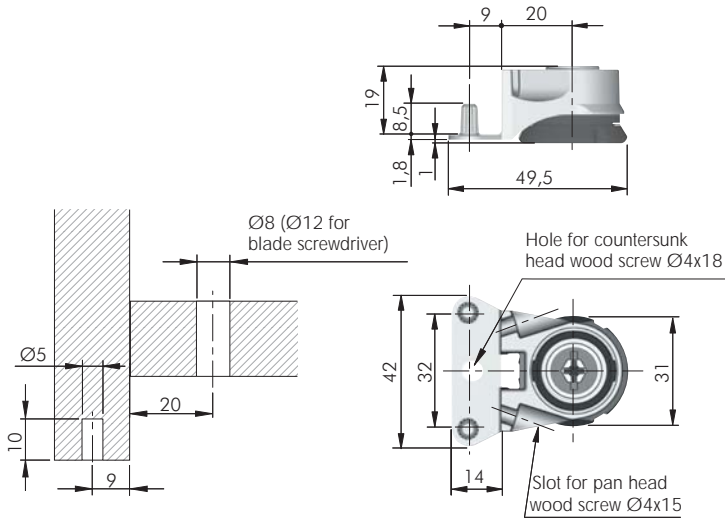

### ADJUSTMENT 0 - 12 mm

ZA EP

= 300 pcs.

<b>3010401000</b>		S6 mm	PZ2 - PH2	1,6x10 mm
<b>3010405000</b>		S4/S6 mm	-	-

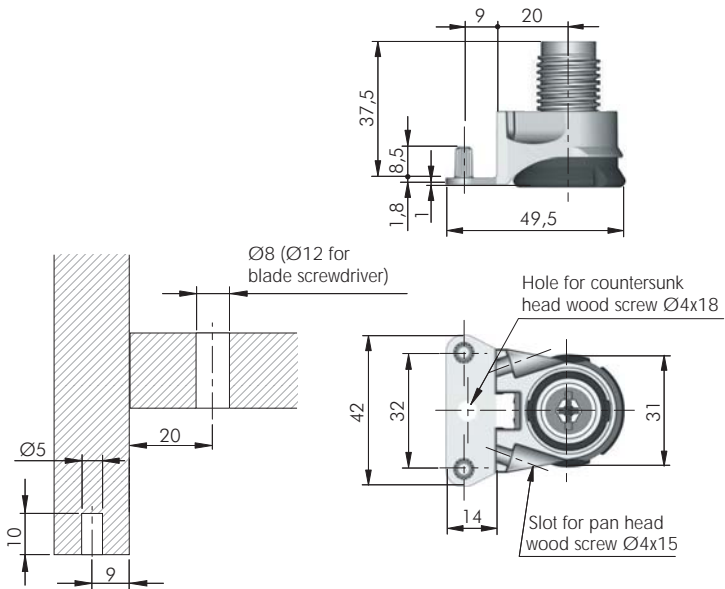

### ADJUSTMENT 0 - 25 mm

ZA EP

= 250 pcs.

<b>3010402000</b>		S6 mm	PZ2 - PH2	1,6x10 mm
<b>3010404000</b>		S4/S6 mm	-	-



## INTEGRATO E

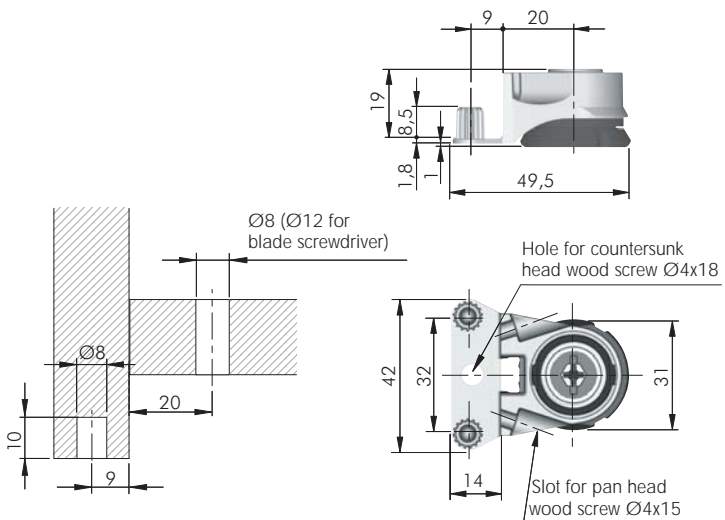

### ADJUSTMENT 0 - 12 mm

= S6    = PZ2 PH2    = 1,6x10 mm

ZA EP

= 300 pcs.

<b>3010501000</b>	

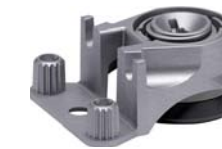

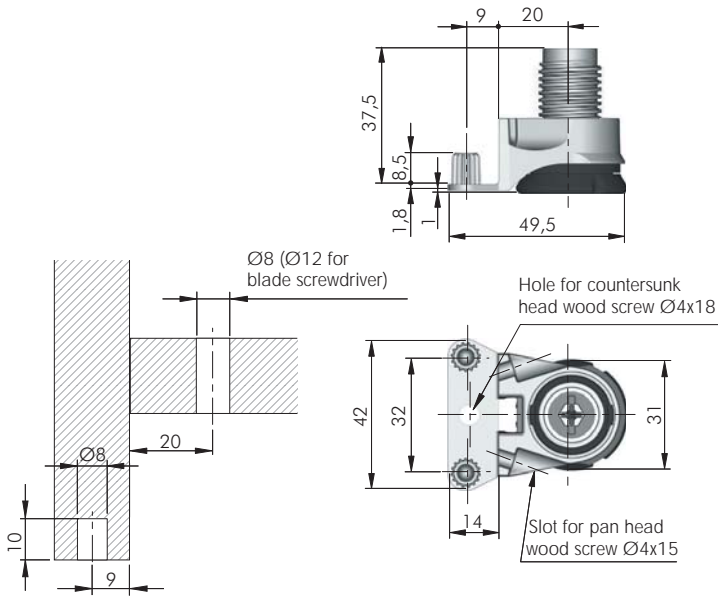

### ADJUSTMENT 0 - 25 mm

	= S6		= PZ2 PH2		= 1,6x10 mm
	ZA		EP		= 250 pcs.



3010502000

## INTEGRATO G

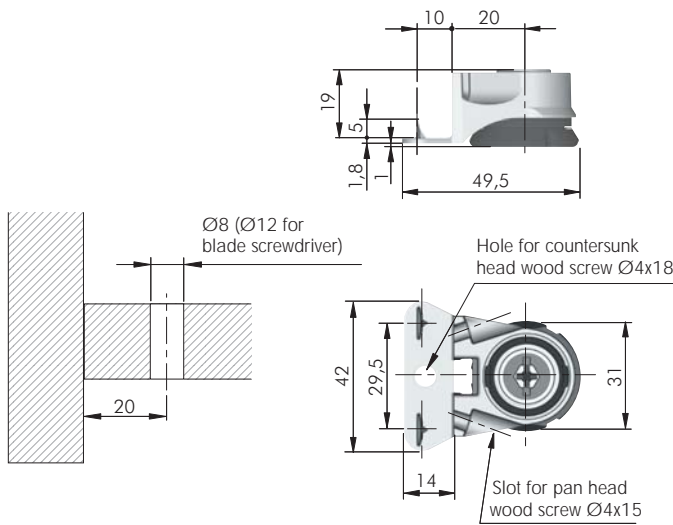

### ADJUSTMENT 0 - 12 mm

	ZA		EP		= 300 pcs.
--	----	--	----	--	------------



3010601000



S6 mm



PZ2 - PH2



1,6x10 mm

3010603000

S4/S6 mm

-

-

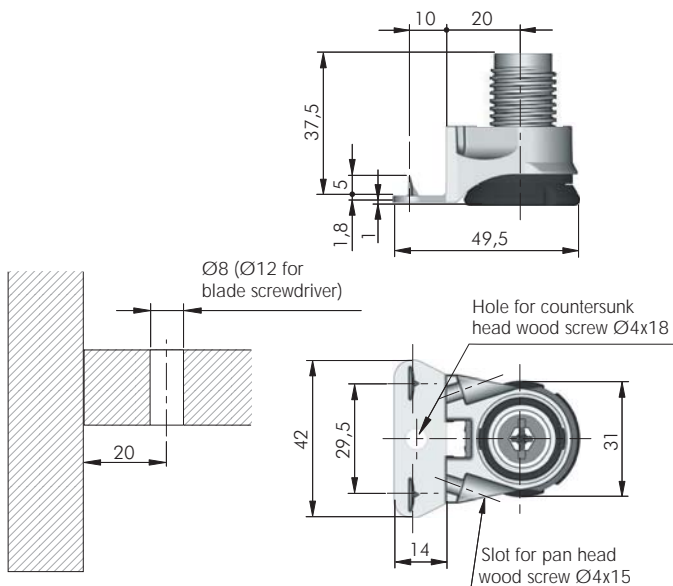

### ADJUSTMENT 0 - 25 mm

	ZA		EP		= 250 pcs.
--	----	--	----	--	------------



3010602000



S6



PZ2 - PH2



1,6x10 mm

3010604000

S4/S6 mm

-

-



## INTEGRATO ACCESSORY

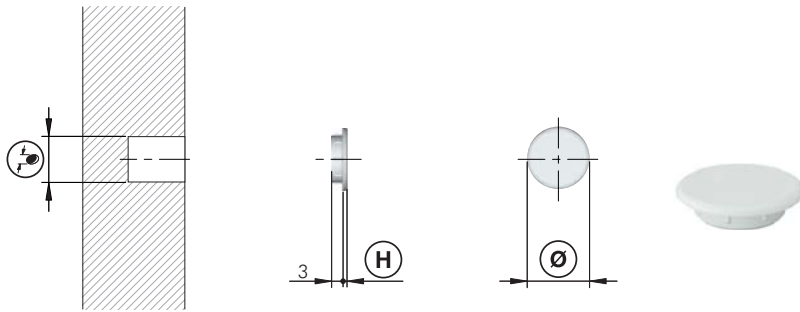

= Ø 8, Ø 12 mm					+
EP					
23002010AB	Ø 8	Ø 11	1	5000	
23002030AB	Ø 12	Ø 15	1	5000	

## INTEGRATO FIXING ACCESSORIES



= Ø 3 mm					+
ST					= 1000 pcs.
60101580ZN					

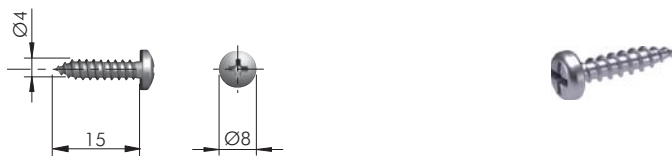

= Ø 3 mm					+
ST					= 1000 pcs.
60103230ZN					





**INTEGRATO WITH ENGINEERING PLASTIC FOOT**



175 Kg per piece

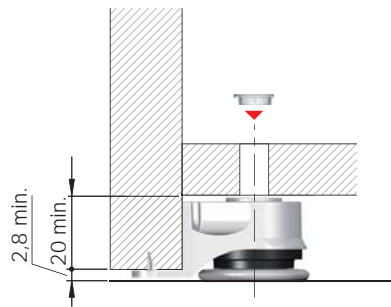

ADJUSTMENT 0 - 12 mm

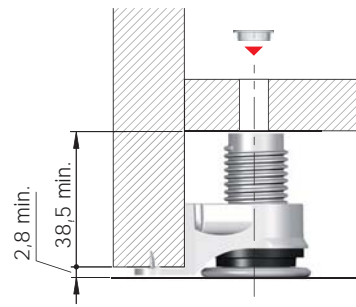

ADJUSTMENT 0 - 25 mm

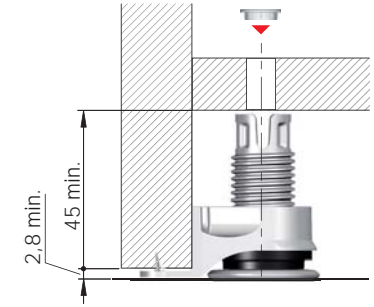

**INSTALLATION**

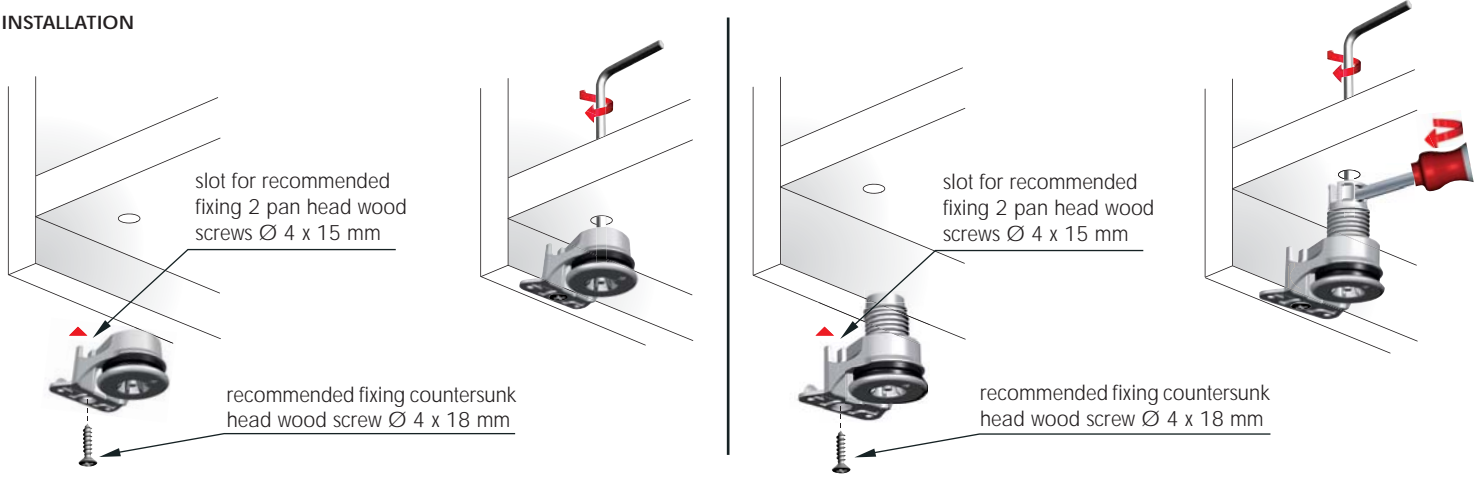

**ADJUSTMENT**

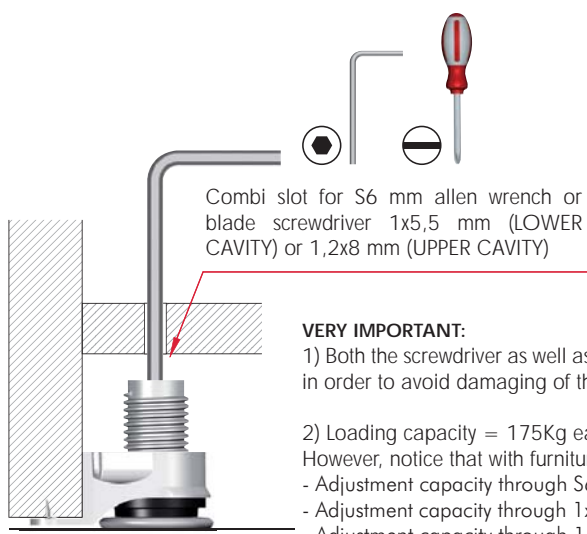

**VERY IMPORTANT:**

1) Both the screwdriver as well as the allen wrench must be fully inserted in the cavities, in order to avoid damaging of the engineering plastic sockets.

2) Loading capacity = 175Kg each.

However, notice that with furniture already loaded:

- Adjustment capacity through S6 mm allen wrench ≤ 175Kg.
- Adjustment capacity through 1x5,5 mm blade screwdriver (LOWER CAVITY) ≤ 63Kg.
- Adjustment capacity through 1,2x8 mm blade screwdriver (UPPER CAVITY) ≤ 63Kg.

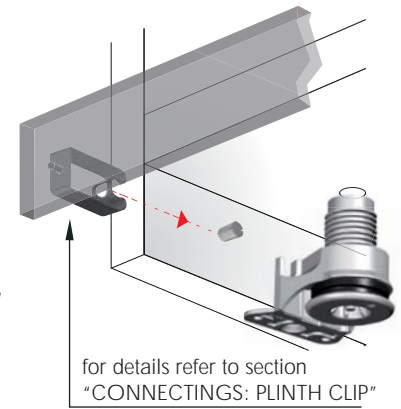

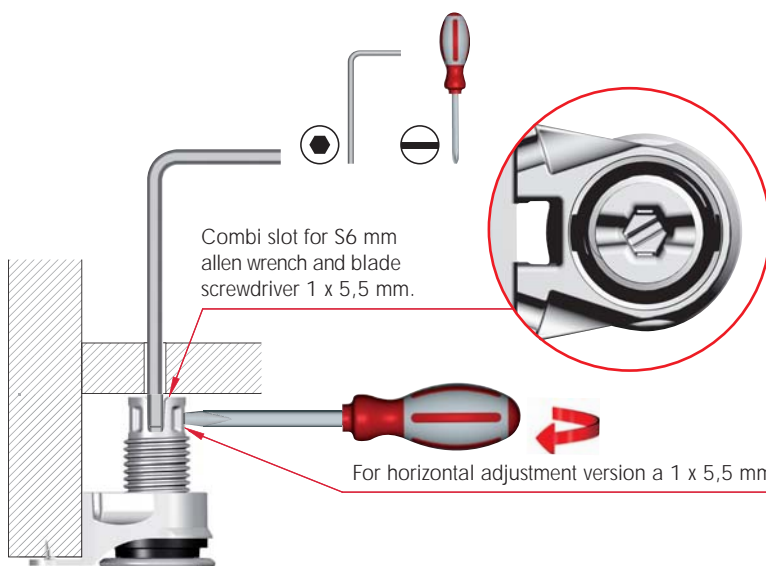

**VERY IMPORTANT:**

1) Both the screwdriver as well as the allen wrench must be fully inserted in the cavities, in order to avoid damaging of the engineering plastic sockets.

2) Loading capacity = 175 Kg each.

However, notice that with furniture already loaded:

- Horizontal adjustment capacity through 1x5,5 mm blade screwdriver ≤ 175 Kg.
- Vertical adjustment capacity through S6 mm allen wrench ≤ 175 Kg.
- Vertical adjustment capacity through 1x5,5 mm blade screwdriver ≤ 63 Kg.

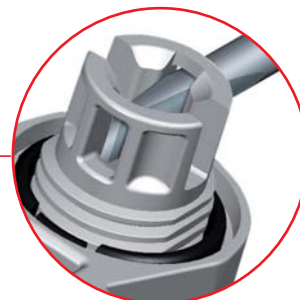

## INTEGRATO A

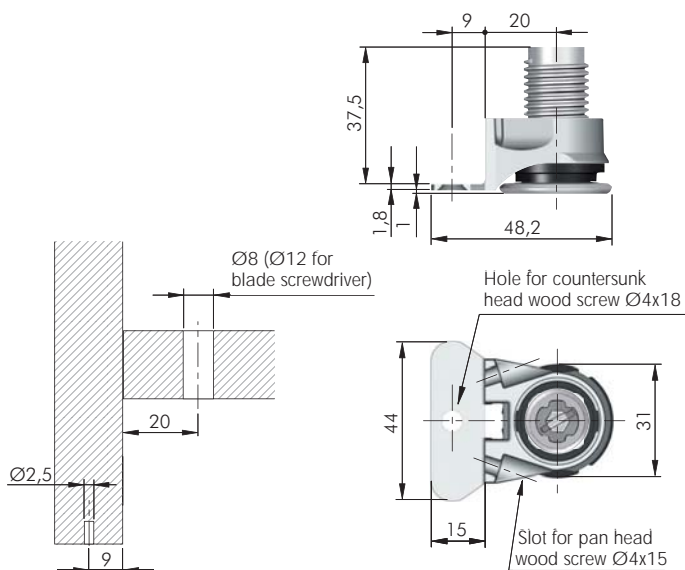

**ADJUSTMENT 0 - 25 mm**

⊙ = S6      ⊖ = 1x5,5 mm (LOWER CAVITY)  
 1,2x8 mm (UPPER CAVITY)

ZA    EP

⊞ = 250 pcs.



3011103000



## INTEGRATO B

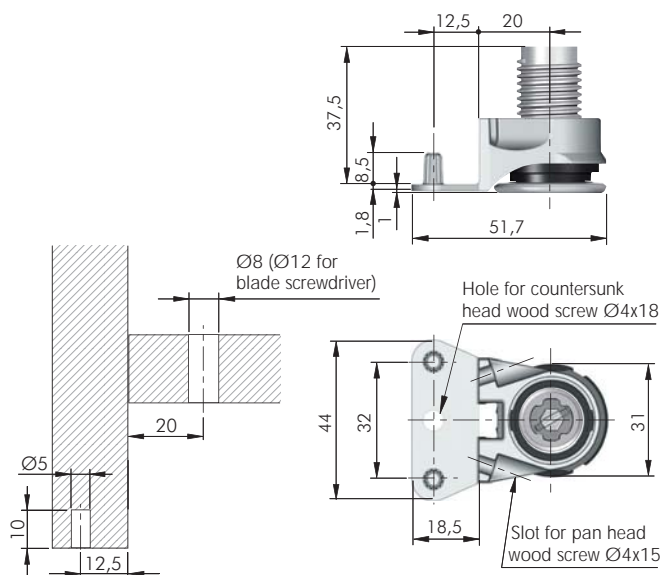

**ADJUSTMENT 0 - 25 mm**

⊙ = S6      ⊖ = 1x5,5 mm (LOWER CAVITY)  
 1,2x8 mm (UPPER CAVITY)

ZA    EP

⊞ = 250 pcs.



3011203000





### INTEGRATO C

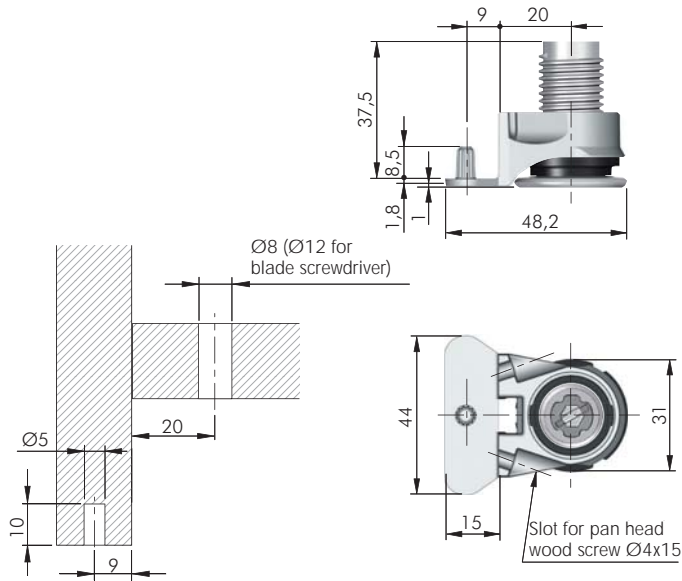

**ADJUSTMENT 0 - 25 mm**

= S6    
 = 1x5,5 mm (LOWER CAVITY)  
 = 1,2x8 mm (UPPER CAVITY)

  
                     
 = 250 pcs.

**3011303000**

### INTEGRATO D

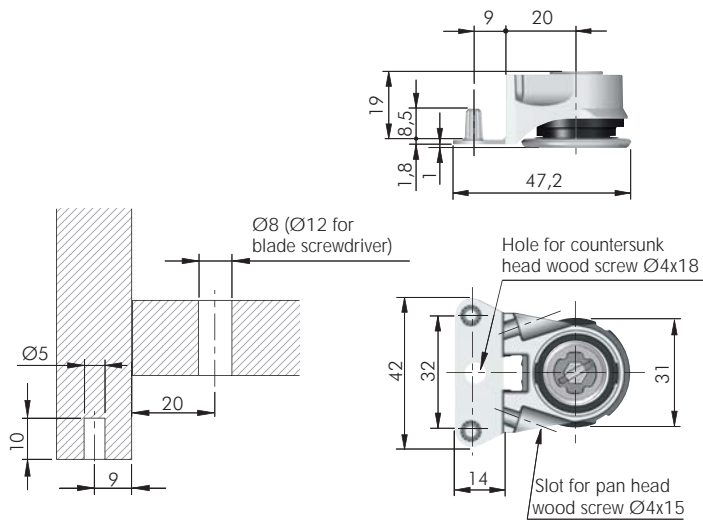

**ADJUSTMENT 0 - 12 mm**

= S6    
 = 1x5,5 mm (LOWER CAVITY)  
 = 1,2x8 mm (UPPER CAVITY)

  
                     
 = 300 pcs.

**3011401000**

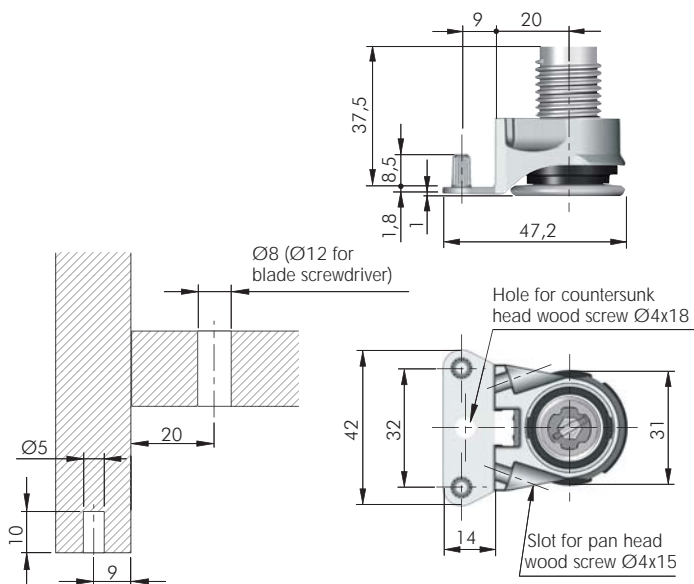

**ADJUSTMENT 0 - 25 mm**

= S6    
 = 1x5,5 mm (LOWER CAVITY)  
 = 1,2x8 mm (UPPER CAVITY)

  
                     
 = 250 pcs.

**3011403000**





INTEGRATO G

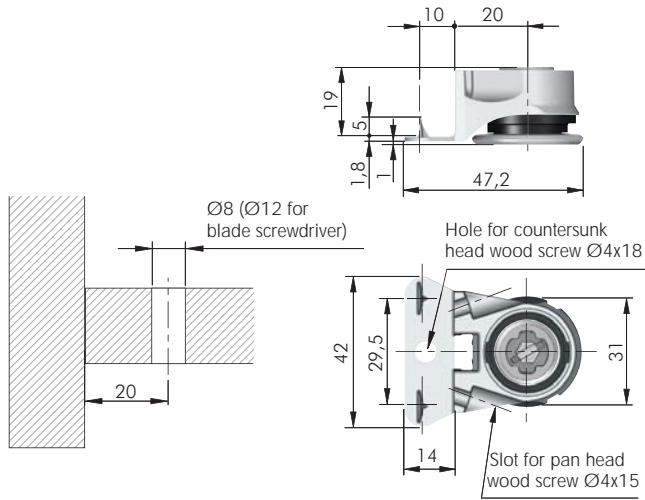

ADJUSTMENT 0 - 12 mm

- = S6      = 1x5,5 mm (LOWER CAVITY)  
1,2x8 mm (UPPER CAVITY)
- 
- = 300 pcs.



3011601000

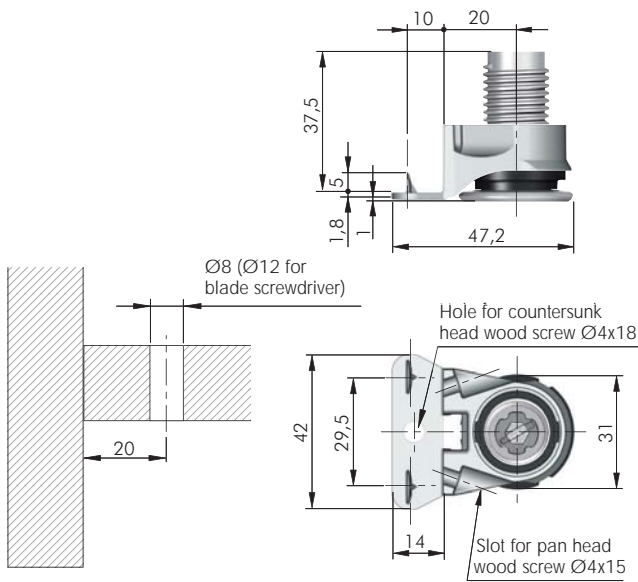

ADJUSTMENT 0 - 25 mm

- = S6      = 1x5,5 mm (LOWER CAVITY)  
1,2x8 mm (UPPER CAVITY)
- 
- = 250 pcs.



3011603000

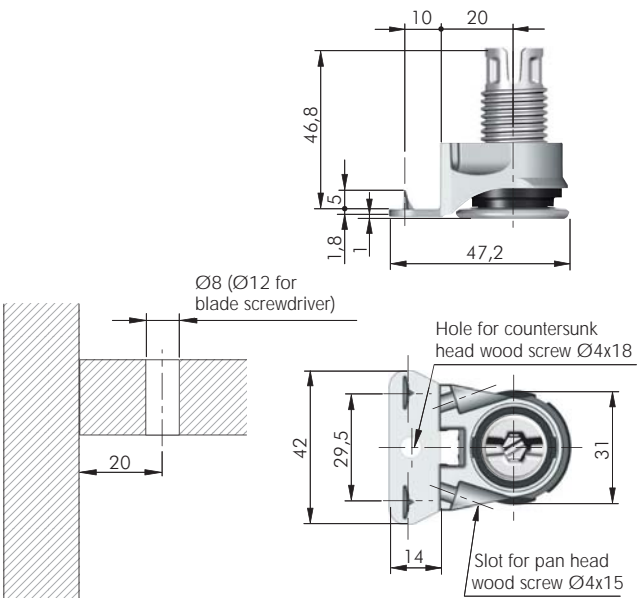

ADJUSTMENT 0 - 25 mm

- = S6      = 1x5,5 mm
- 
- = 250 pcs.



3011602000



## INTEGRATO ACCESSORY

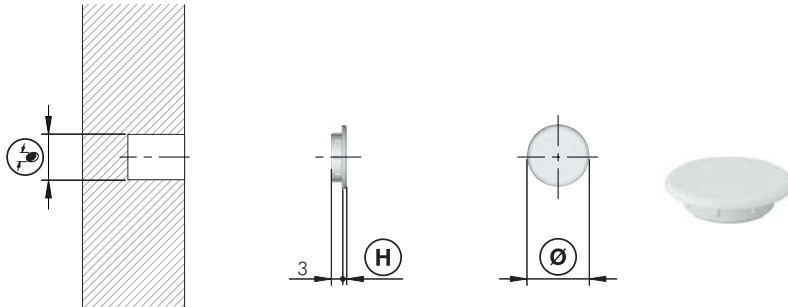

= Ø 8, Ø 12 mm +

EP

23002010AB		Ø 8	Ø 11	1	5000
23002030AB		Ø 12	Ø 15	1	5000

## INTEGRATO FIXING ACCESSORIES

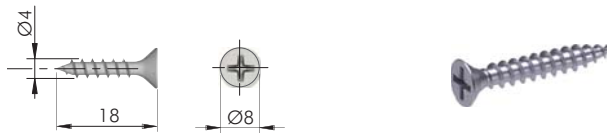

= Ø 3 mm +

= PZ2

ST  = 1000 pcs.

**60101580ZN**

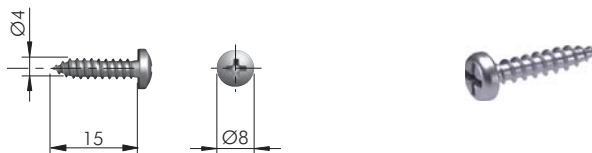

= Ø 3 mm +

= PZ2

ST  = 1000 pcs.

**60103230ZN**





## INTEGRATO SPACERS



### INSTALLATION & ADJUSTMENT

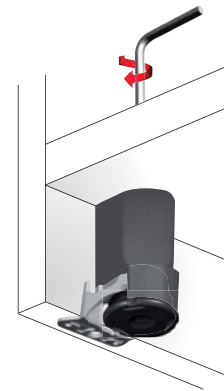
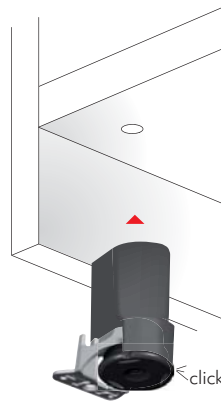
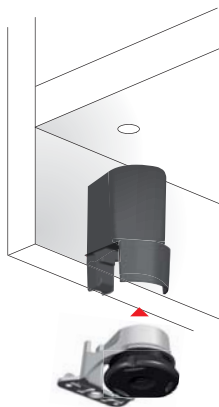

Whenever it is deemed necessary, over the leveller INTEGRATO, can be clicked a SPACER to give structural support to the furniture bottom.

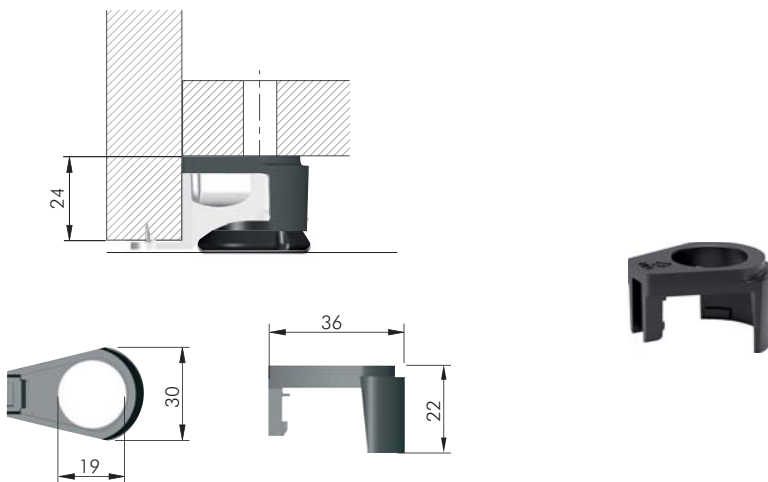





# LEVELLERS

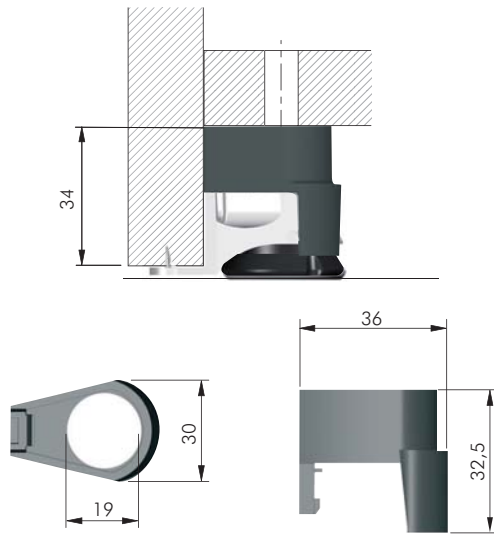

EP	= 1000 pcs.
123	
<b>30107040EA</b>	

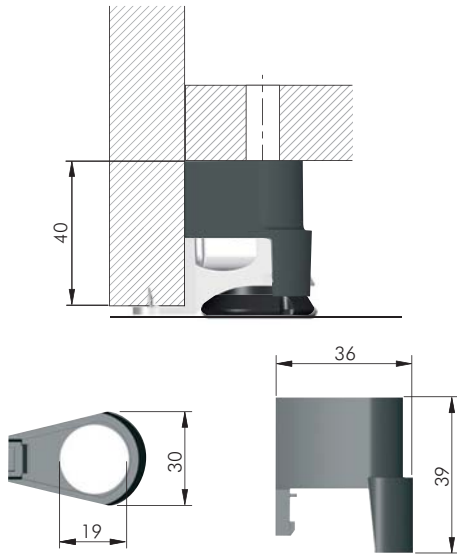

EP	= 900 pcs.
123	
<b>30107020EA</b>	

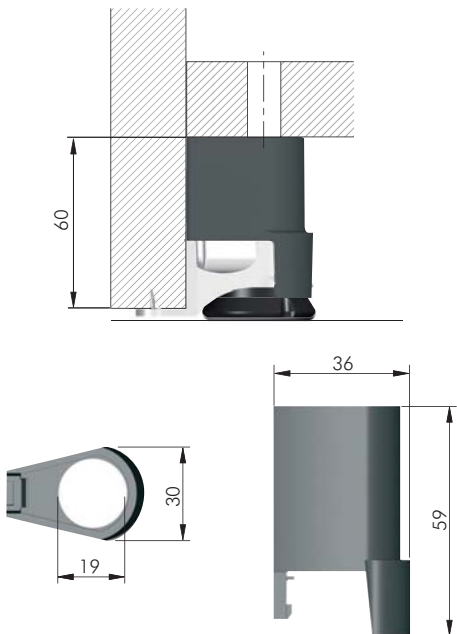

EP	= 500 pcs.
123	
<b>30107030EA</b>	

10



# INTEGRATO Z



175 Kg per piece 

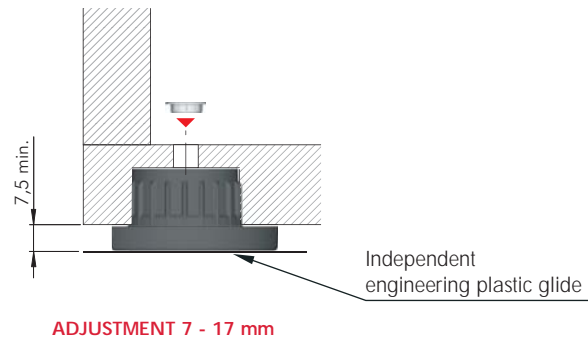

## INSTALLATION

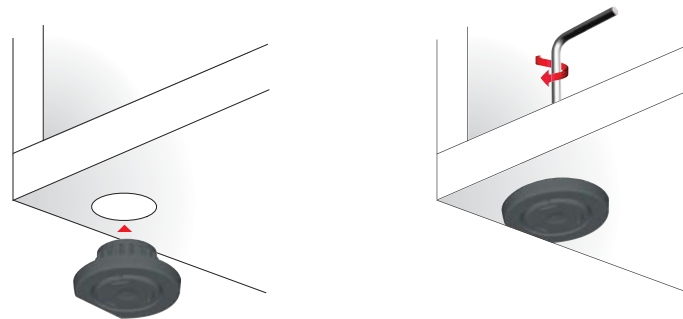

## ADJUSTMENT

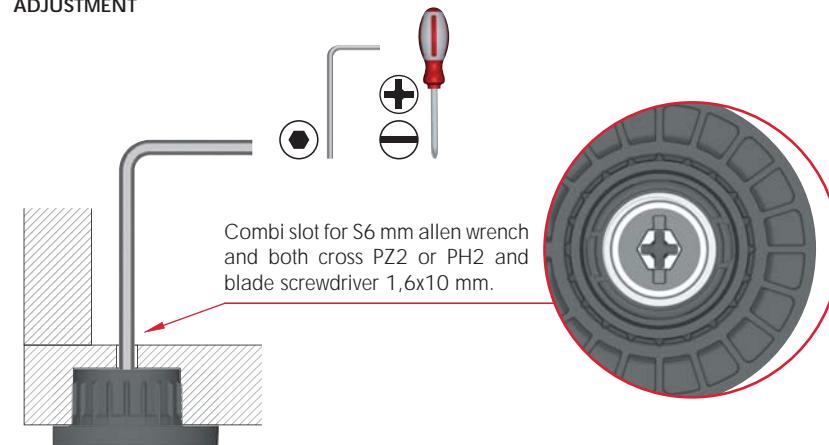



# LEVELLERS

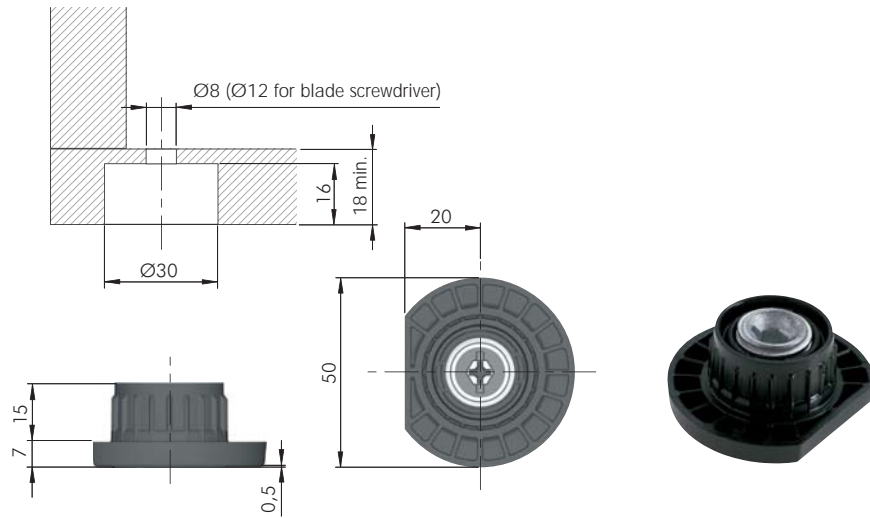

	= S6		= PZ2 PH2		= 1,6x10 mm
	ZA		EP		= 250 pcs.
	30108010EA				

## INTEGRATO Z ACCESSORY

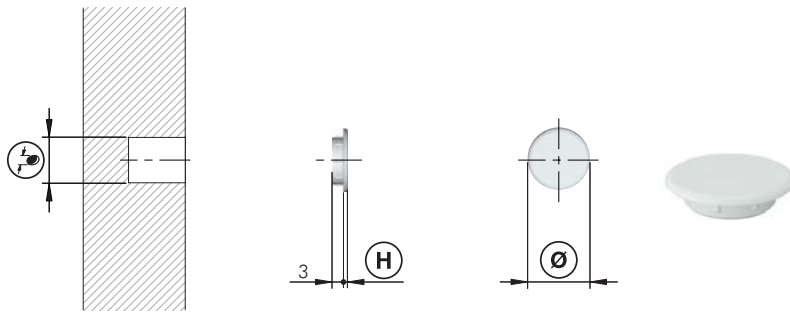

	= Ø 8, Ø 12 mm				
	EP				
23002010AB	Ø 8	Ø 11	1	5000	
23002030AB	Ø 12	Ø 15	1	5000	



LH7.20 ADJUSTABLE LEVELLER



150 Kg per piece 

APPLICATIONS

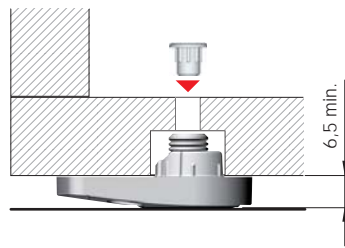
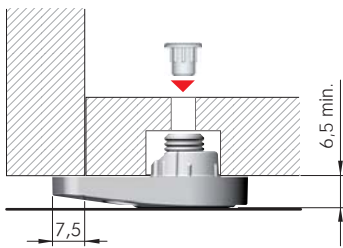

INSTALLATION

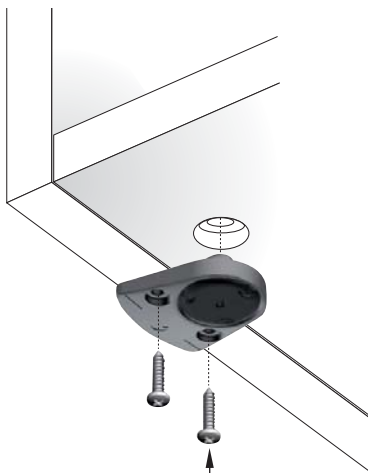

Recommended 2 pan head wood screws Ø 3,5 x 16 mm

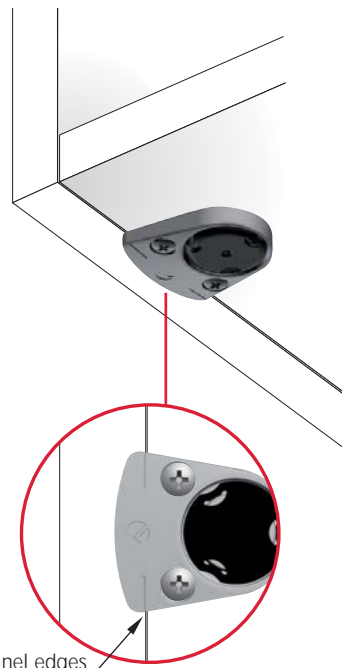

Marks for alignment with panel edges

ADJUSTMENT

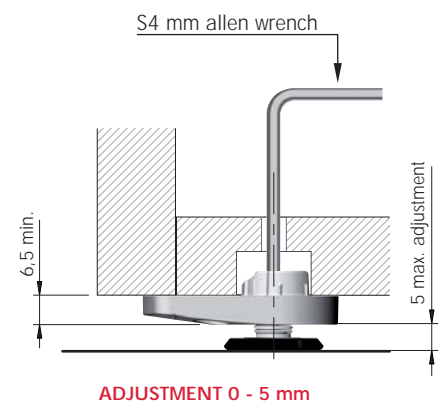



# LEVELLERS

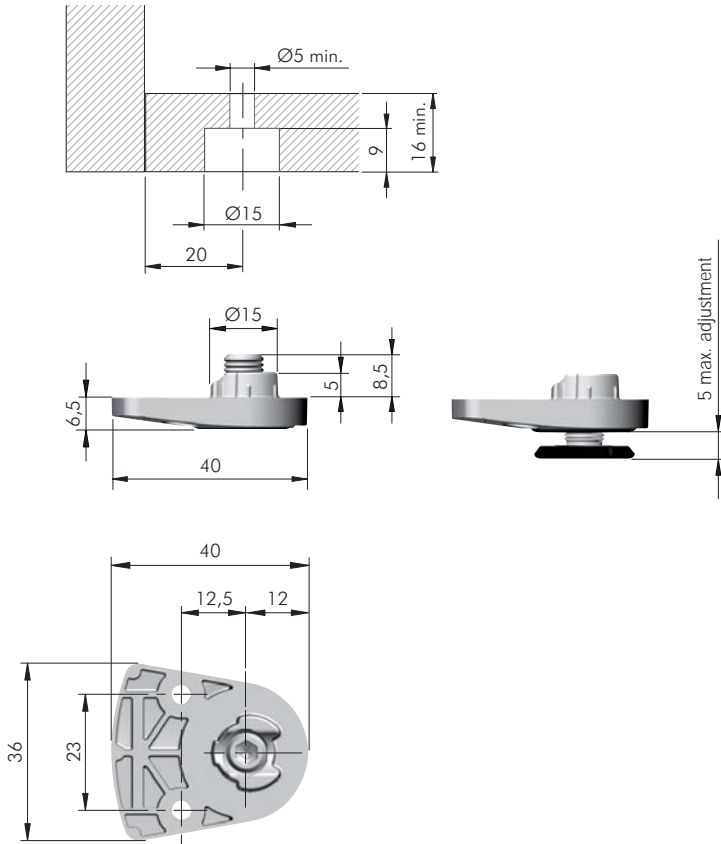

## ADJUSTMENT 0 - 5 mm

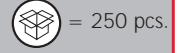

21836200ZN



## LH7.20 LEVELLER ACCESSORIES

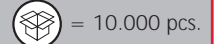
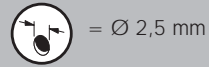
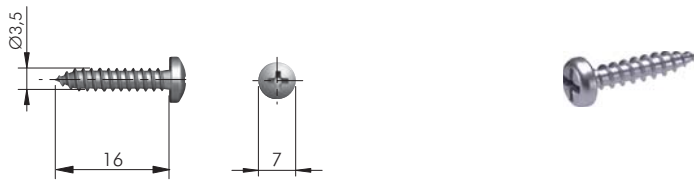

60103140ZN

10

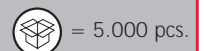
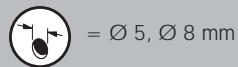
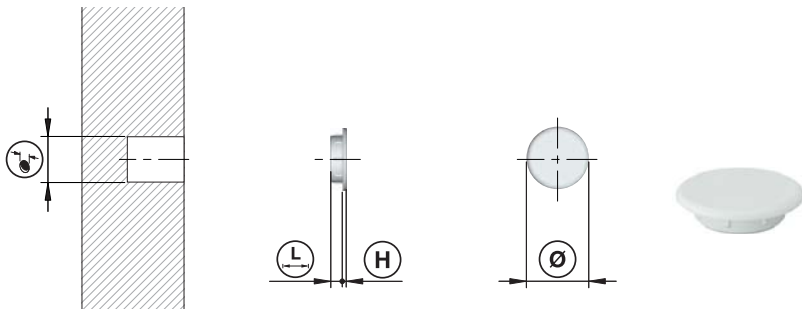

23001040AB



Ø 5



Ø 8



0,8



6

23002010AB

Ø 8

Ø 11

1

3



# REKORD 12



150 Kg per piece

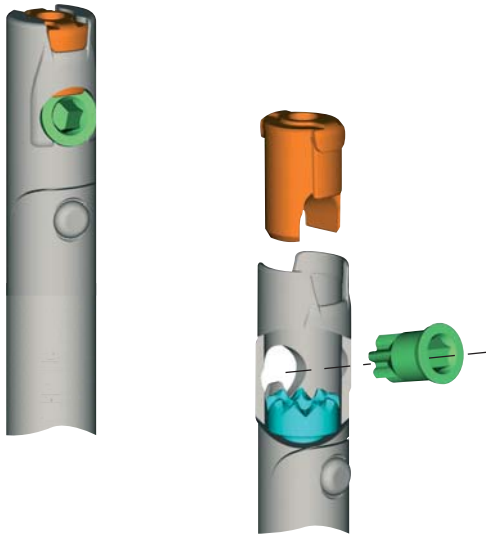

## INSTALLATION

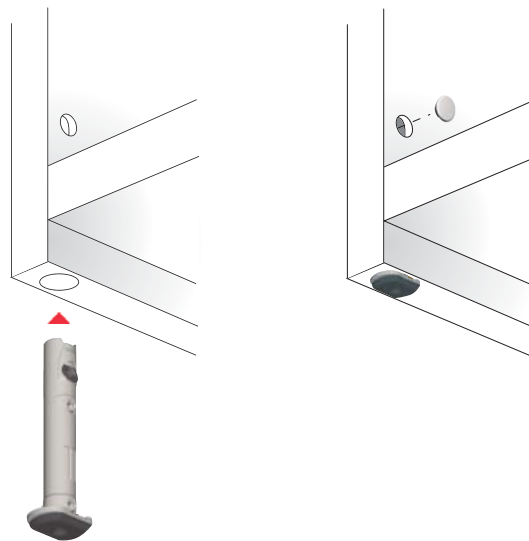

## ADJUSTMENT

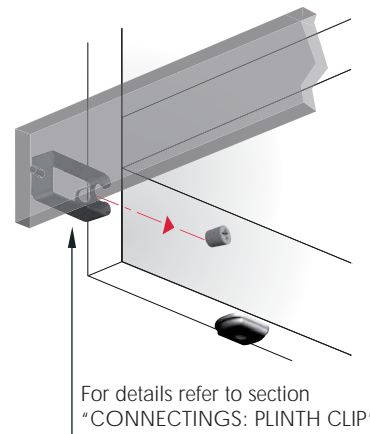
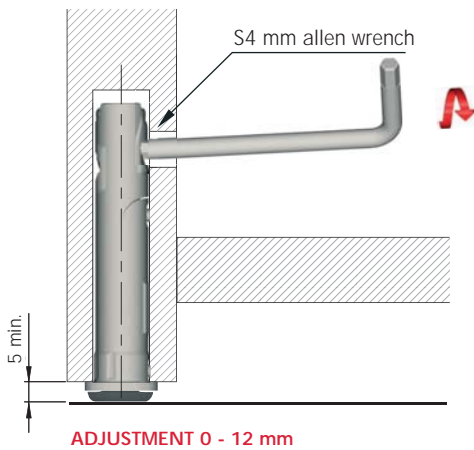



## REKORD 12 H 52 mm

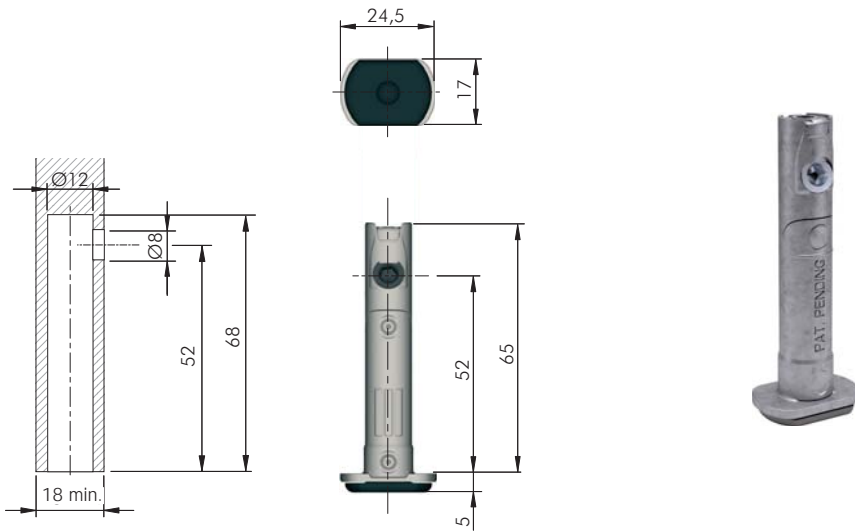

	= S4		= 200 pcs.
<b>3030101000</b>			

## DRILL BIT FOR REKORD 12 H 52 mm

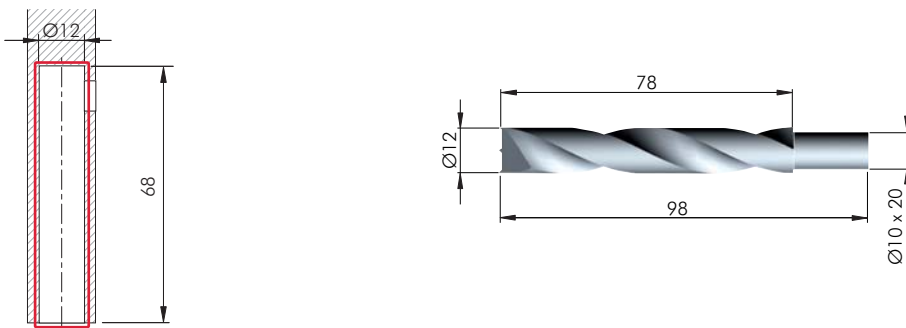

		= on request
<b>3030158000</b>		

10

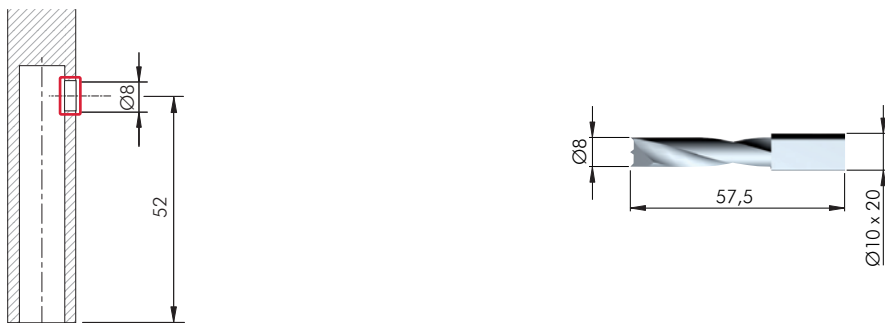

		= on request
<b>1145202000</b>		





REKORD 12 H 70 mm

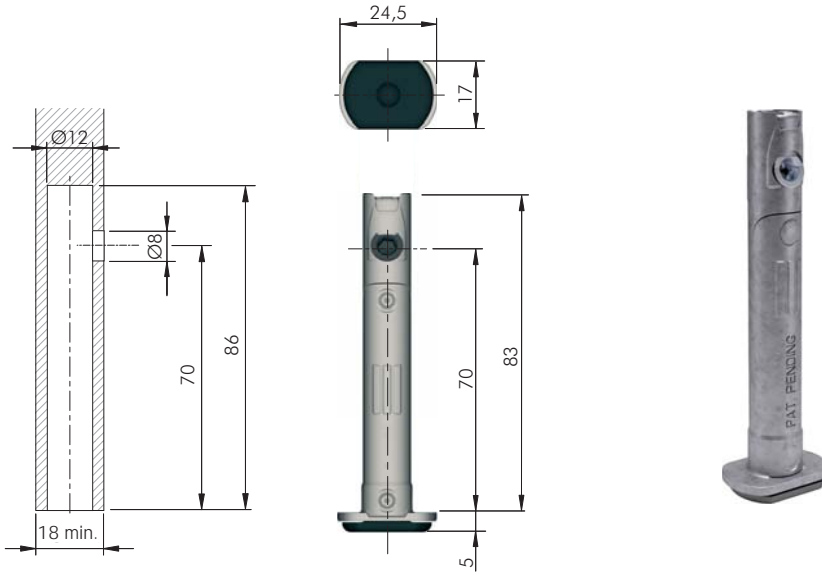

	= S4		= 150 pcs.
<b>3030102000</b>			

DRILL BIT FOR REKORD 12 H 70 mm

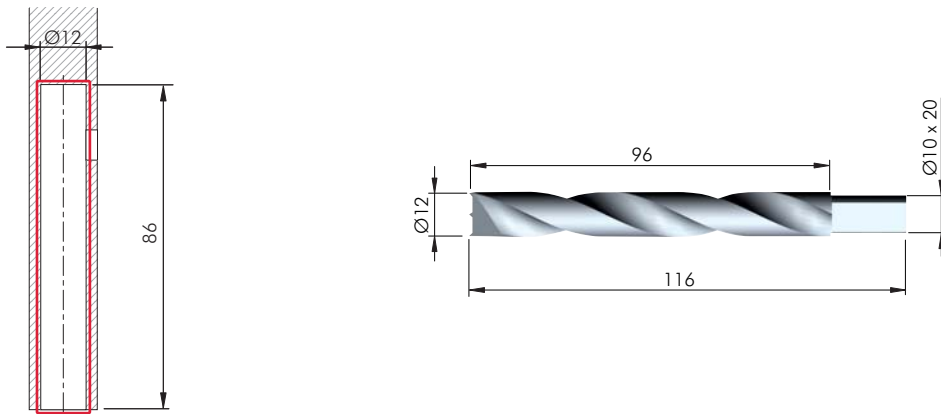

		= on request
<b>3030159000</b>		

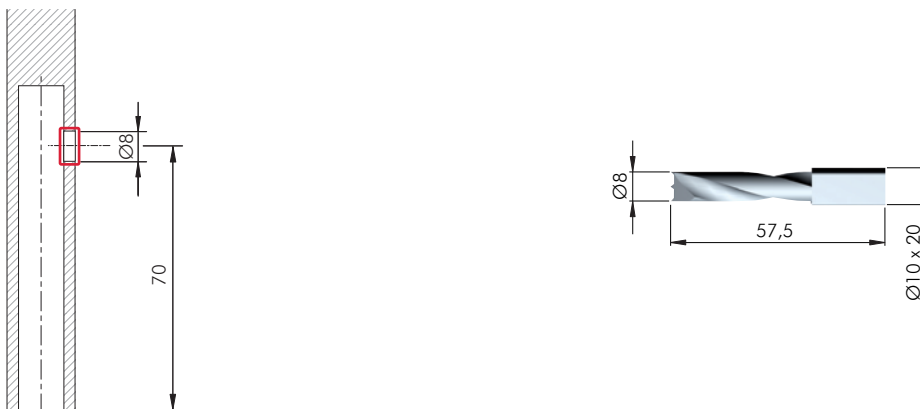

		= on request
<b>1145202000</b>		



## REKORD 12 H 96 mm

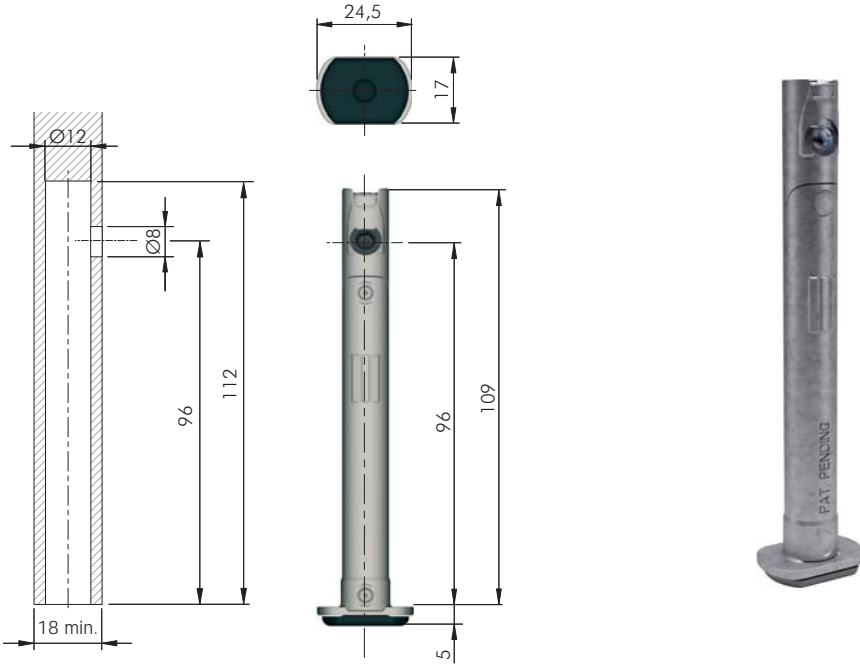

	= S4		= 125 pcs.
3030103000			

## DRILL BIT FOR REKORD 12 H 96 mm

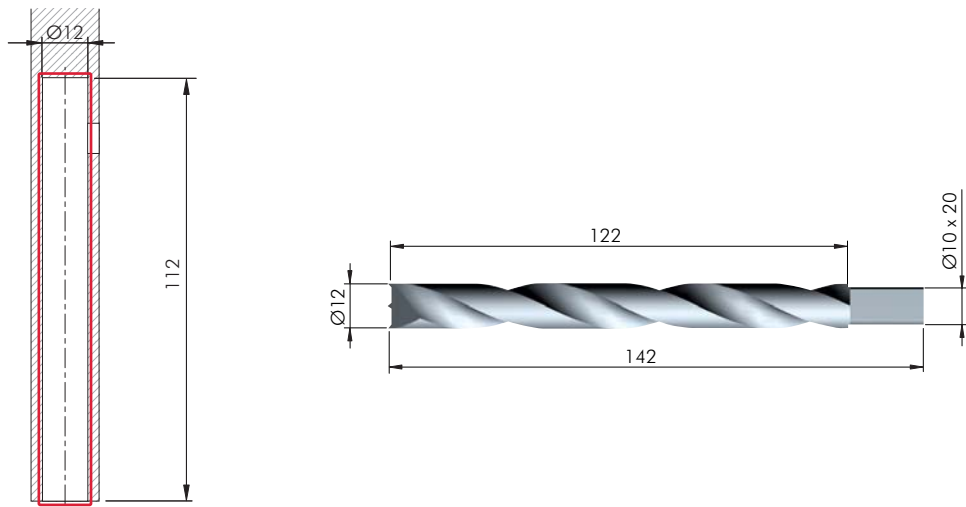

HSS		= on request
3030153000		

10

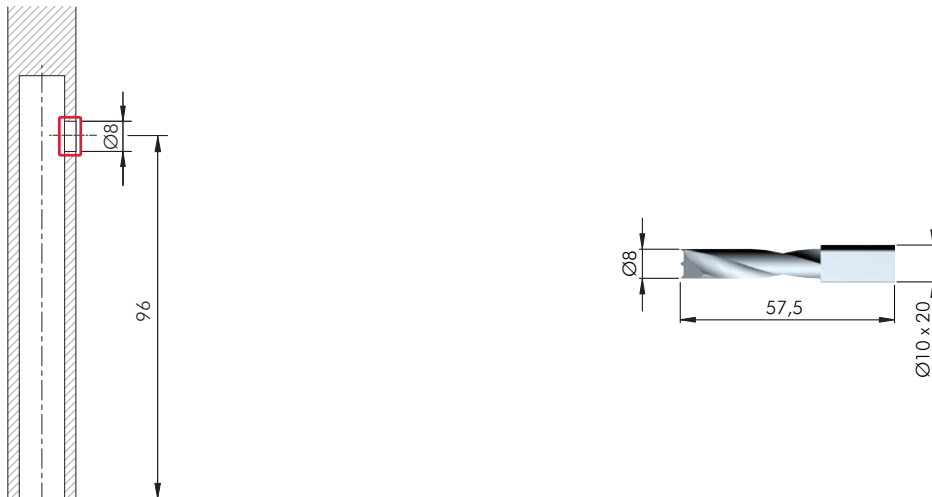

HSS		= on request
1145202000		



REKORD 12 H 120 mm

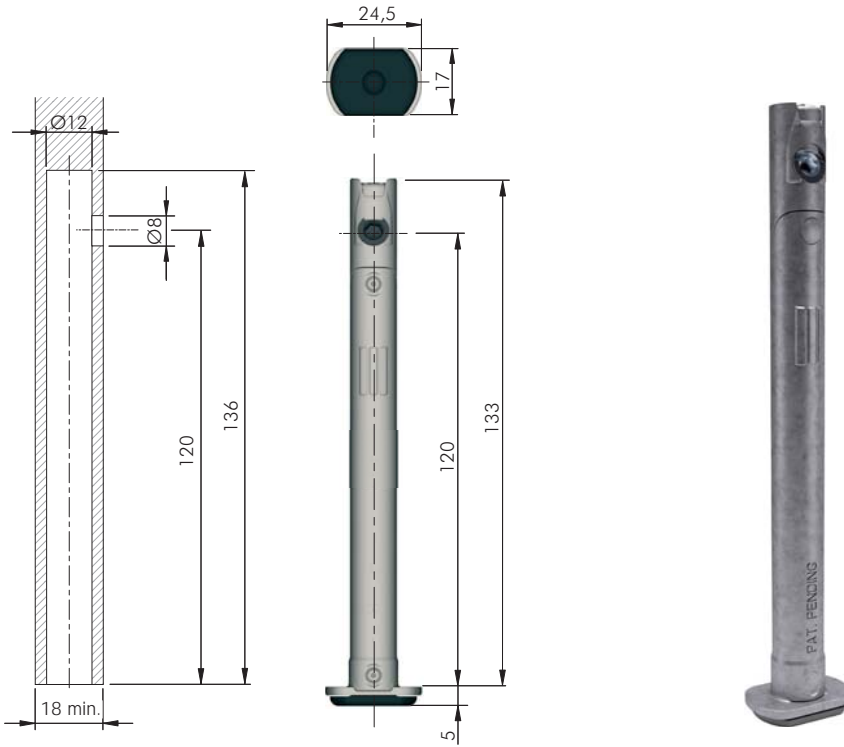

= S4	= 100 pcs.
ZA EP ST	
123	
3030104000	

DRILL BIT FOR REKORD 12 H 120 mm

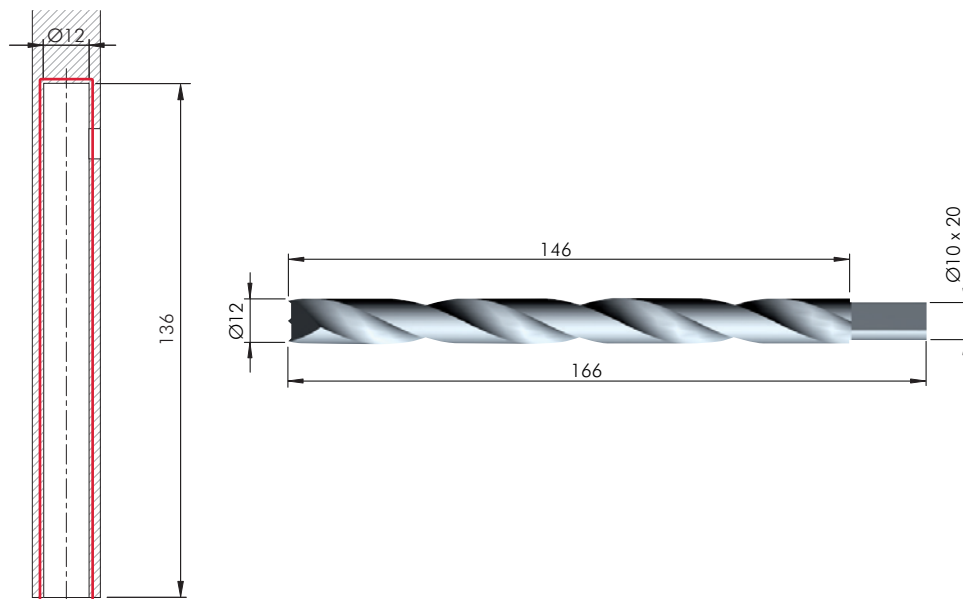

HSS	= on request
123	
3030152000	



# LEVELLERS

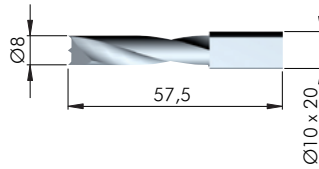
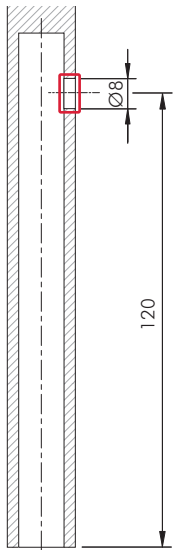

HSS	= on request
1145202000	

## REKORD 12 ACCESSORY

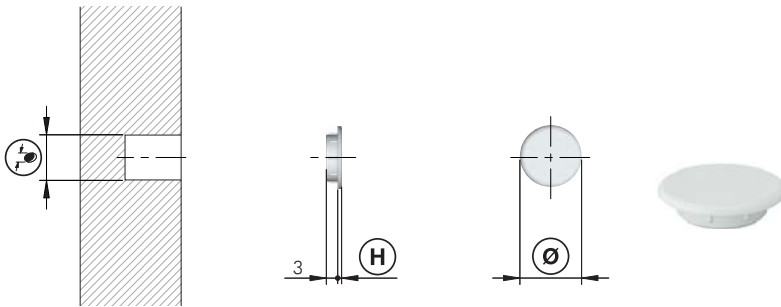

= Ø 8 mm	
EP	
23002010AB	Ø 8
Ø 11	1
5000	



## DRILLING JIG FOR REKORD 12

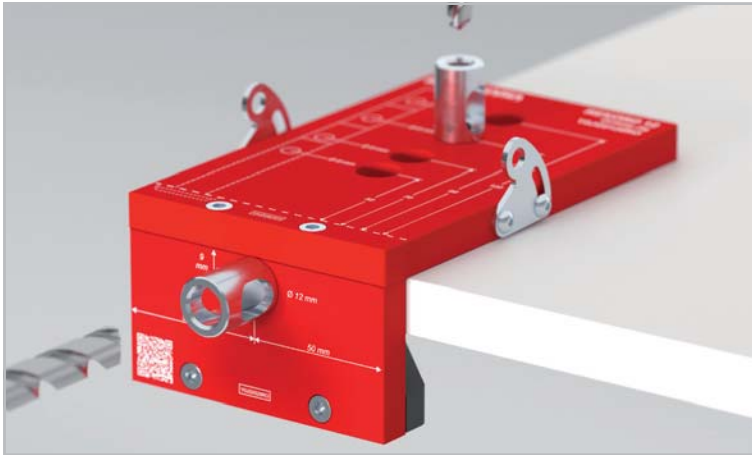

18 - 30 mm 

### GENERAL SPECIFICATIONS

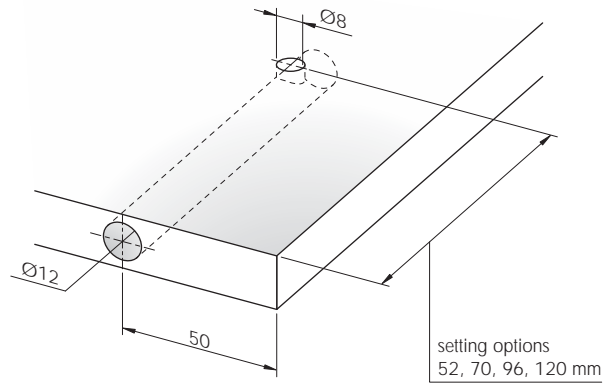
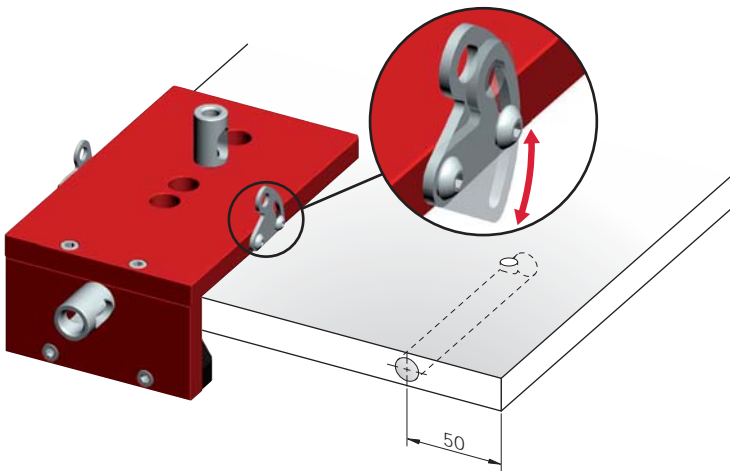

### APPLICATION OPTIONS

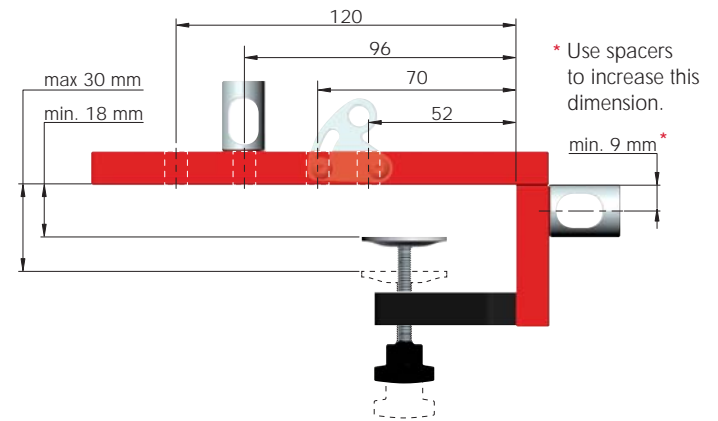
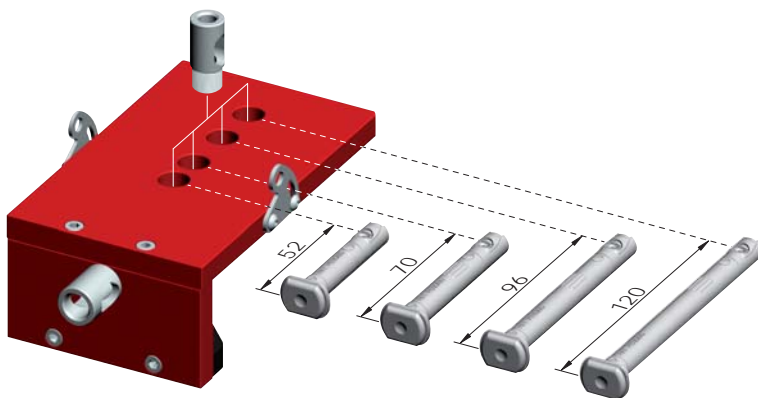

10

### DRILLING SPACERS FOR OTHER PANEL THICKNESSES

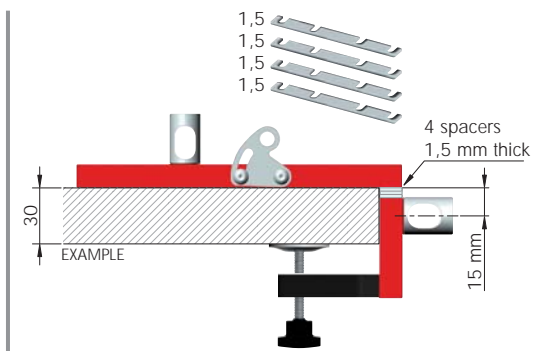
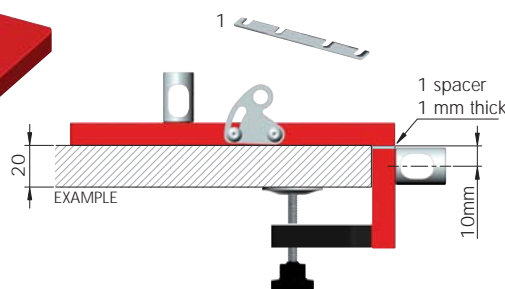
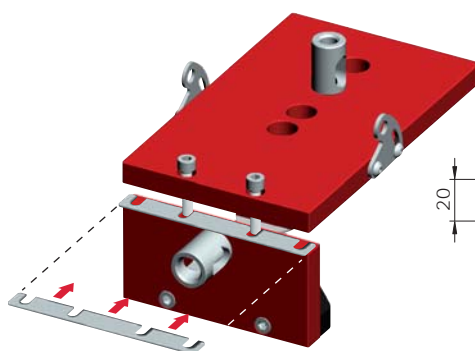

[Back to table of contents](#)



## REKORD 12 DRILLING JIG FOR PANEL THICKNESS 18 mm



AL	ST	EP	= on request
Y0JG0120RO			

NOTE: The product code includes all the components shown in the picture.

## REKORD 12 DRILLING JIG ACCESSORIES

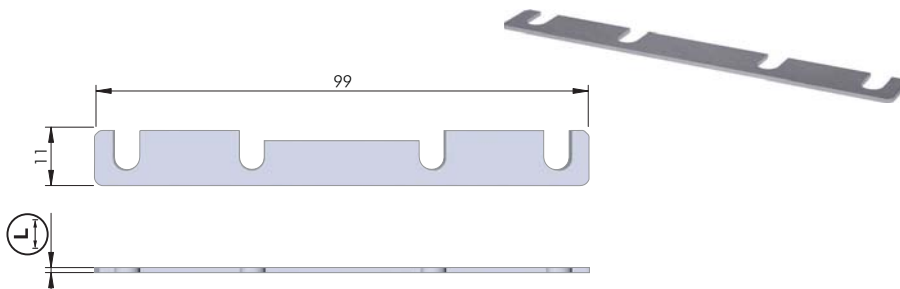

AL	= on request
Y0JG0511GR	1
Y0JG0512GR	1,5

## DRILLING JIG DEPTH STOP COLLARS



ST	= on request
Y0JG051700	Ø8
Y0JG051900	Ø12

## DRILL BIT

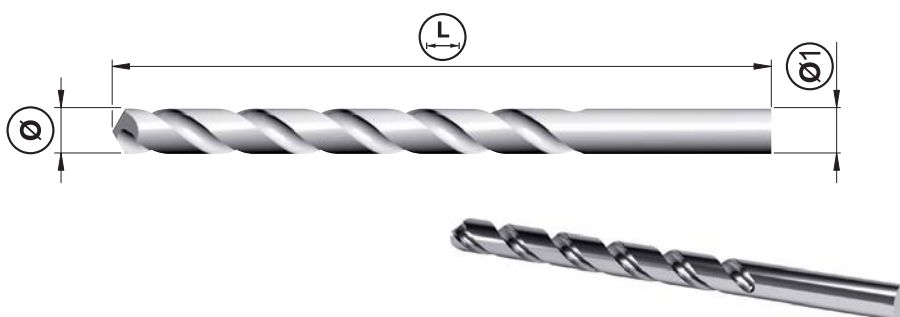

HSS	= on request		
Y0JG052800	Ø8	117	Ø8
Y0JG054700	Ø12	205	Ø10

NOTE: For drilling jig we recommend to use precision-ground steel drill bit HSS-G.

[Back to table of contents](#)



## LEVELLER Ø 14



150 Kg per piece 

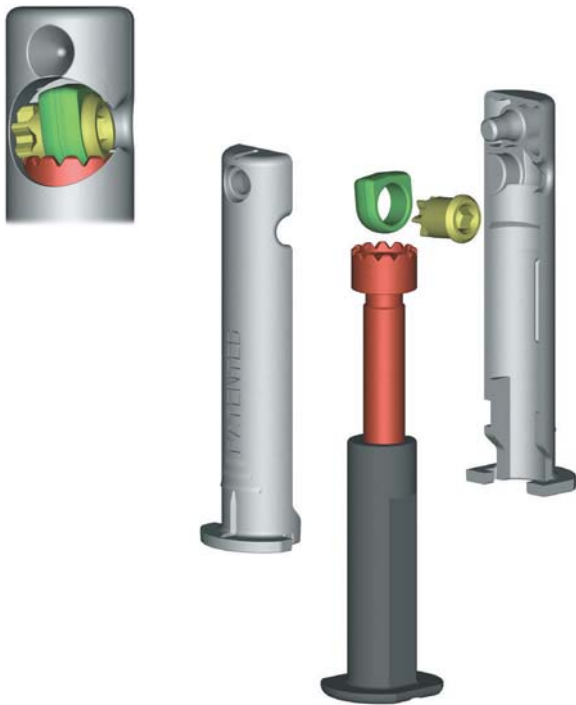

### INSTALLATION

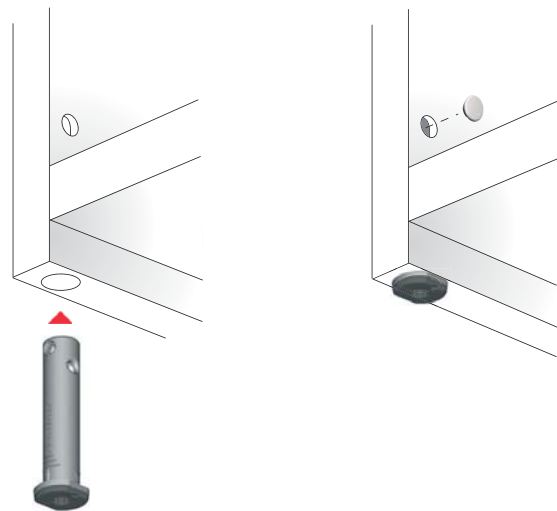

### ADJUSTMENT

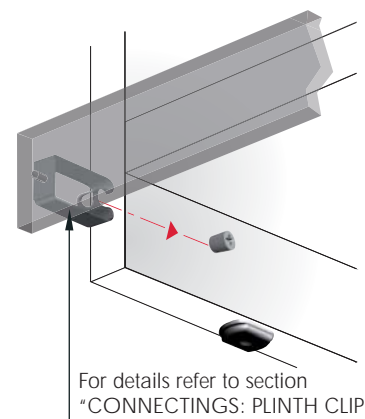
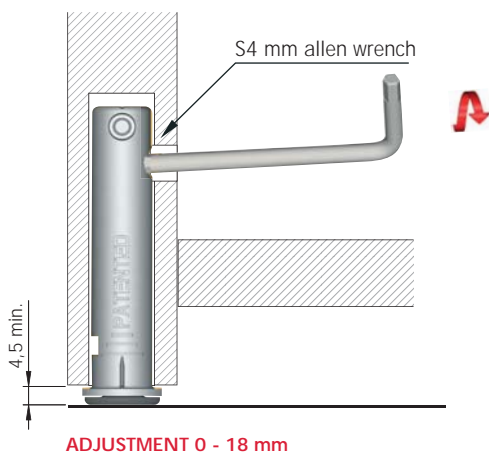





## LEVELLER Ø 14 H 52 mm

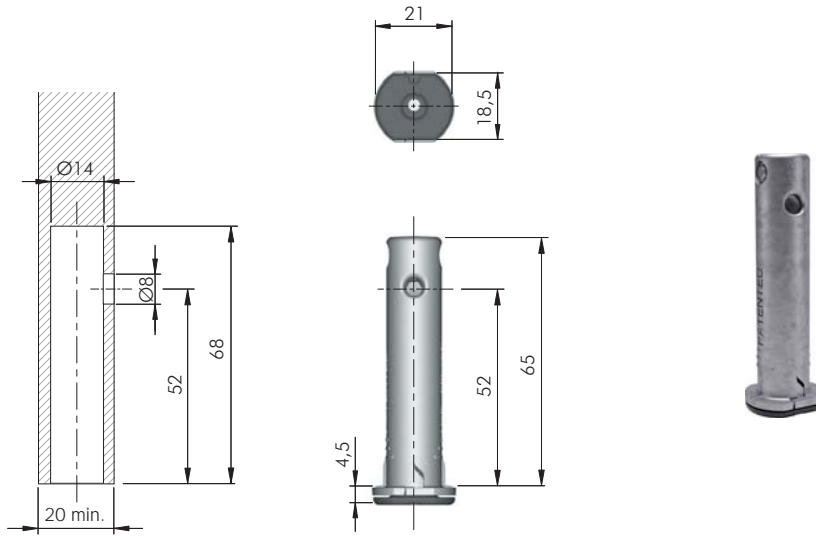

= S4	= 200 pcs.
ZA EP ST	
1 2 3	
<b>3030201000</b>	

## DRILL BIT FOR LEVELLER Ø 14 H 52 mm

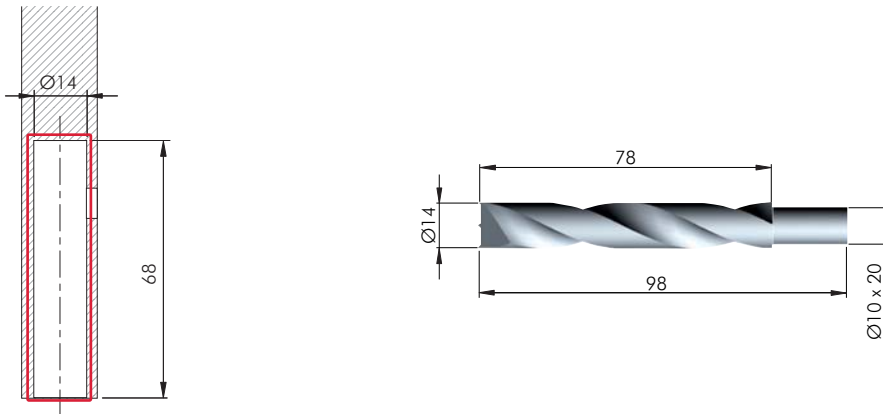

HSS	= on request
1 2 3	
<b>3030154000</b>	

10

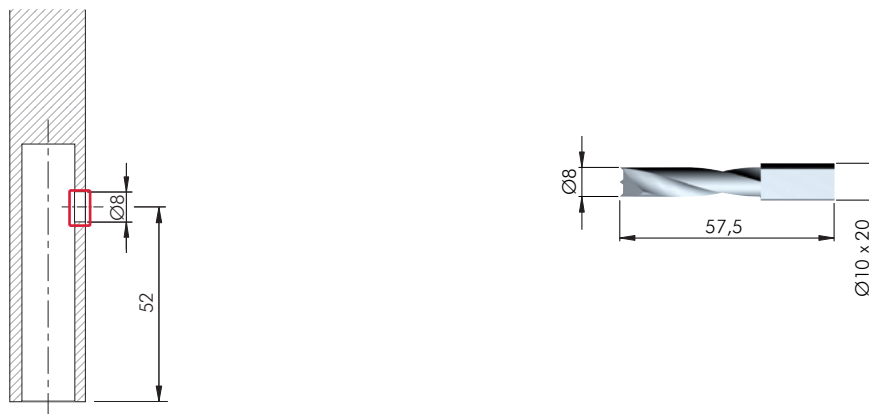

HSS	= on request
1 2 3	
<b>1145202000</b>	



LEVELLER Ø 14 H 70 mm

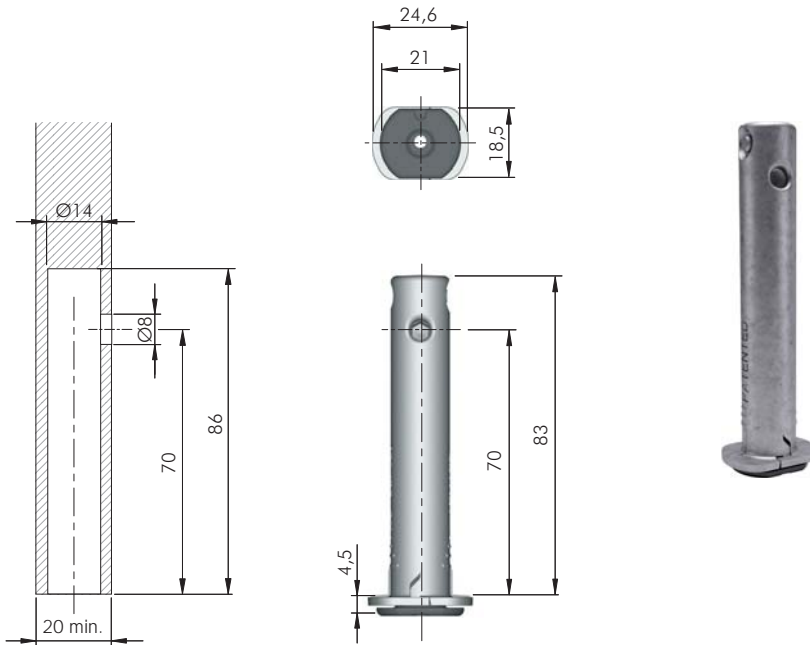

= S4	= 150 pcs.
ZA EP ST	
123	
<b>3030202000</b>	

DRILL BIT FOR LEVELLER Ø 14 H 70 mm

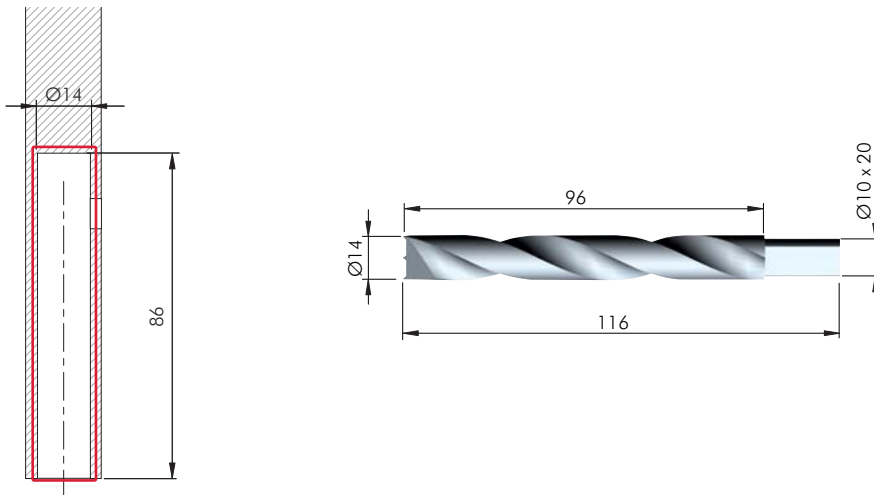

HSS	= on request
123	
<b>3030155000</b>	

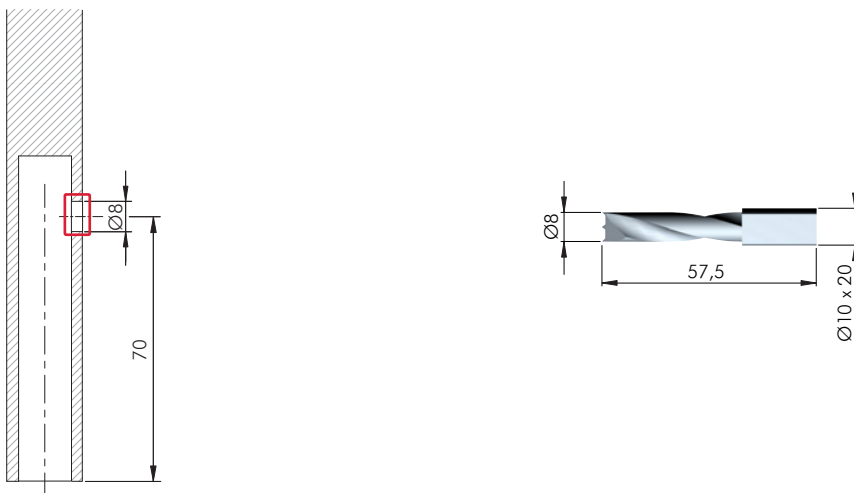





HSS	= on request
123	
<b>1145202000</b>	

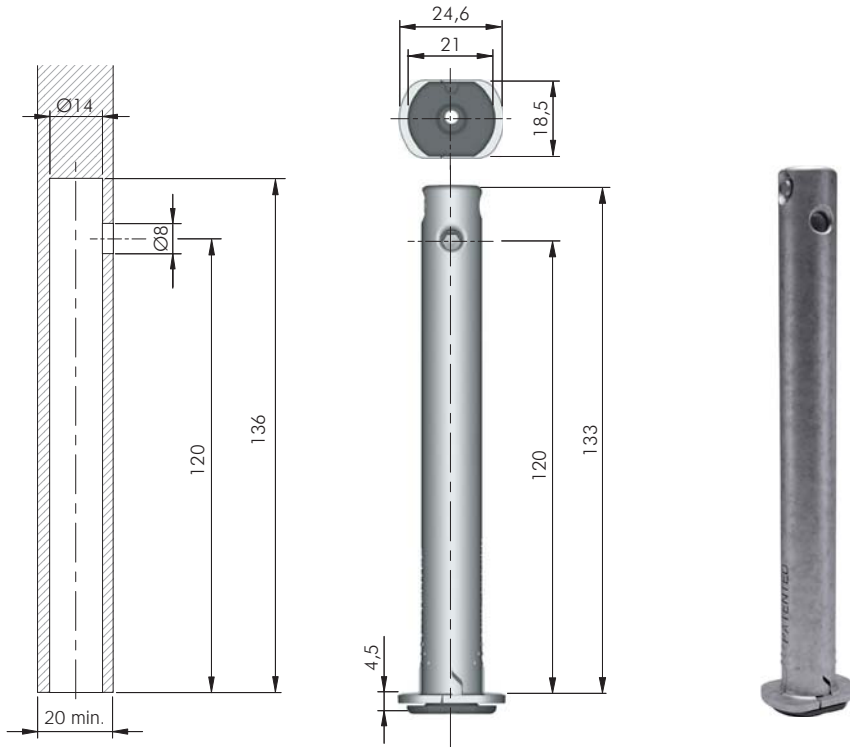





## LEVELLER Ø 14 H 120 mm

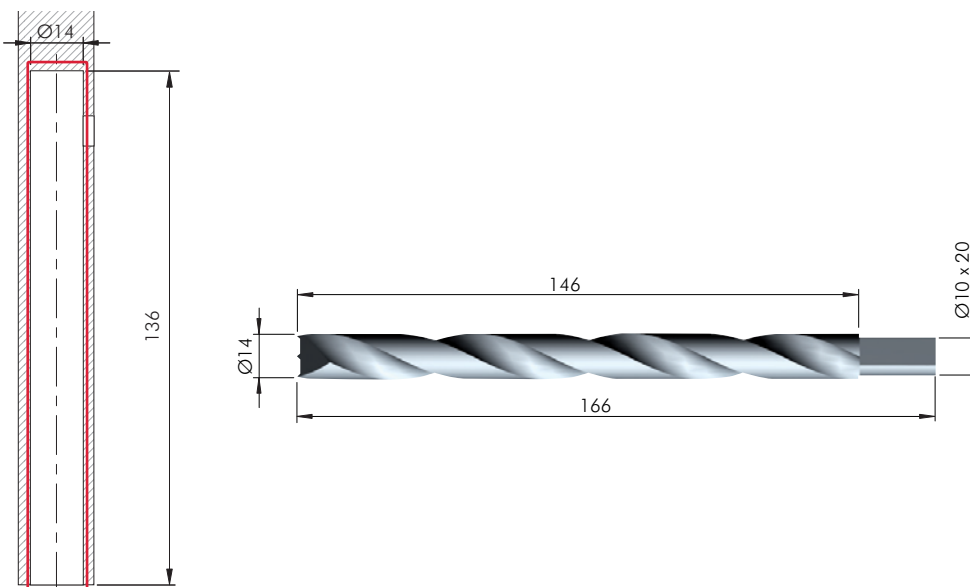

 = S4	 = 100 pcs.
ZA EP ST	
 123	
3030203000	

## DRILL BIT FOR LEVELLER Ø 14 H 120 mm



HSS	 = on request
 123	
3030156000	

10

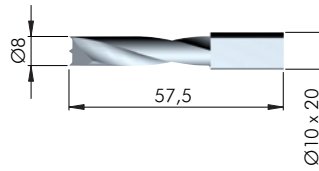
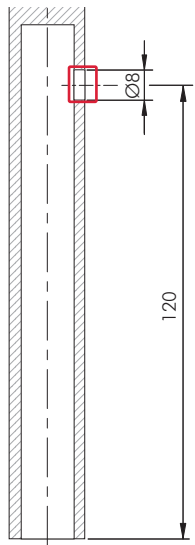

HSS	= on request
123	
<b>1145202000</b>	

**LEVELLER Ø 14 ACCESSORY**

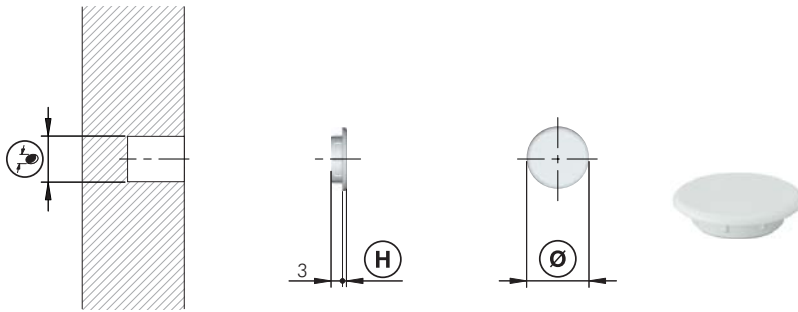

= Ø 8 mm					
EP					
123					
<b>23002010AB</b>	Ø 8	Ø 11	1	5000	



## ATACAMA



175 Kg per piece 

### INSTALLATION

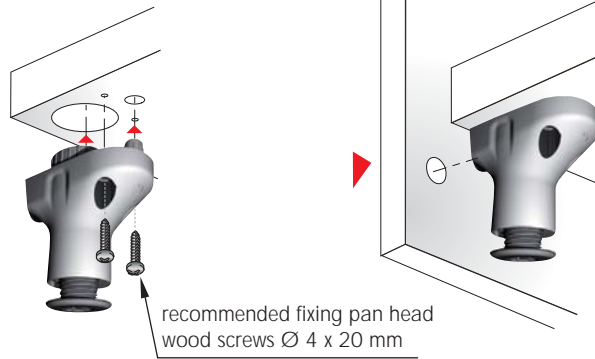
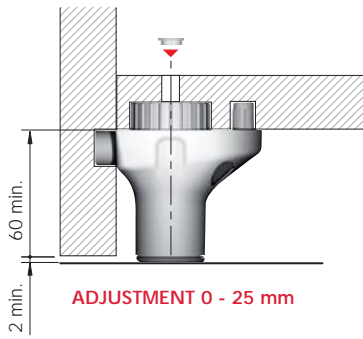

### ADJUSTMENT

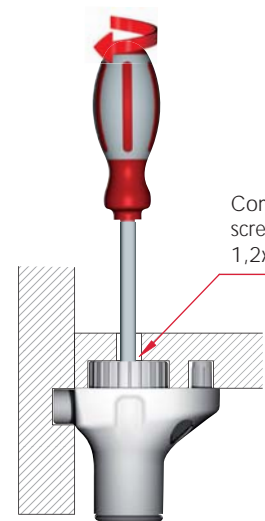

Combi slot for S6mm allen wrench or blade screwdriver 1x5,5 mm (LOWER CAVITY) or 1,2x8 mm (UPPER CAVITY).

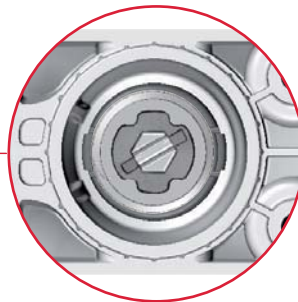

#### VERY IMPORTANT:

1) Both the screwdriver as well as the allen wrench must be fully inserted in the cavities, in order to avoid damaging of the engineering plastic sockets.

2) Loading capacity = 175Kg each.

However, notice that with furniture already loaded:

- Adjustment capacity through S6 mm allen wrench ≤ 175Kg.
- Adjustment capacity through 1x5,5 mm blade screwdriver (LOWER SLOT) ≤ 63Kg.
- Adjustment capacity through 1,2x8 mm blade screwdriver (HIGHER SLOT) ≤ 63Kg.

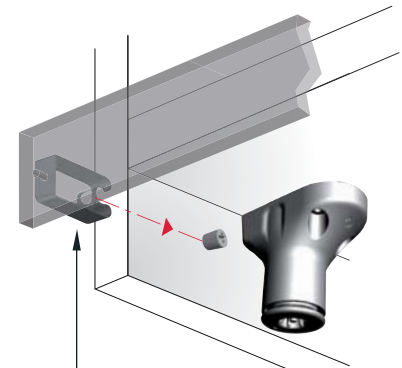

For details refer to section "CONNECTINGS: PLINTH CLIP"

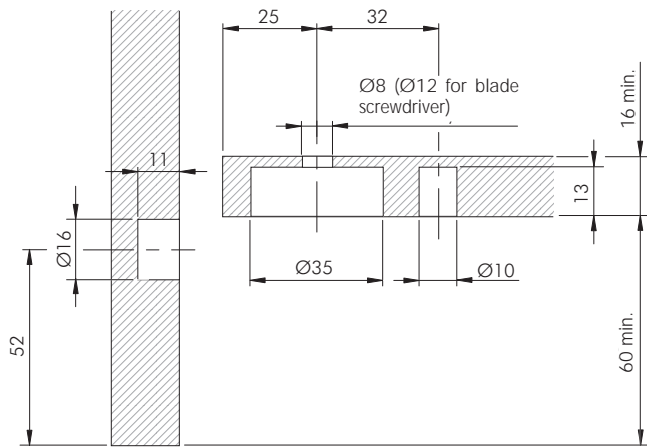

= S6	= 1x5,5 mm (LOWER SLOT) 1,2x8 mm (HIGHER SLOT)
EP	= 70 pcs.
123	
<b>31601000U</b>	

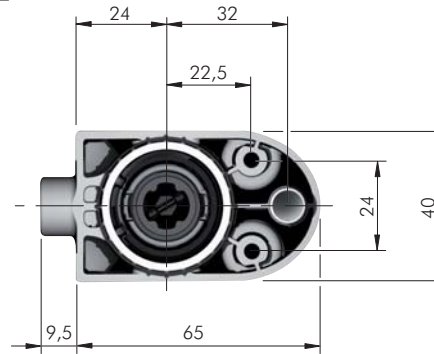

## ATACAMA ACCESSORY

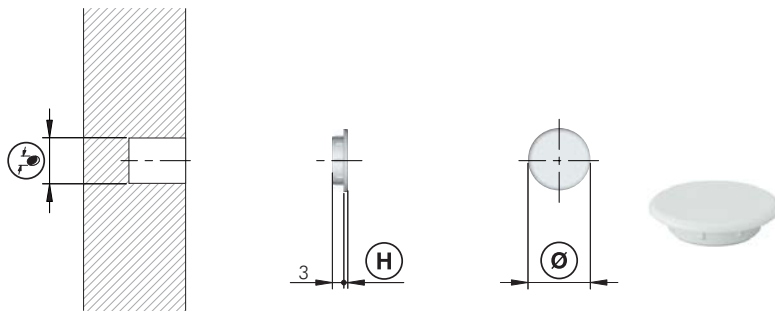

= Ø 8, Ø 12 mm				
EP				
123				
<b>23002010AB</b>	Ø 8	Ø 11	1	5000
<b>23002030AB</b>	Ø 12	Ø 15	1	5000

## ATACAMA FIXING ACCESSORY

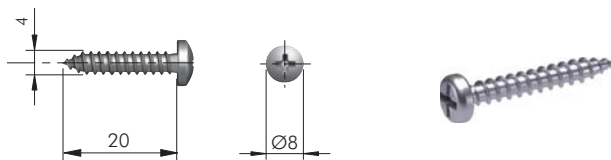



		= PZ2	
ST	= 500 pcs.		
123			
<b>60103270ZN</b>			



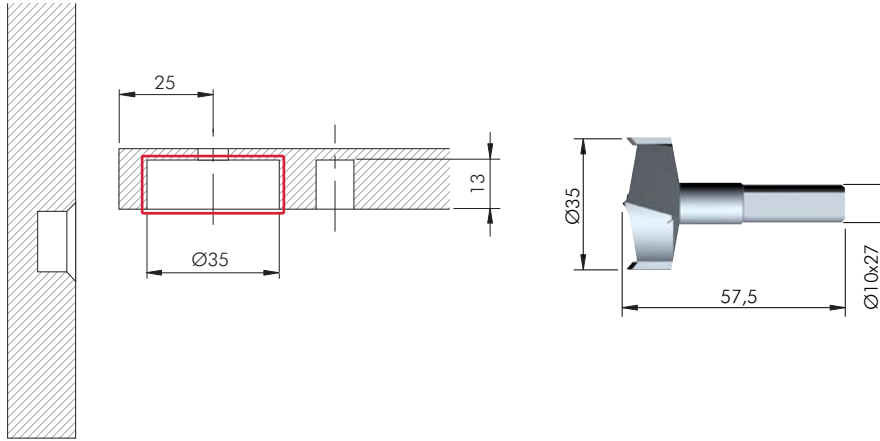

## DRILL BIT FOR ATACAMA



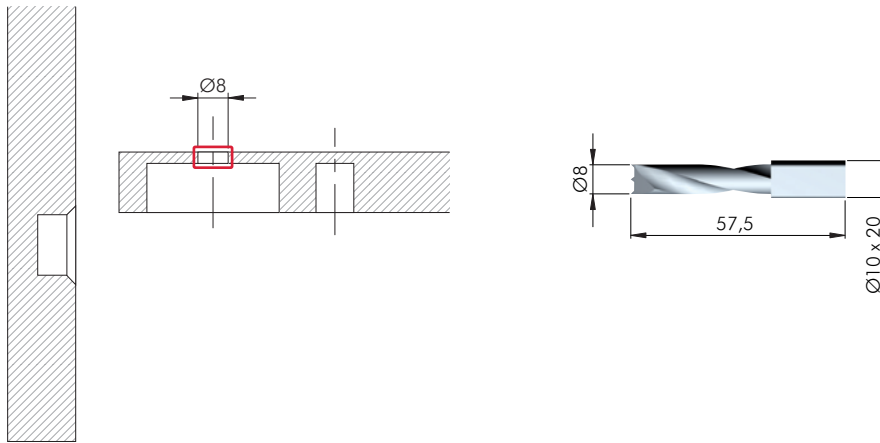

HSS  = on request

  **3175201000**



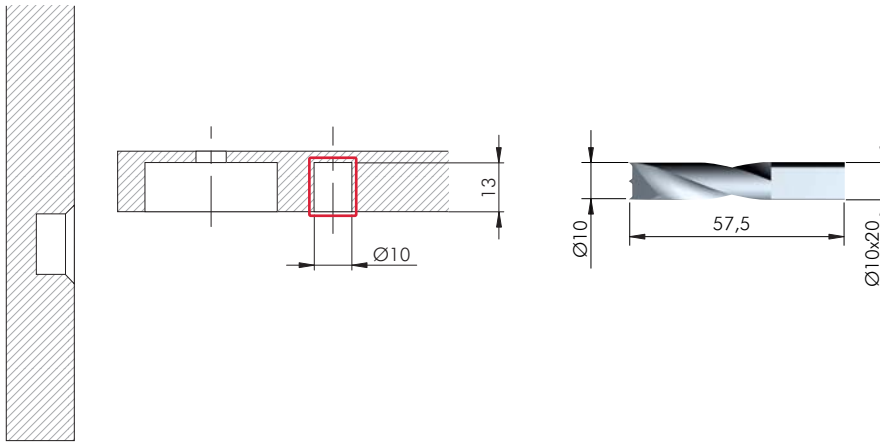

HSS  = on request

  **1145202000**



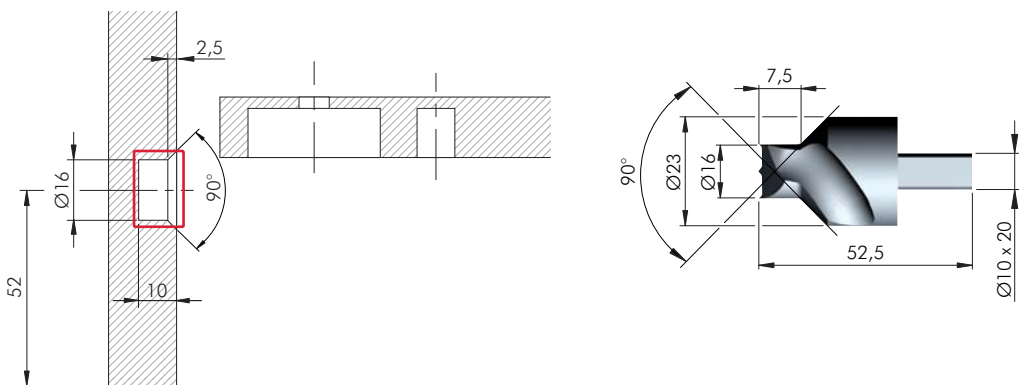

HSS  = on request

  **1220101000**



HSS  = on request

  **3175202000**





LH60.20 ADJUSTABLE LEVELLER



175 Kg per piece



INSTALLATION

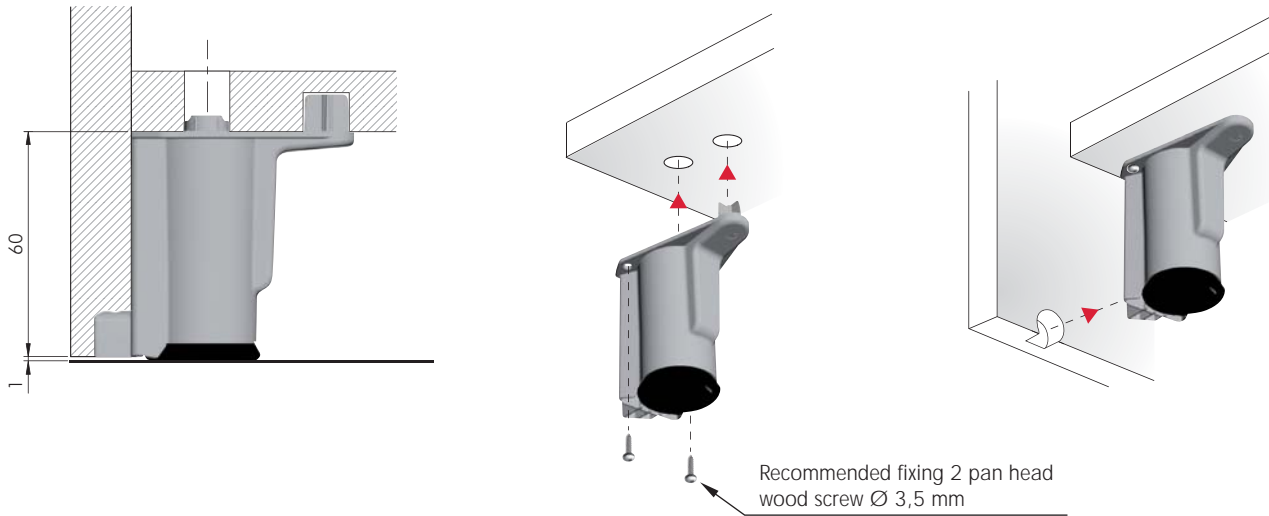

ADJUSTMENT

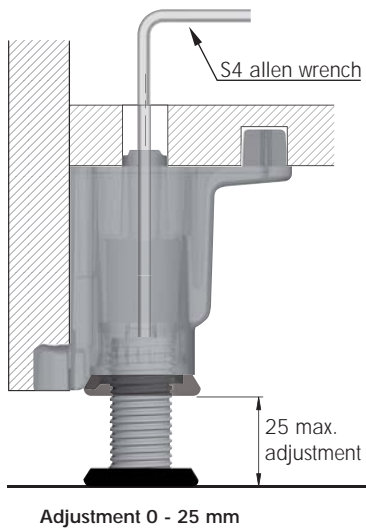

APPLICATION FOR PARTITION 16 mm THICK

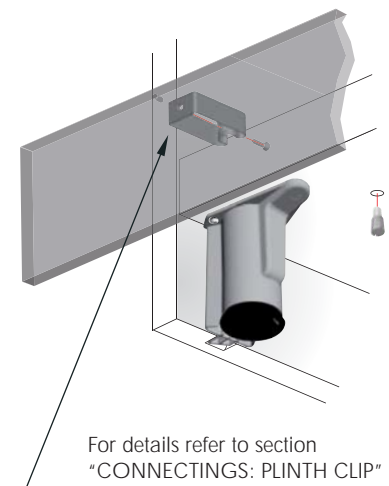
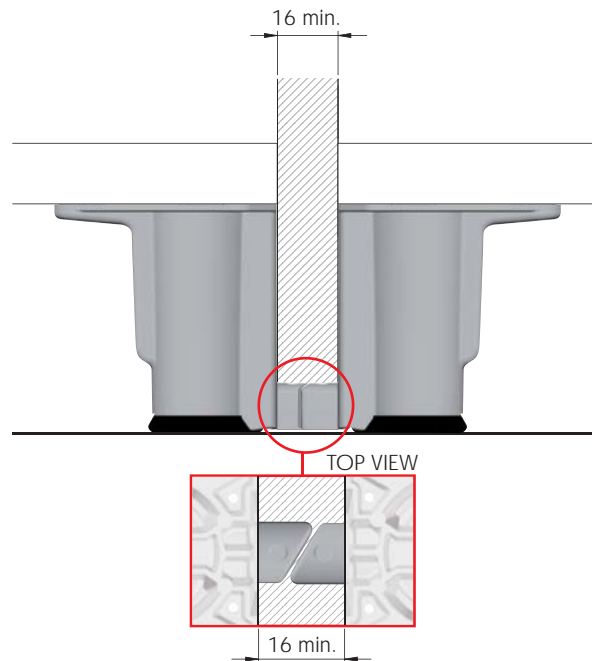

10

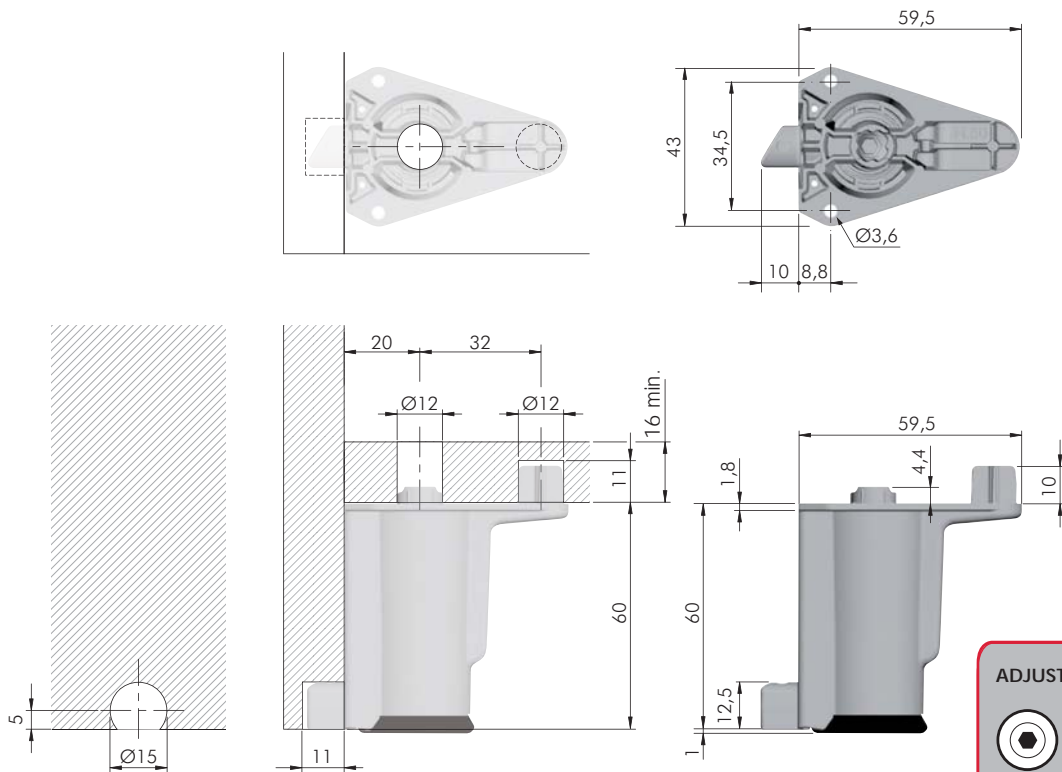

ADJUSTMENT 0 - 25 mm

= S4 / S6 mm

= 70 pcs.

**P1801761U**

## LH60.20 LEVELLER ACCESSORY

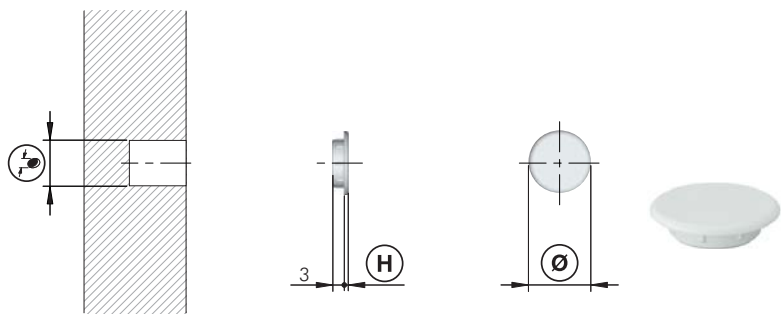

= Ø 12 mm

**23002030AB** Ø 12 Ø 15 1 5000

10

## LH60.20 LEVELLER FIXING ACCESSORY

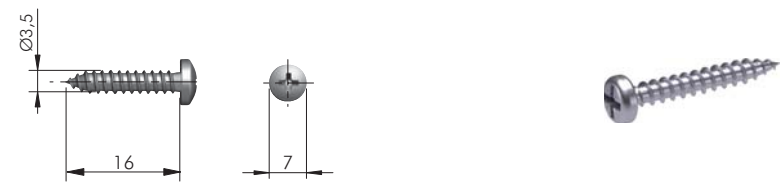

= Ø 2,5 mm

= PZ2

= 10.000 pcs.

**60103140ZN**



ATACAMA J



interzum award:  
intelligent  
material & design  
2009

175 Kg per piece



INSTALLATION

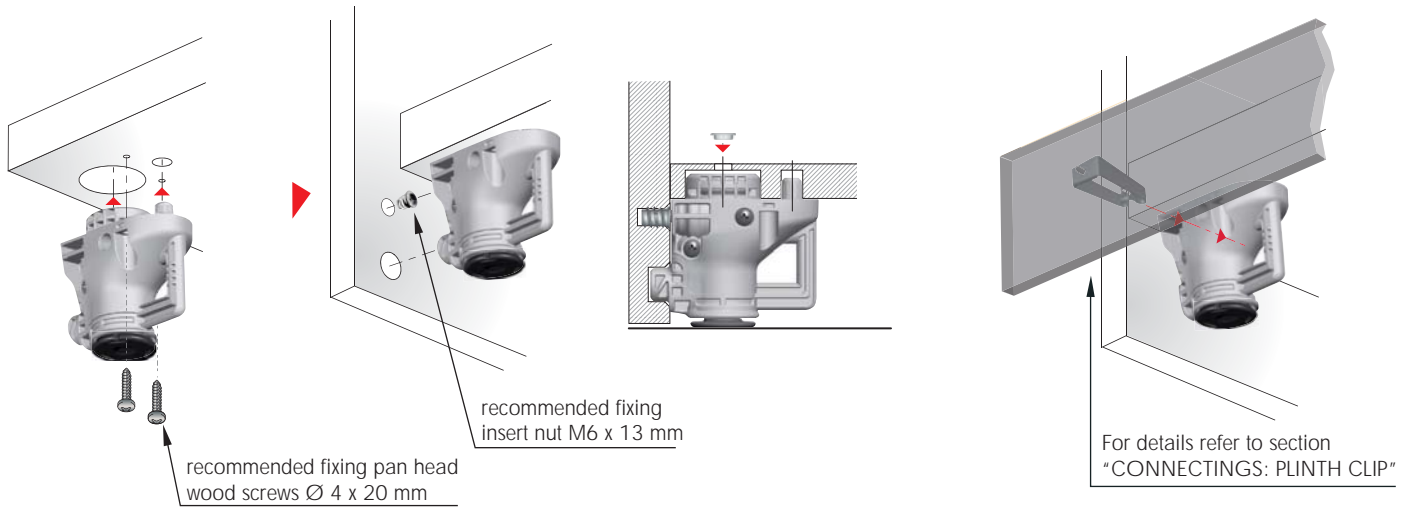

STEP 1

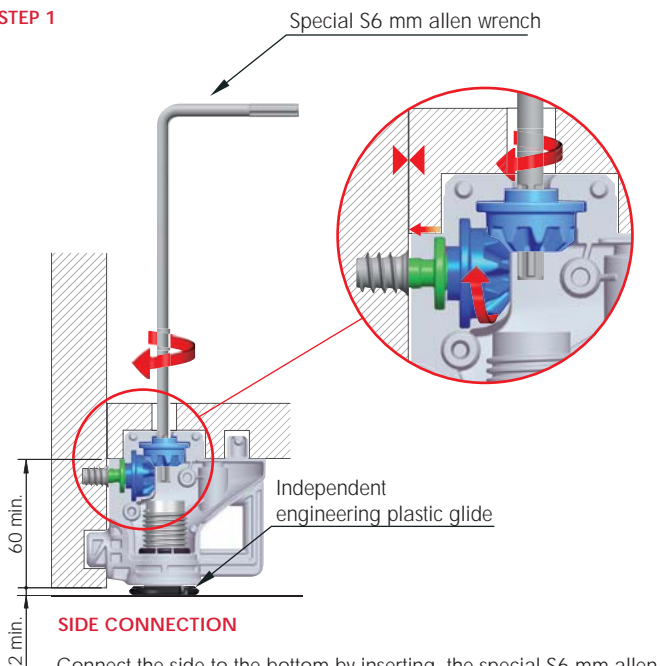

Connect the side to the bottom by inserting the special S6 mm allen wrench with hexagonal bit into the through hole, until it fits into the first cavity.

STEP 2

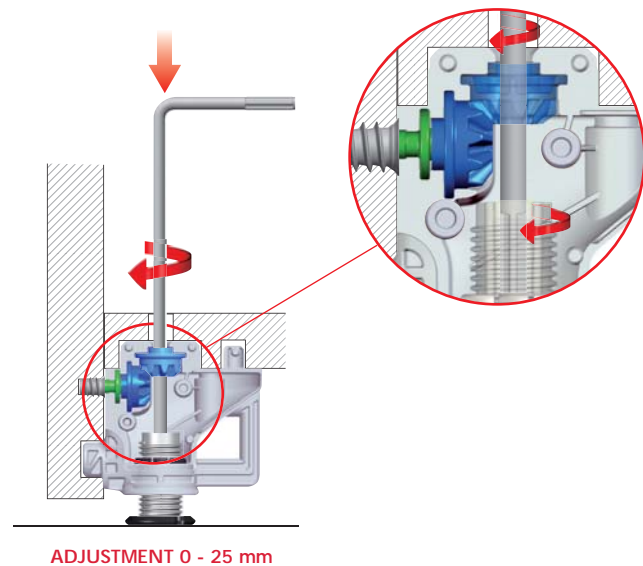

Adjust the height of the construction by lowering the hexagonal bit until it fits the cavity of the die-cast foot.

## ATACAMA J : APPLICATION FOR SIDE PANEL

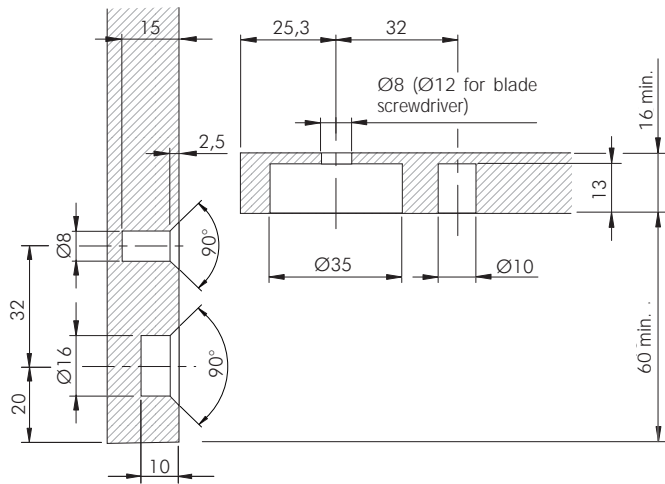

= M6    = special S6  
        = 70 pcs.  
 123 **31701000IJ**

Special allen wrench is required part no. 31702000ZN.

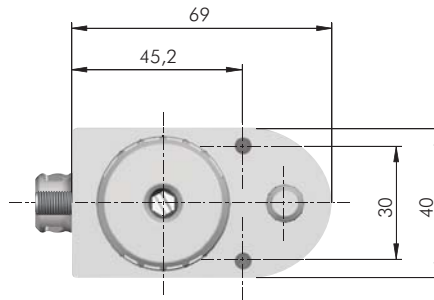
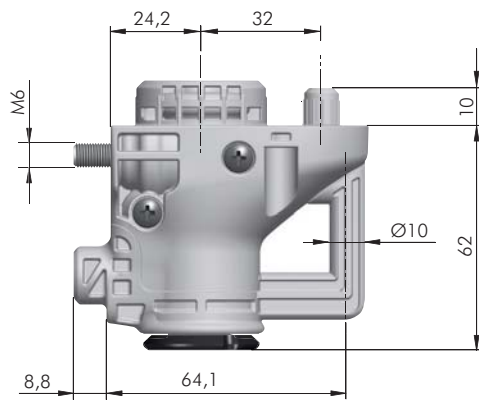

## ATACAMA J FIXING ACCESSORIES FOR SIDE PANEL

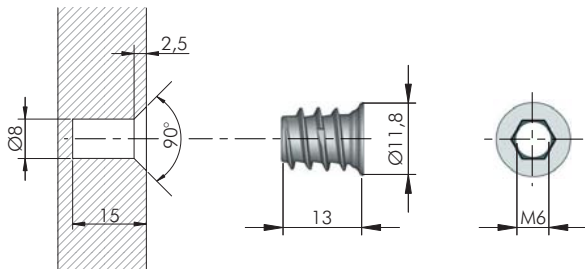

= Ø 8 mm    +   
   = M6    = S6  
    = 5000 pcs.  
 123 **20102020GR**

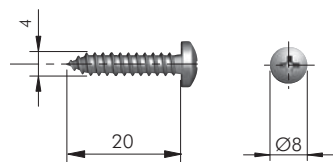

    = PZ2    +   
    = 500 pcs.  
 123 **60103270ZN**



**ATACAMA J: APPLICATION FOR PARTITION 18 - 19 mm THICK**

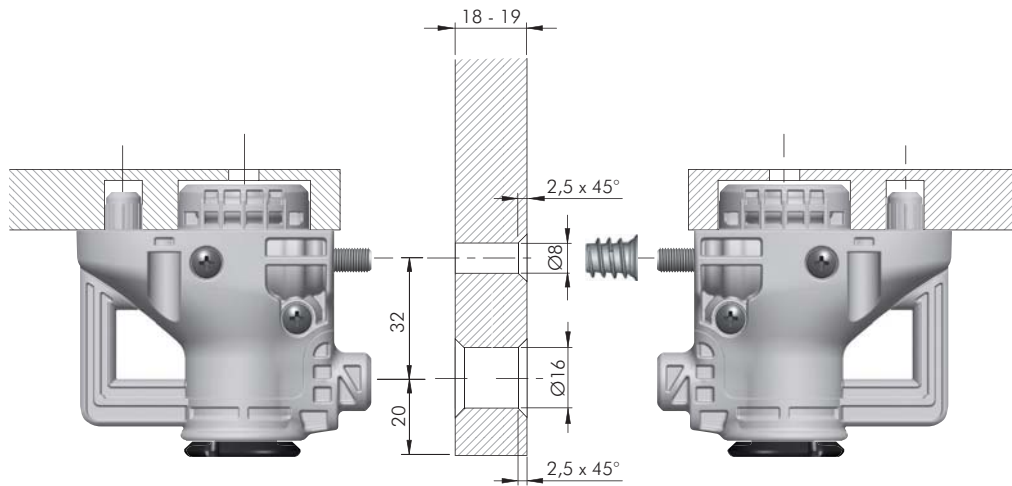

**ATACAMA J FIXING ACCESSORIES FOR PARTITION 18 - 19 mm THICK**

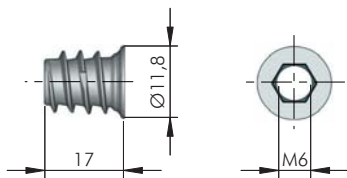

	= Ø 8 mm	+	
	= M6		= S6
ZA		= 5000 pcs.	
20102040GR			

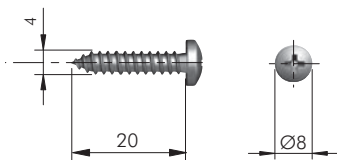

			= PZ2	+
ST		= 500 pcs.		
60103270ZN				



## ATACAMA J: APPLICATION FOR PARTITION 25 mm THICK

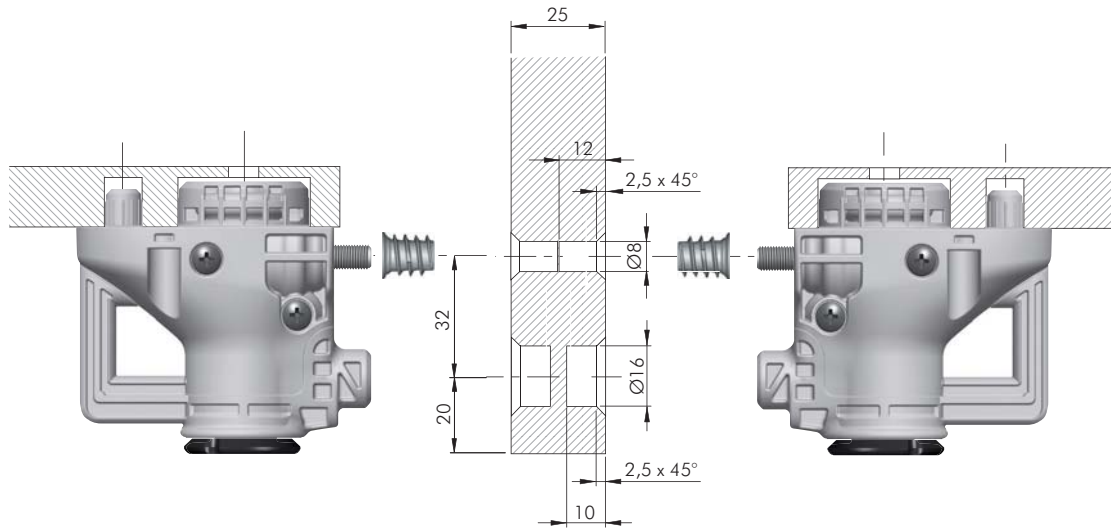

## ATACAMA J FIXING ACCESSORIES FOR PARTITION 25 mm THICK

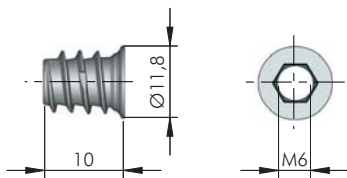

	= Ø 8 mm			
		= M6		= S6
				= 5000 pcs.
<b>20102010GR</b>				

10

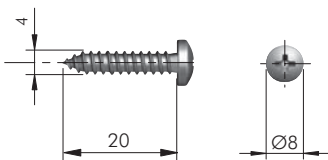

			= PZ2		
					= 500 pcs.
<b>60103270ZN</b>					



ATACAMA J ACCESSORIES

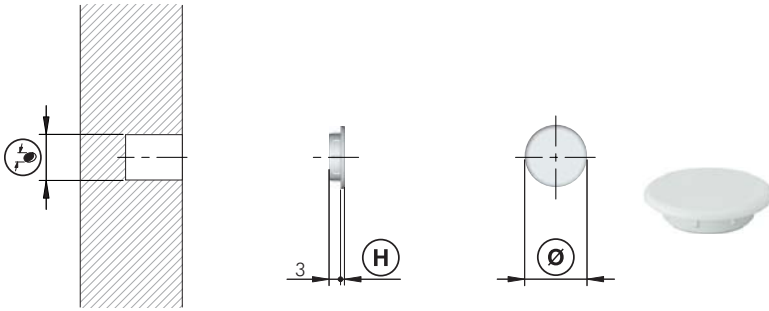

	= Ø 8, Ø 12 mm				+
EP					
23002010AB		Ø 8	Ø 11	1	5000
23002030AB		Ø 12	Ø 15	1	5000

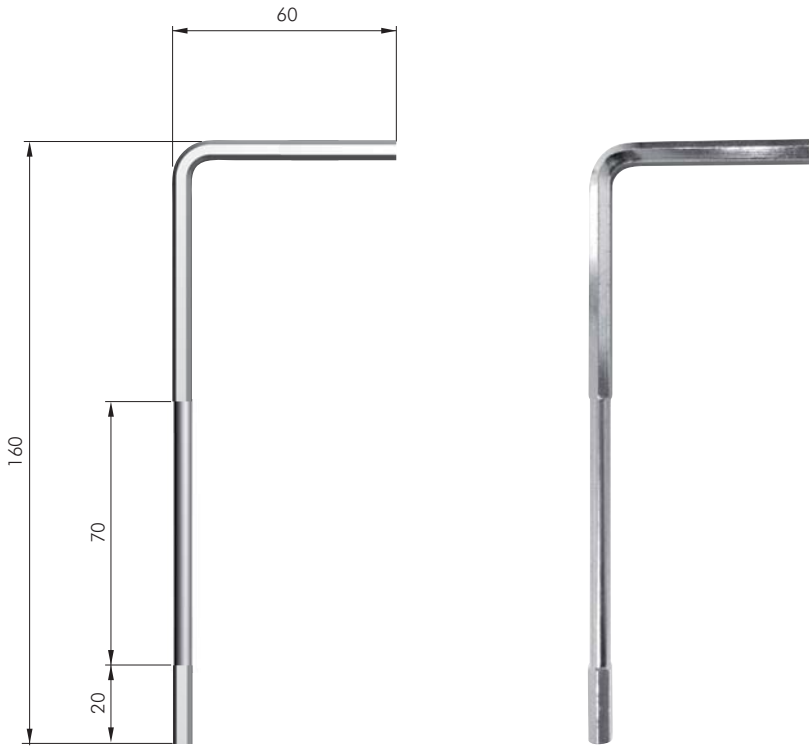

	= special S6 mm				= on request
ST					
31702000ZN					

PLINTH CLIP FOR ATACAMA J

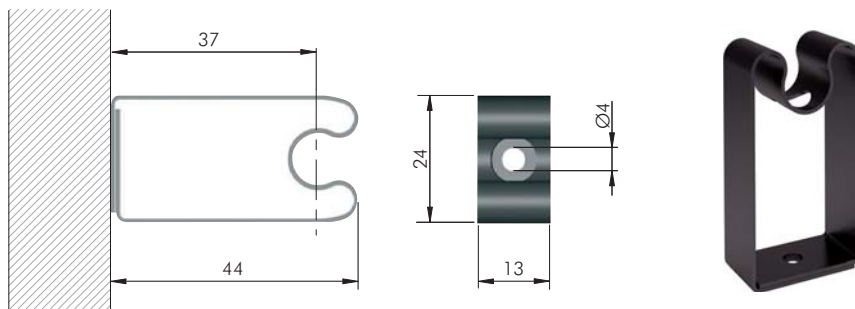

ST						= 1000 pcs.
31501030WI						





## OPTIONAL VERSION

### ATACAMA J WITH HEIGHT ADAPTER

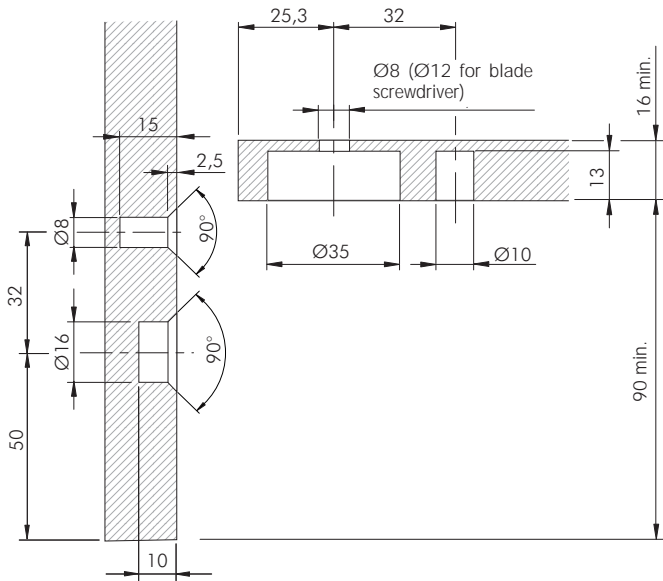

	= M6		= special S6
	ZA		EP
	ST		= 50 pcs.
	31703000IJ		

Special allen wrench is required part no. 31702000ZN.

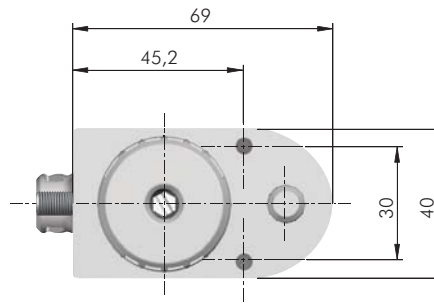
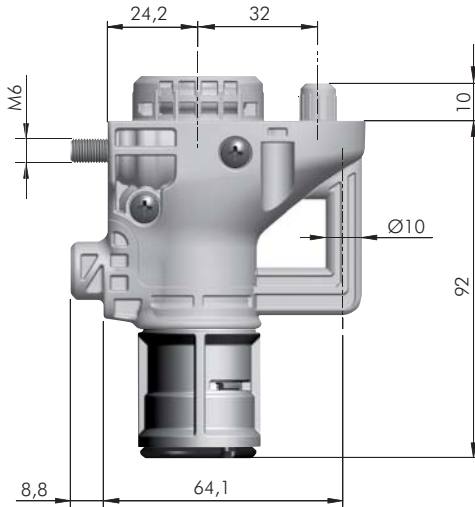





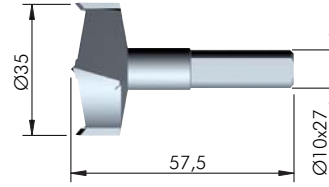
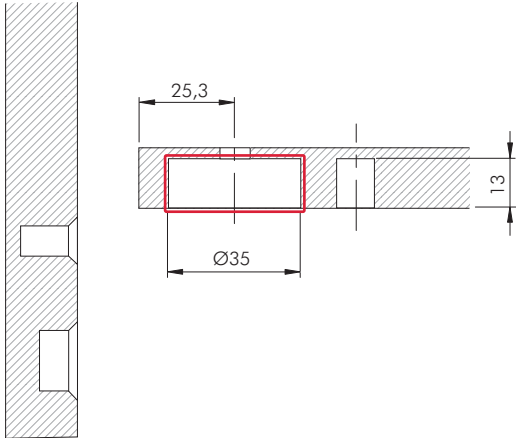

DRILL BIT FOR ATACAMA J



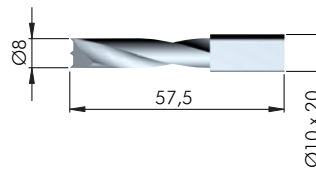
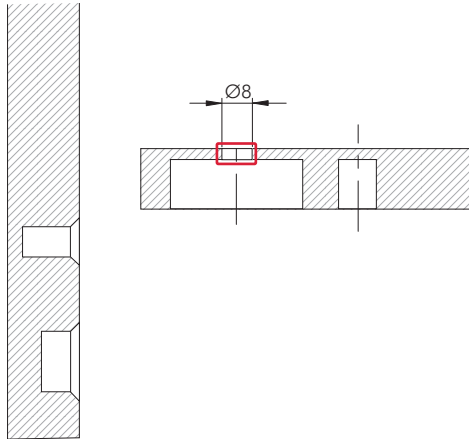

HSS  = on request

  **3175201000**



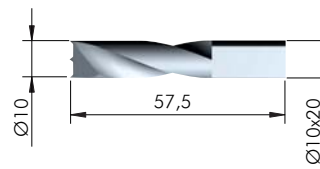
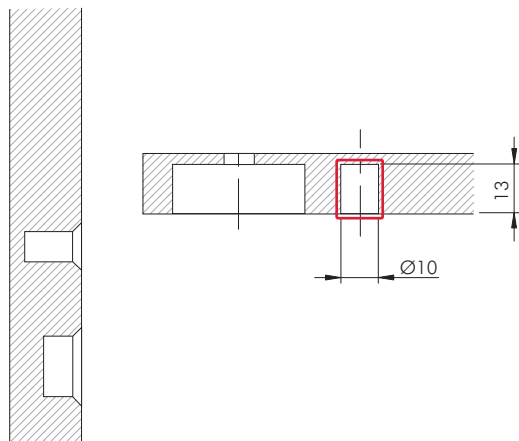

HSS  = on request

  **1145202000**





HSS  = on request



  **1220101000**

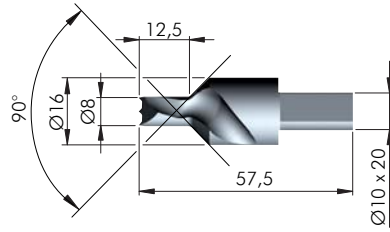
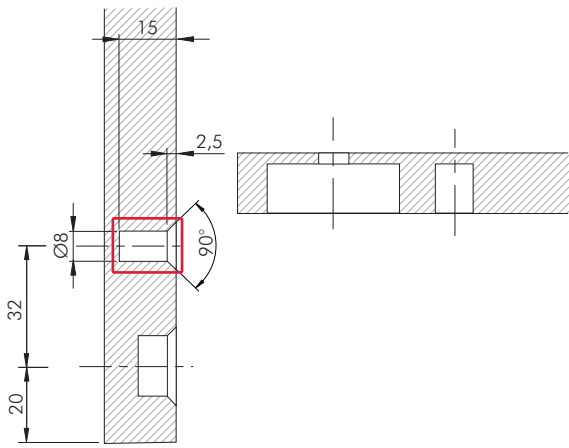

# LEVELLERS





HSS  = on request

  **3175205000** 

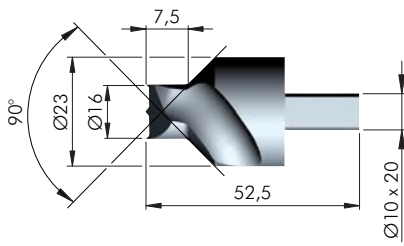
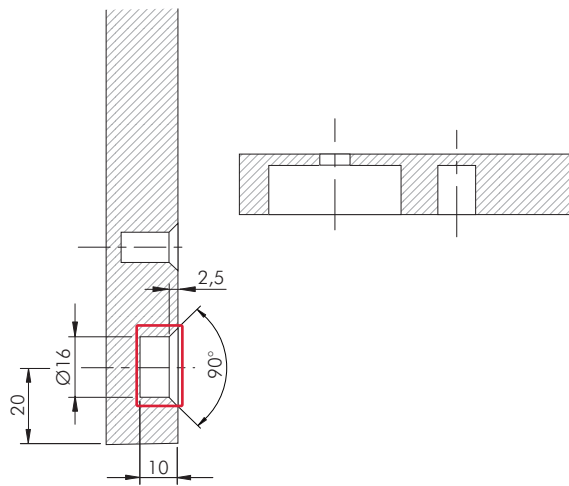
**3175211000** 



HSS  = on request

  **3175202000**