

HINGES

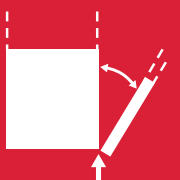

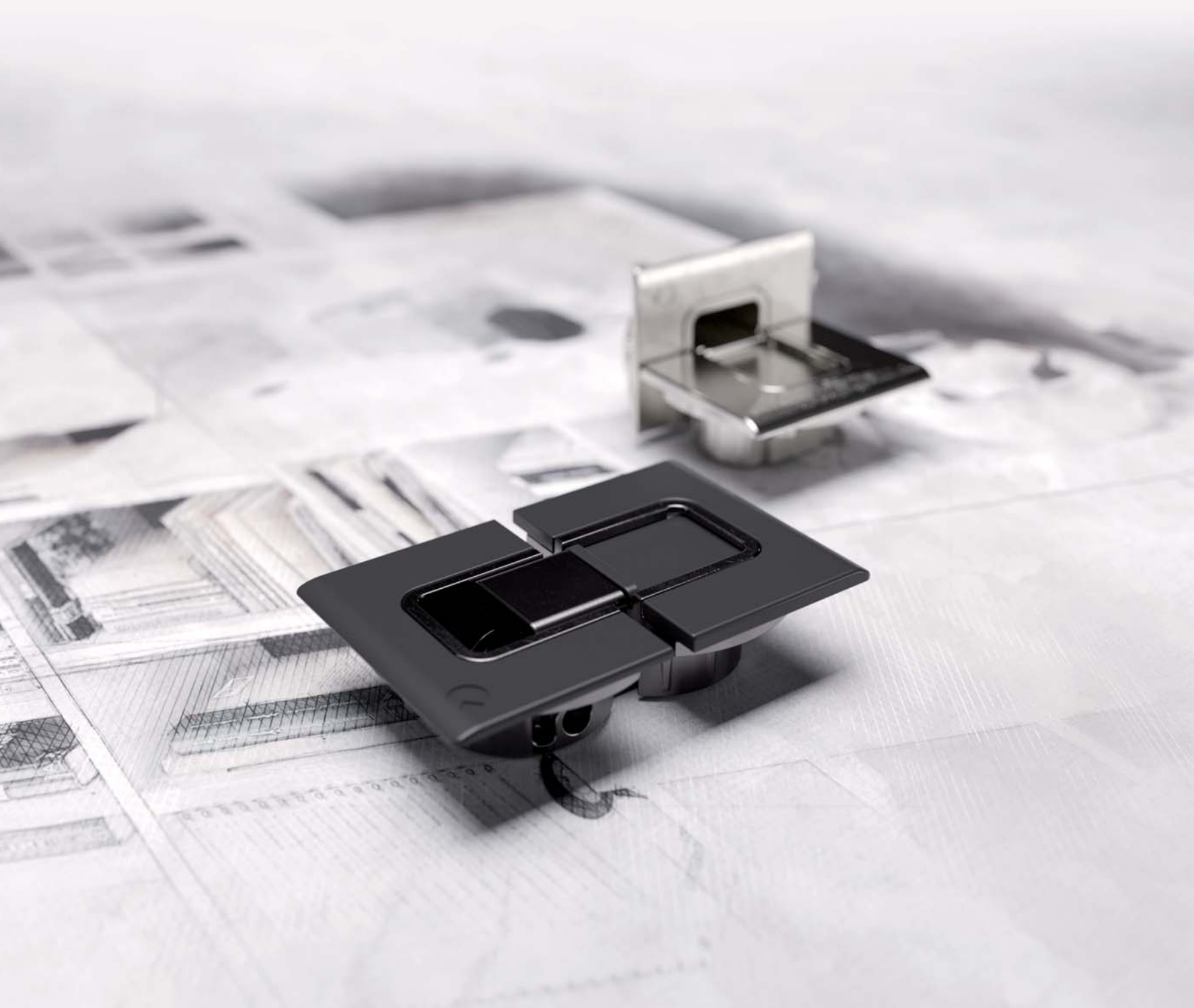

SYMBOLS AND FINISHES LEGEND

SYMBOLS

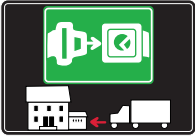

= SHELF SAFELY LOCKED DURING TRANSPORTATION AND AT HOME.



= ANTI-TURNOVER LOCKING SYSTEM



= NORMS / PATENTS



= PHILLIPS / POZIDRIV



= WITH BUFFER



= PART NO.



= BLADE SLOT



= WITH MAGNET



= PCS. PER PACKAGE



= COMBI SLOT



= NEWTON



= CAPACITY LOADING



= HEXALOBULAR SOCKET



= FRICTION



= WOOD / GLASS THICKNESS



= COUNTERSUNK HEAD



= AUTOMATIC



= HOLE DIAMETER



= PAN HEAD



= DROP DOWN



= DIAMETER



= FLANGE HEAD



= STANDARD HINGE



= LENGTH



= FLAT HEAD



= KIMANA HINGE



= HEIGHT



= TRILOBULAR SCREW



= FLAP HINGE



= RIGHT VERSION



= SELF-TAPPING SCREW



= WITH SPRING



= LEFT VERSION



= EURO THREAD



= WITHOUT SPRING



= SETTING CODE



= METRIC THREAD



= REVERSED SPRING



= PCS. PER PAD



= PRE-INSERTED SCREW



= PRE-INSERTED SCREW AND SPREADING BUSH



= CUT ON REQUEST



= WITH FLANGE



= SELF ADHESIVE

NOTE: Printing errors and omissions may exist despite our best efforts to ensure accuracy. We reserve the right to alter specifications without notice.

MATERIALS

ZA = Zinc Alloy

ST = Steel

HSS = High Speed Steel

BR = Brass

ABS = Acrylonitrile Butadiene Styrene

ZAnk = Nickel-plated Zinc Alloy

STzk = Zinc-plated Steel

AL = Aluminium

WD = Wood

EVA = Ethylene Vinyl Acetate

EP = **ENGINEERING PLASTIC**

+ **EP** = other engineering plastic available on request

SR = **SOFT RUBBER**

+ **SR** = other soft rubber available on request

EPn = Natural Engineering Plastic

EPc = Clear Engineering Plastic

SRn = Natural Soft Rubber

EPw = White Engineering Plastic

EPg = Grey Engineering Plastic

SRw = White Soft Rubber

EPwg = Water Green Engineering Plastic

EPa = Anthracite Engineering Plastic

SRb = Black Soft Rubber



FINISHES



+ **OTHER FINISHES AVAILABLE ON REQUEST**

PART NO.	FINISHES	PART NO.	FINISHES	PART NO.	FINISHES
00	Insignificant finish	IF	Middle Grey	RO	Red
AA	Natural	IJ	Light Grey	UT	T-Met 9007
AB	White	IL	Grey 20	UZ	T-Met
AE	White 9010	IN	Grey met. 26	WA	Bronzed
EA	Black	JB	Bright Aluminium	WI	Burnished
EC	Matt Black	JC	Aluminium - Chrome	XD	Satin-finished Steel
EE	Anthracite	JD	Matt Aluminium	YA	Nickel-plated
EW	Grey 9007	JE	Satin-finished Aluminium	YB	Bright Nickel-plated
FU	Gunmetal	JF	Aluminium - Brass	YC	Matt Nickel-plated
FV	Gunmetal V52	JG	Aluminium 5	YD	Satin-finished Nickel-plated
GR	Raw	JL	Aluminium PE 11	YQ	Black Nickel
HA	Brass-Plated	JM	Aluminium RAL 9006	Z9	Black Zinc
HH	Tropicalized	KA	Chrome	ZA	Zinc alloy
HL	Raw Brass	KB	Bright Chrome	ZN	Zinc-plated
HX	Graphite	KC	Matt Chrome	ZQ	Bright Gold
IA	Grey	LD	Brown 8019	ZY	Titanium
IB	Metallic Grey	NN	Metallic Beige	ZZ	Clear

Table of contents

KIMANA	11.1
KIMANA ADAPTERS	11.5
DOOR ALIGNMENT SPACER FOR KIMANA HINGES	11.7
KIMANA SKIN	11.14
KIMANA SKIN ADAPTER	11.18
DOOR ALIGNMENT SPACER FOR KIMANA SKIN HINGES	11.20



KIMANA



GOOD DESIGN AWARD, 2012

PAT. PENDING
REGISTERED DESIGN
Certificates available on request. 

INSTALLATION ON UNIT WITH SOLID DOOR (Application shown for minimum thickness 18 mm)

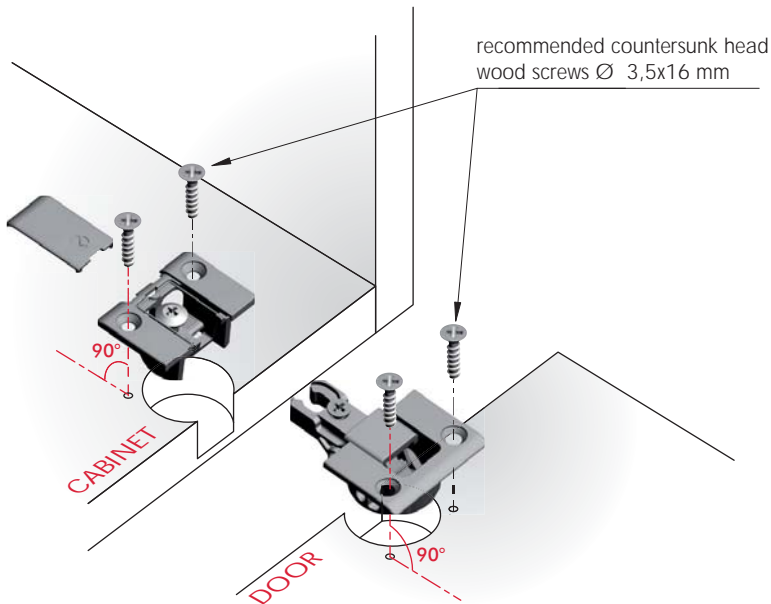

INSTALLATION ON UNIT WITH ALUMINIUM DOOR (Application shown for minimum thickness 18 mm)

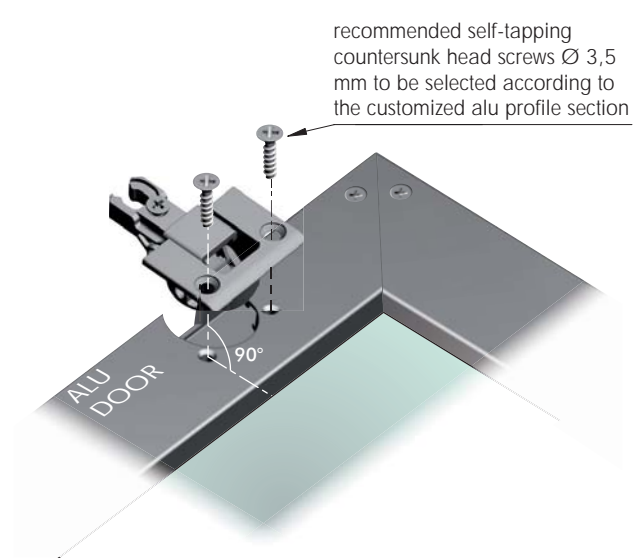

CASES WHERE TO USE KIMANA

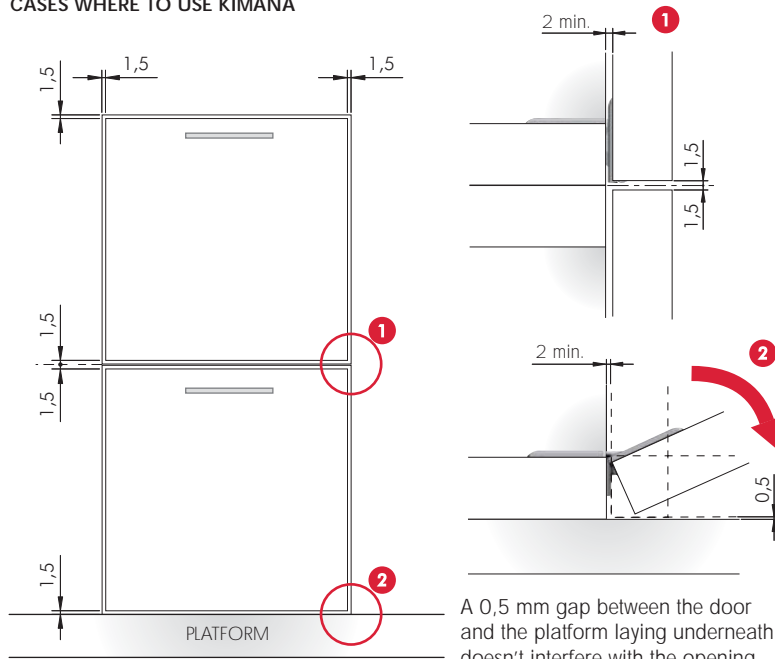

RECOMMENDED NUMBER OF KIMANA PER DOOR

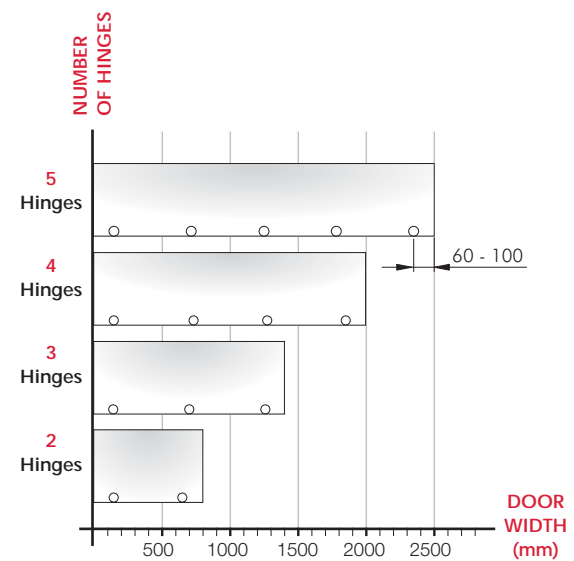

Due to various factors, the quantities stated in the chart are indicative.



HINGES

DOOR INSTALLATION

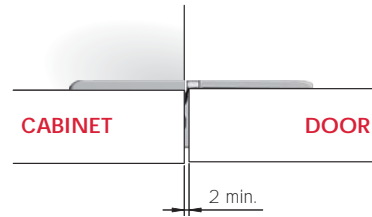
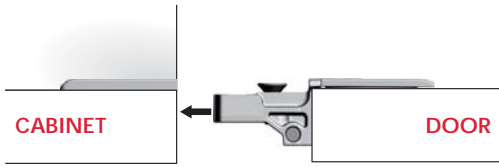

IN-DEPTH ADJUSTMENT 0+2 mm

⚠ TO BE MADE BEFORE LOCKING SCREW OPERATION ⚠

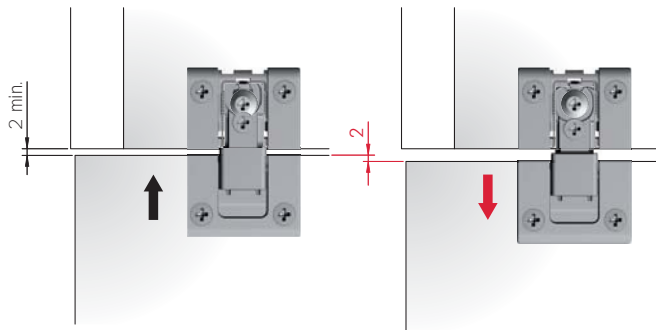

LATERAL ADJUSTMENT 0±1 mm

⚠ TO BE MADE BEFORE LOCKING SCREW OPERATION ⚠

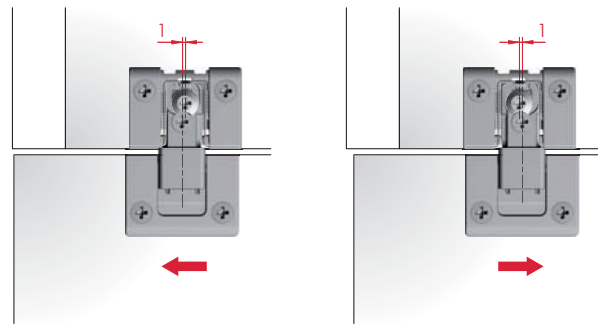

VERTICAL ADJUSTMENT 0+2 mm - DOOR OPEN

⚠ TO BE MADE BEFORE LOCKING SCREW OPERATION ⚠

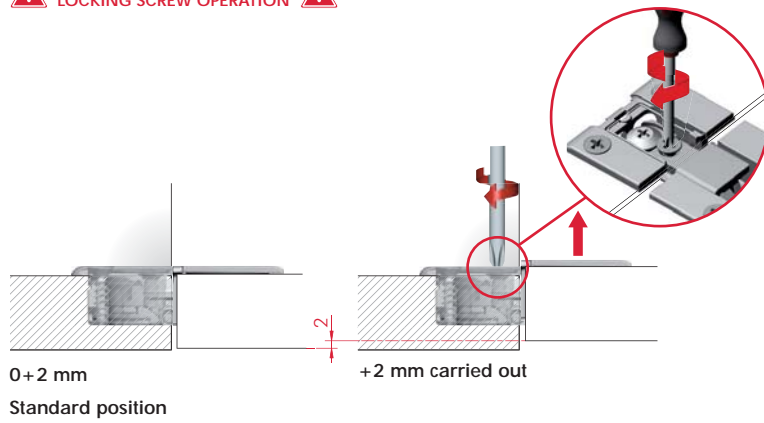

VERTICAL ADJUSTMENT 0+2 mm - DOOR CLOSED

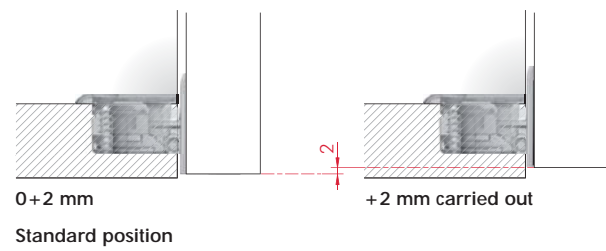

LOCKING SCREW

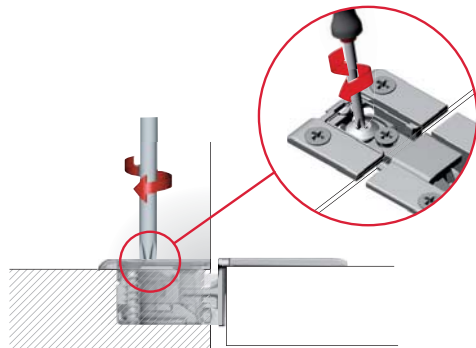

COVER CAP INSERTION

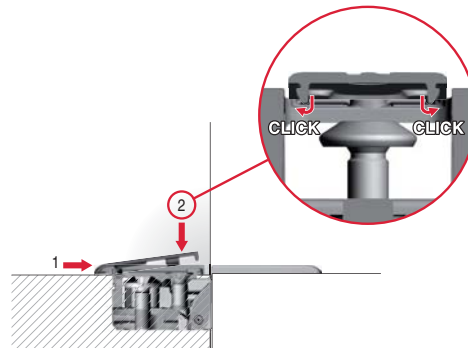

COVER CAP REMOVAL

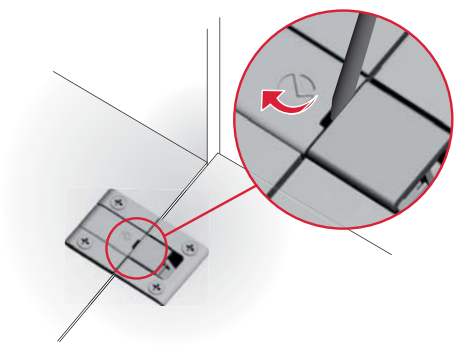

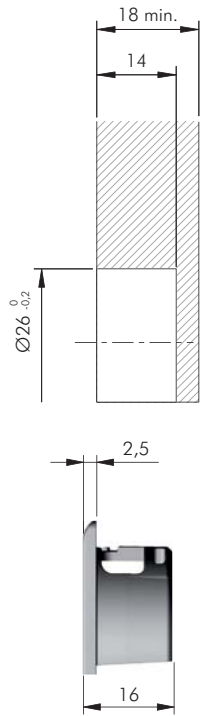

NOTE: For panel thickness lower than 18 mm, refer to "KIMANA ADAPTERS".

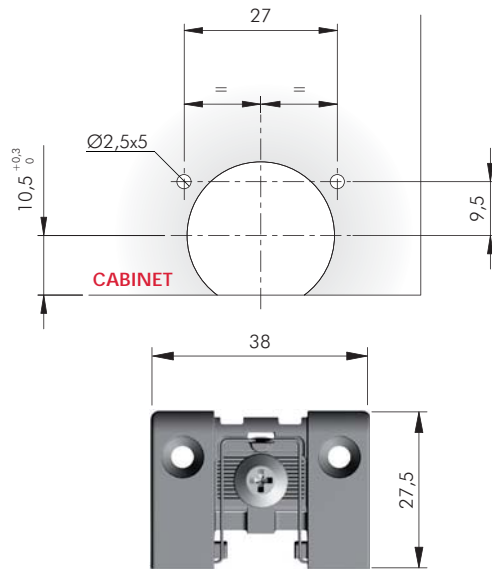

	ZA ST	= 150 pcs.
40120000YA		
40120000HX		
40120000YQ		

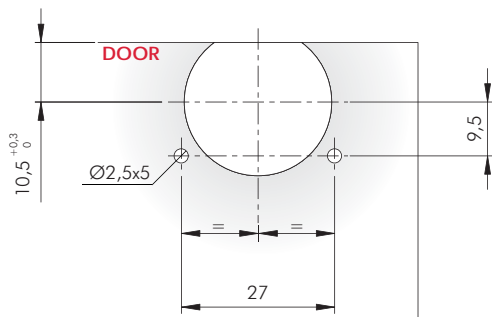
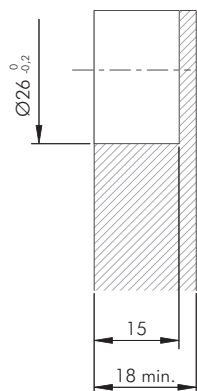
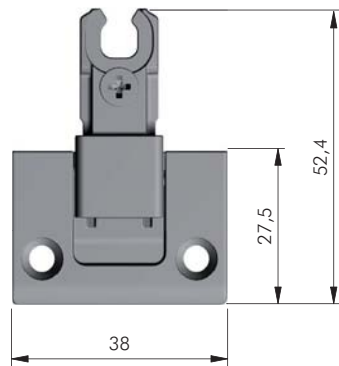

NOTE: For panel thickness lower than 18 mm, refer to "KIMANA ADAPTERS".

	ZA ST	= 150 pcs.
40120010YA		
40120010HX		
40120010YQ		

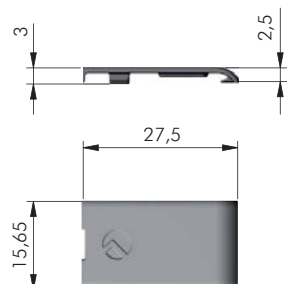

ZA	= 150 pcs.
40120040YA	
40120040HX	
40120040YQ	



STANDARD CONDITION

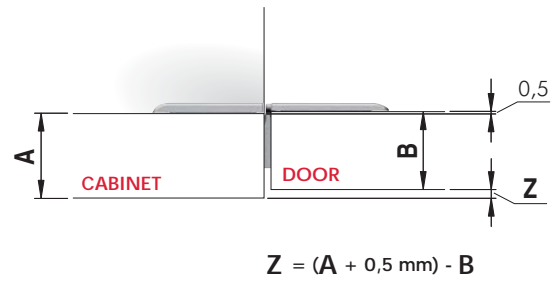
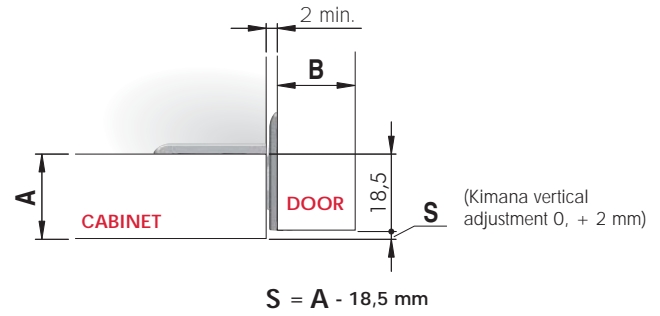
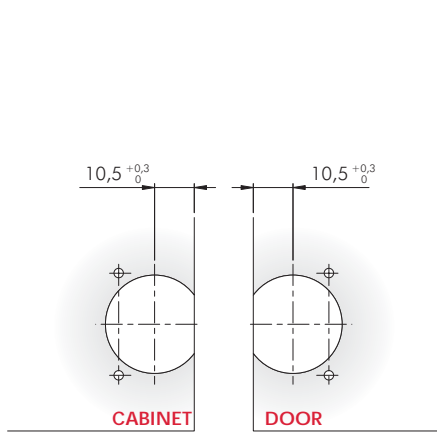

SPECIAL DRILLING PLAN TO MANAGE OVERLAY AND GAP BETWEEN DOOR AND CABINET

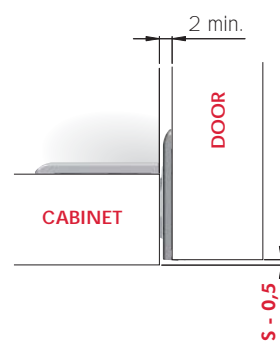
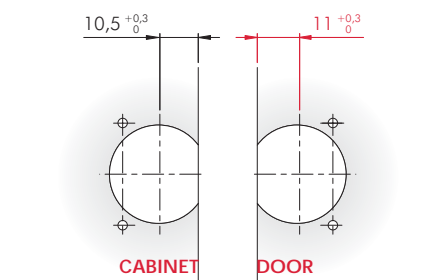
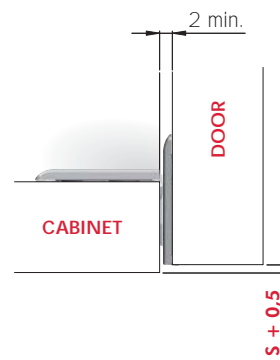
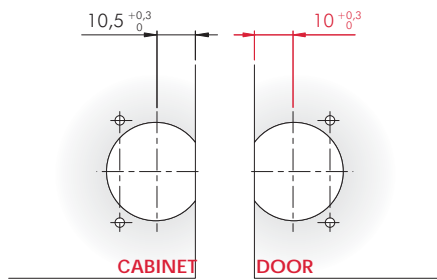
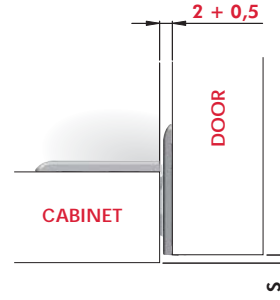
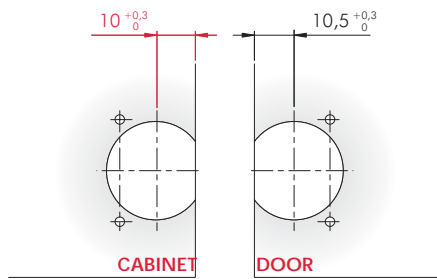



KIMANA ADAPTERS

INSTALLATION WITH ADAPTER

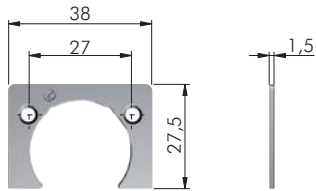
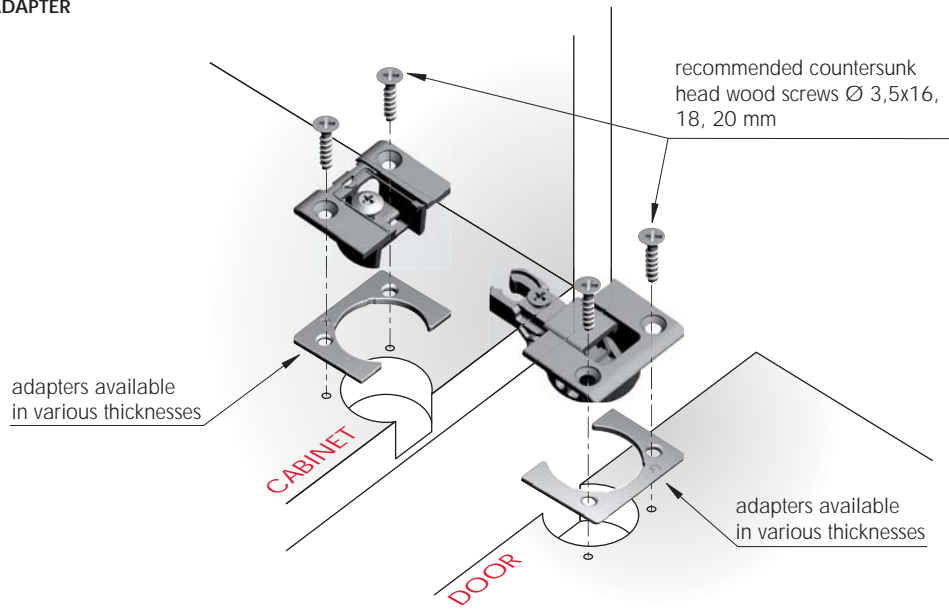

ZA	= on request
123	
40115320YA	

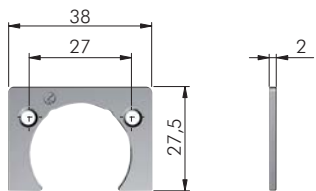

ZA	= on request
123	
40115340YA	
40115340HX	
40115340YQ	

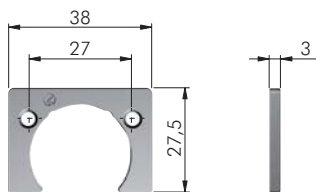

ZA	= on request
123	
40115360YA	

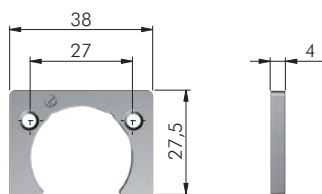

ZA	= on request
123	
40115400YA	

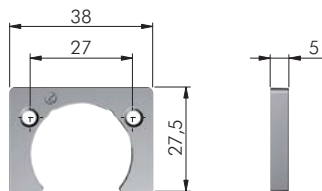

ZA	= on request
123	
40115440YA	

FIXING ACCESSORY FOR BOTH KIMANA AND ADAPTERS PART NO. 40115320

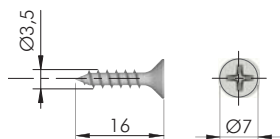

= Ø 2,5 mm	
= PZ2	
ST	= 10.000 pcs.
123	
60101390YA	
60101390HX	
60101390Z9	

FIXING ACCESSORY FOR KIMANA ADAPTERS PART NO. 40115340 - 40115360

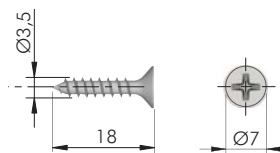

= Ø 2,5 mm	
= PZ2	
ST	= 10.000 pcs.
123	
60101400YA	
60101400HX	
60101400Z9	



FIXING ACCESSORY FOR KIMANA ADAPTER PART NO. 40115400 - 40115440

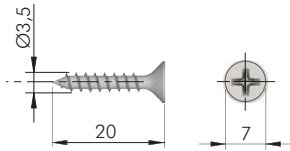

= Ø 2,5 mm +

= PZ2

= 10.000 pcs.

60101410YA

DOOR ALIGNMENT SPACER FOR KIMANA HINGES

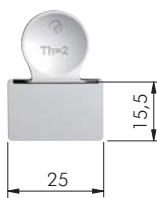
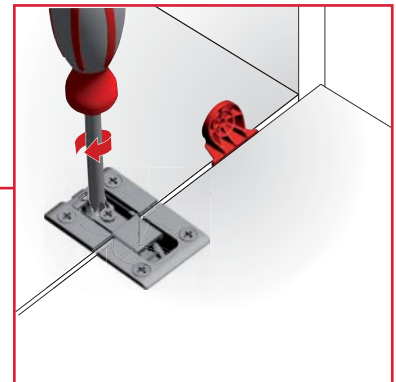
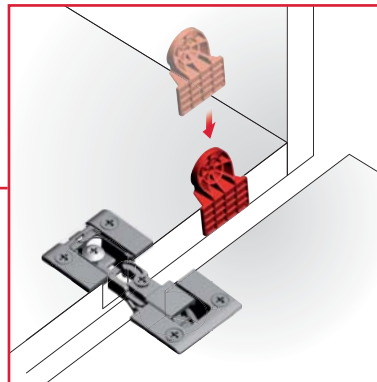
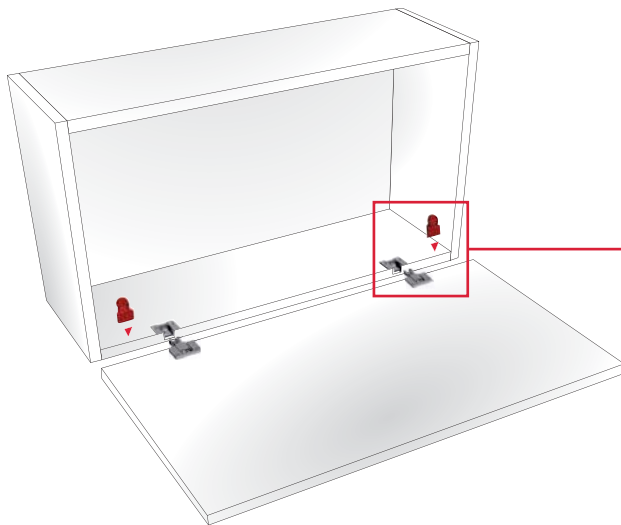

= on request

40115630RO



2 pcs featured in each polybag.

* For non-standard drilling plans 1,5, 2,5, 3 and 4 mm spacers are also available.

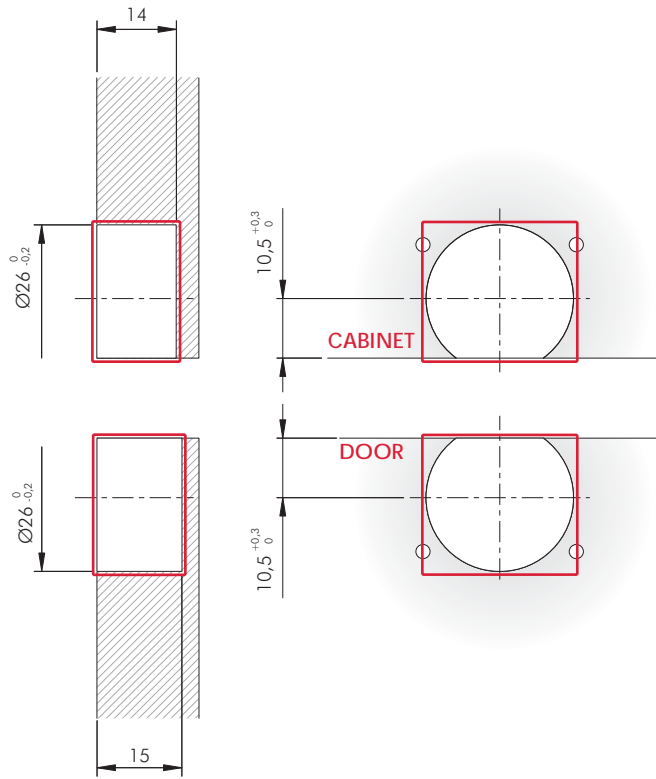

DRILL BIT FOR KIMANA



HSS	 = on request
 123	
6270101000	

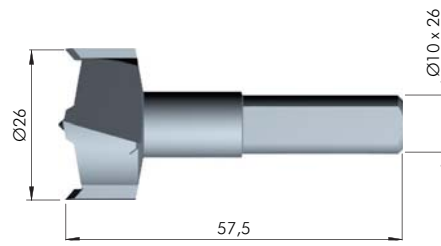

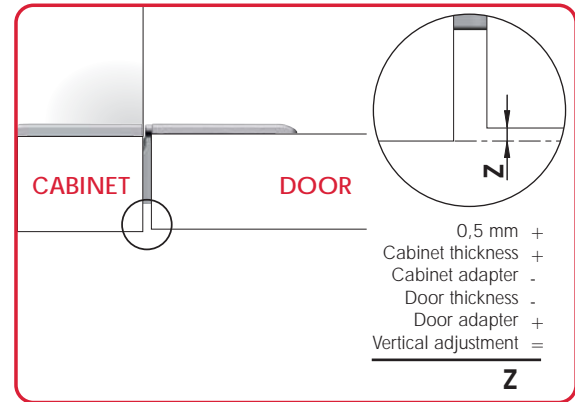
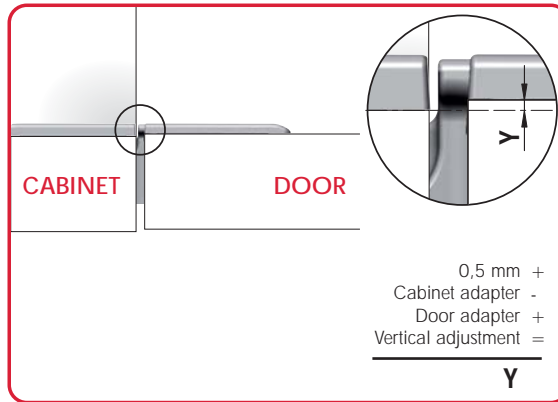
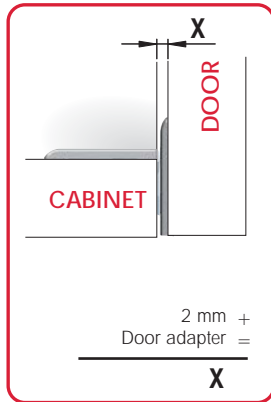

CABINET 16 mm WITH ADAPTER 4 mm THICK - DOOR 16 mm WITH ADAPTER 2 mm THICK

0 + 2 mm FURTHER VERTICAL ADJUSTMENT

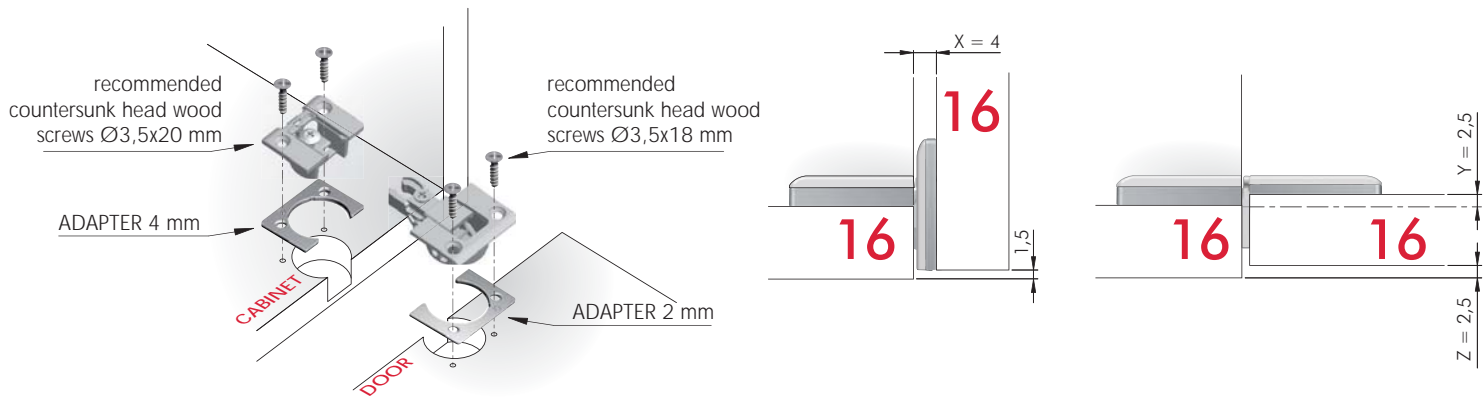

CABINET 16 mm WITH ADAPTER 4 mm THICK - DOOR 19 mm WITHOUT ADAPTER

0 + 2 mm FURTHER VERTICAL ADJUSTMENT

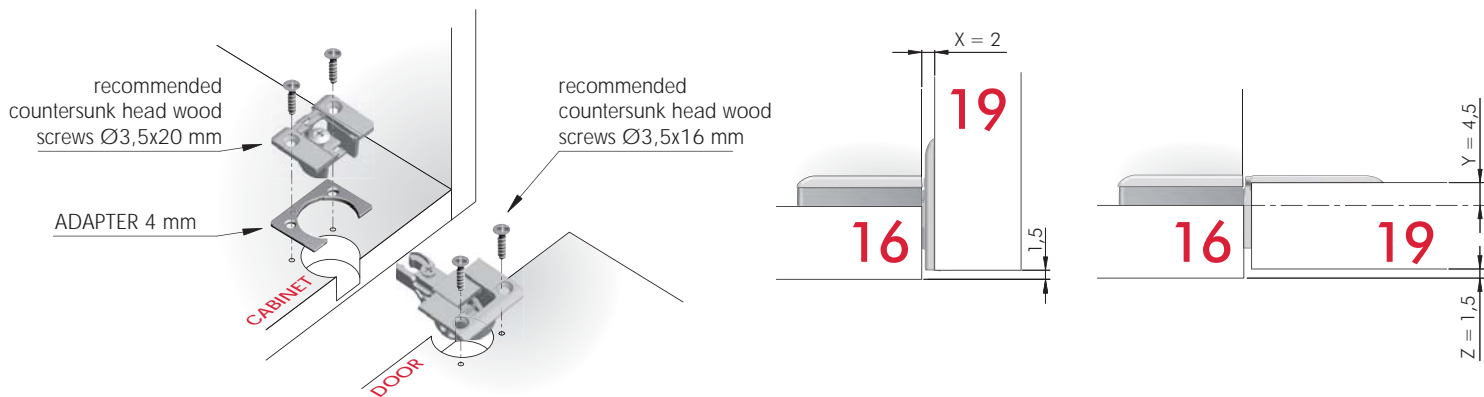

CABINET 16 mm WITH ADAPTER 4 mm THICK - DOOR 20 mm WITHOUT ADAPTER

0 + 2 mm FURTHER VERTICAL ADJUSTMENT

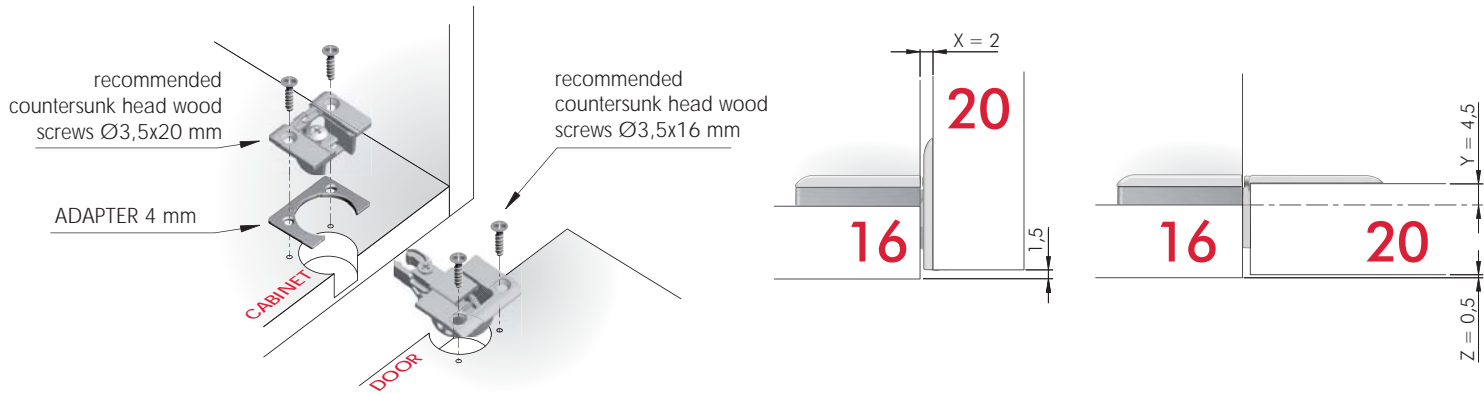

CABINET 18 mm WITH ADAPTER 2 mm THICK - DOOR 18 mm WITHOUT ADAPTER

0 + 2 mm FURTHER VERTICAL ADJUSTMENT

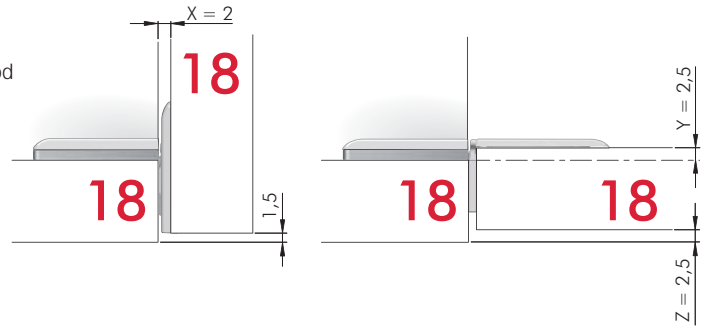
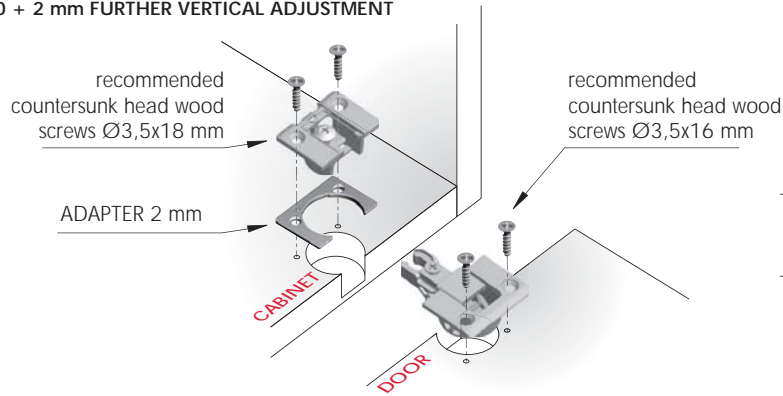

CABINET 18 mm WITHOUT ADAPTER - DOOR 18 mm WITHOUT ADAPTER



WITH VERTICAL ADJUSTMENT + 2 mm CARRIED OUT

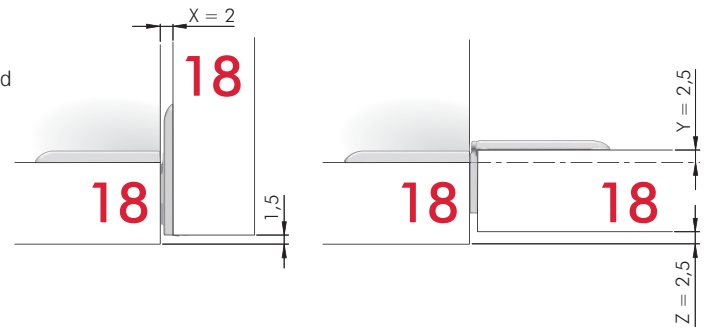
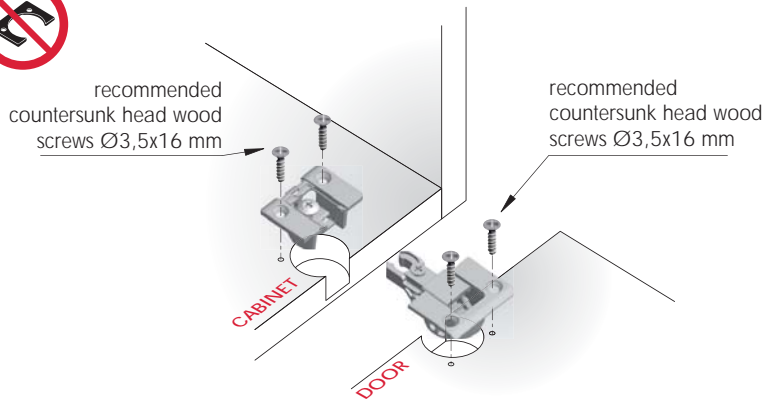

CABINET 18 mm WITH ADAPTER 2 mm THICK - DOOR 19 mm WITHOUT ADAPTER

0 + 2 mm FURTHER VERTICAL ADJUSTMENT

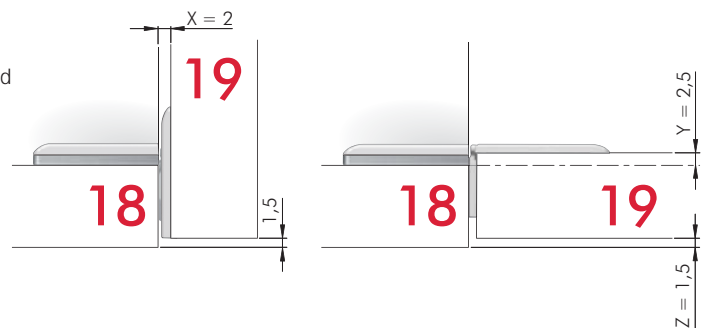
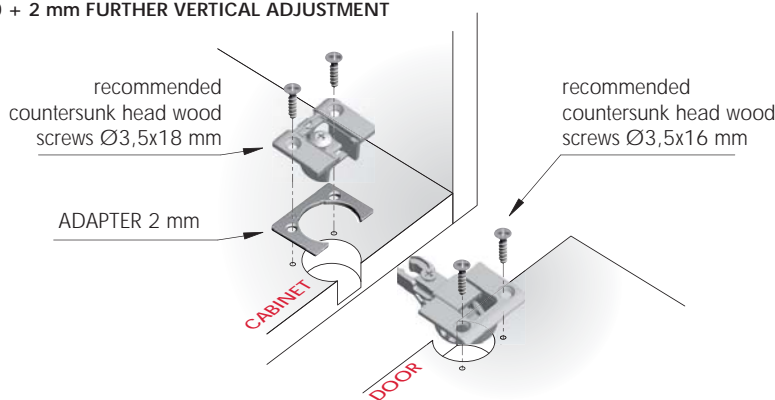

CABINET 18 mm WITHOUT ADAPTER - DOOR 19 mm WITHOUT ADAPTER



WITH VERTICAL ADJUSTMENT + 2 mm CARRIED OUT

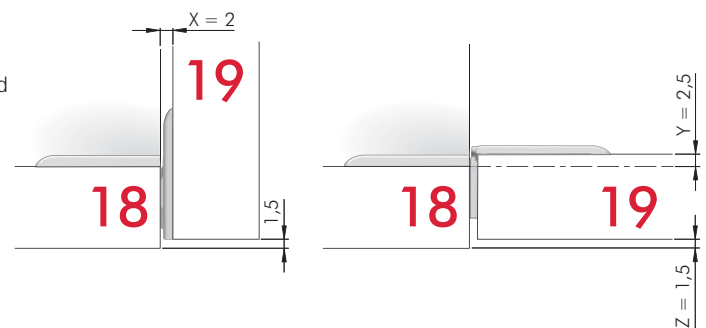
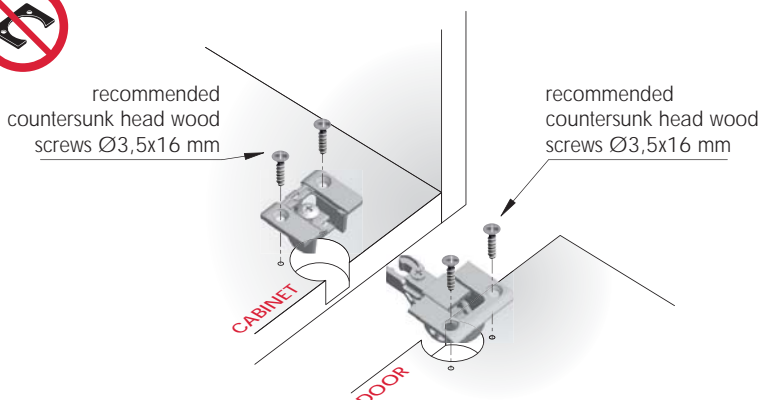



CABINET 18 mm WITH ADAPTER 2 mm THICK - DOOR 20 mm WITHOUT ADAPTER

0 + 2 mm FURTHER VERTICAL ADJUSTMENT

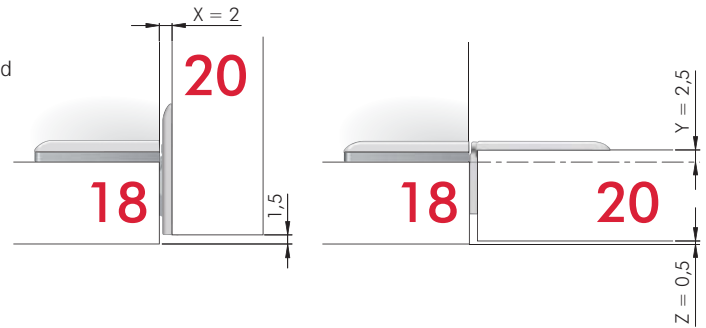
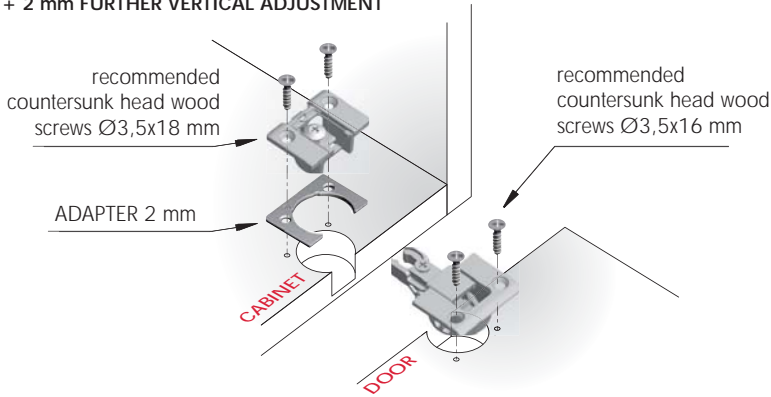

CABINET 18 mm WITHOUT ADAPTER - DOOR 20 mm WITHOUT ADAPTER



WITH VERTICAL ADJUSTMENT + 2 mm CARRIED OUT

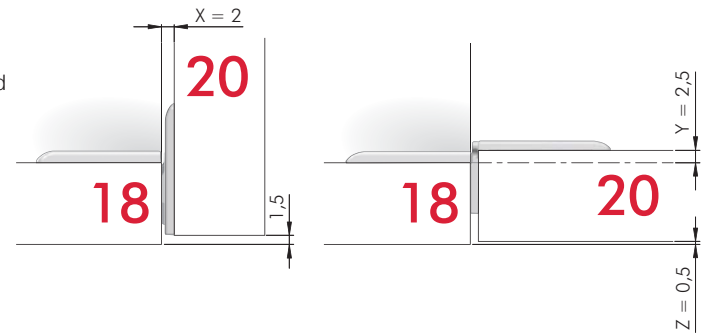
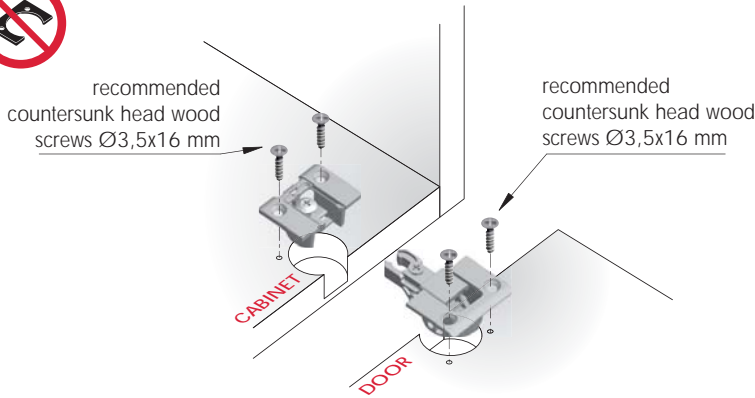

CABINET 19 mm WITHOUT ADAPTER - DOOR 16 mm WITH ADAPTER 2 mm THICK

0 + 2 mm FURTHER VERTICAL ADJUSTMENT

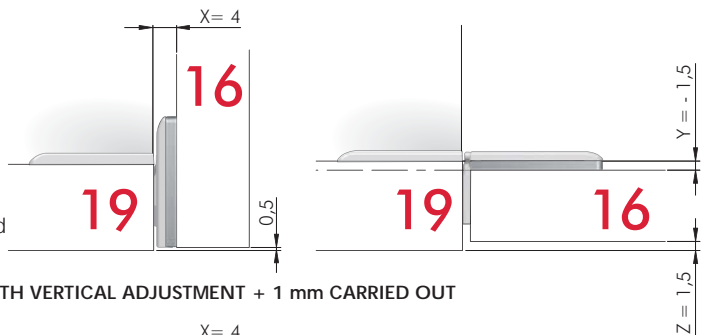
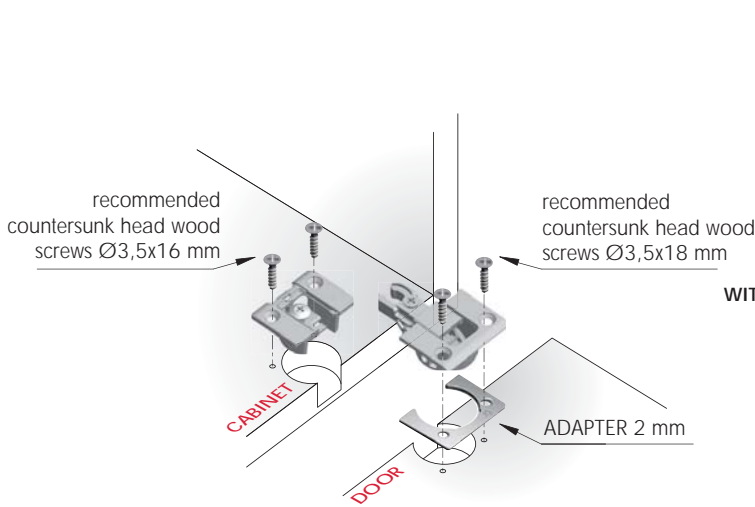

WITH VERTICAL ADJUSTMENT + 1 mm CARRIED OUT

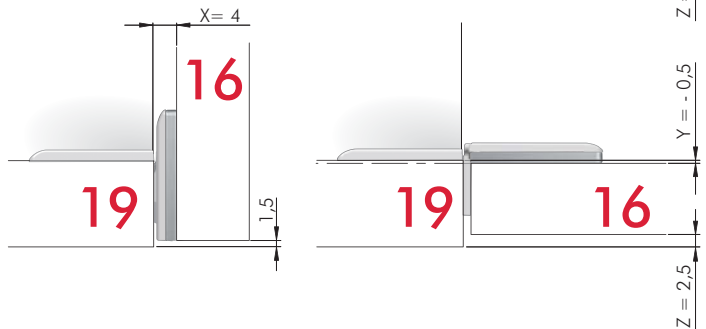

CABINET 19 mm WITHOUT ADAPTER - DOOR 18 mm WITHOUT ADAPTER

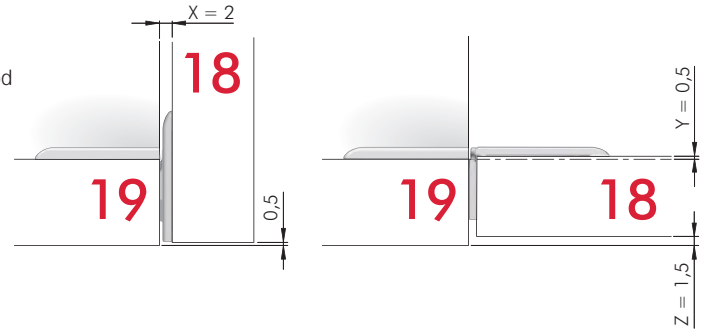
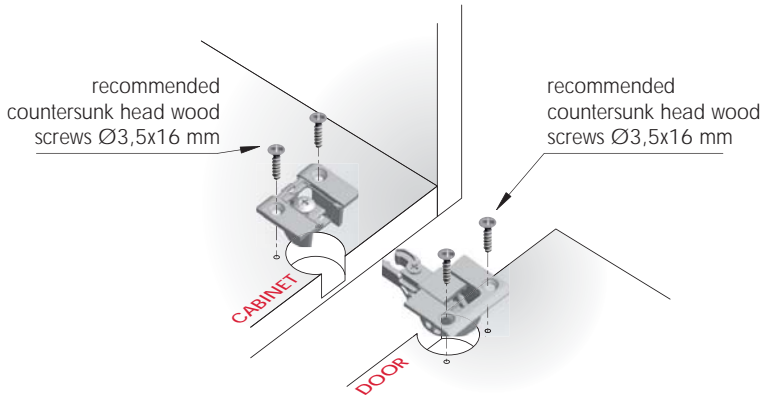

CABINET 19 mm WITHOUT ADAPTER - DOOR 19 mm WITHOUT ADAPTER

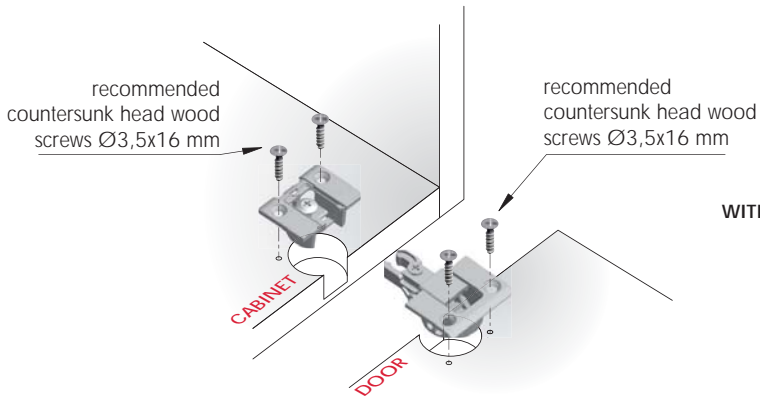

0 + 2 mm FURTHER VERTICAL ADJUSTMENT

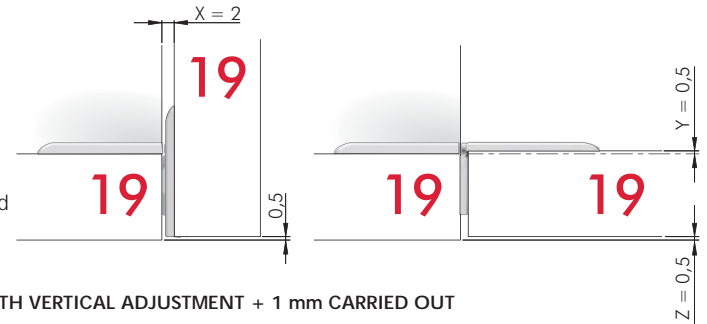

WITH VERTICAL ADJUSTMENT + 1 mm CARRIED OUT

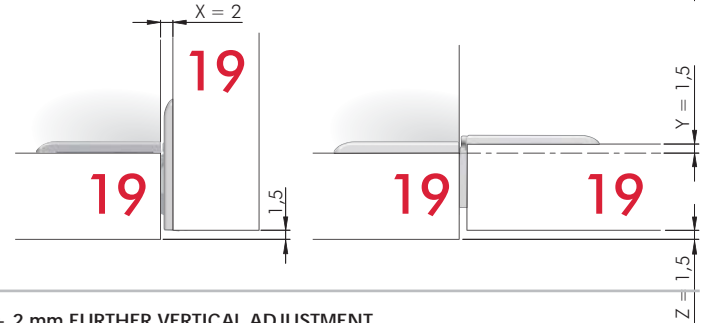

CABINET 19 mm WITHOUT ADAPTER - DOOR 20 mm WITHOUT ADAPTER

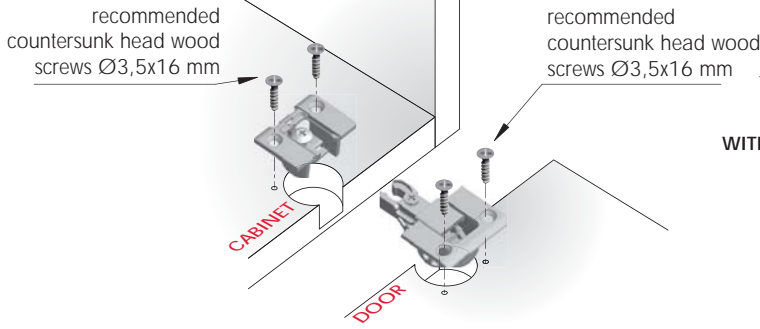

0 + 2 mm FURTHER VERTICAL ADJUSTMENT

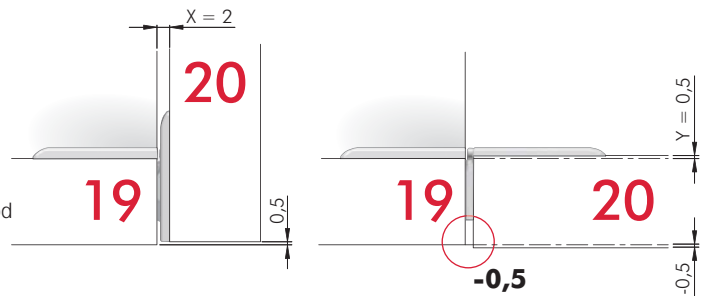

WITH VERTICAL ADJUSTMENT + 1 mm CARRIED OUT

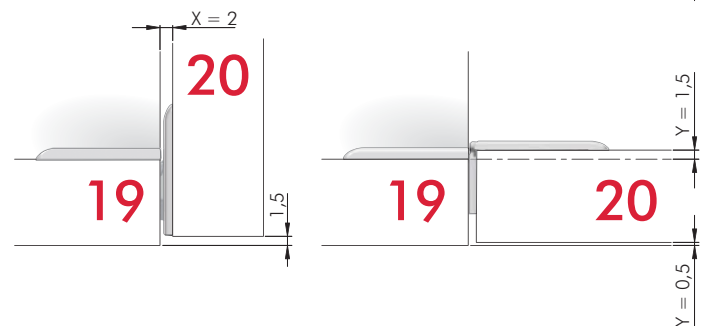



CABINET 20 mm WITHOUT ADAPTER - DOOR 18 mm WITHOUT ADAPTER

0 + 2 mm FURTHER VERTICAL ADJUSTMENT

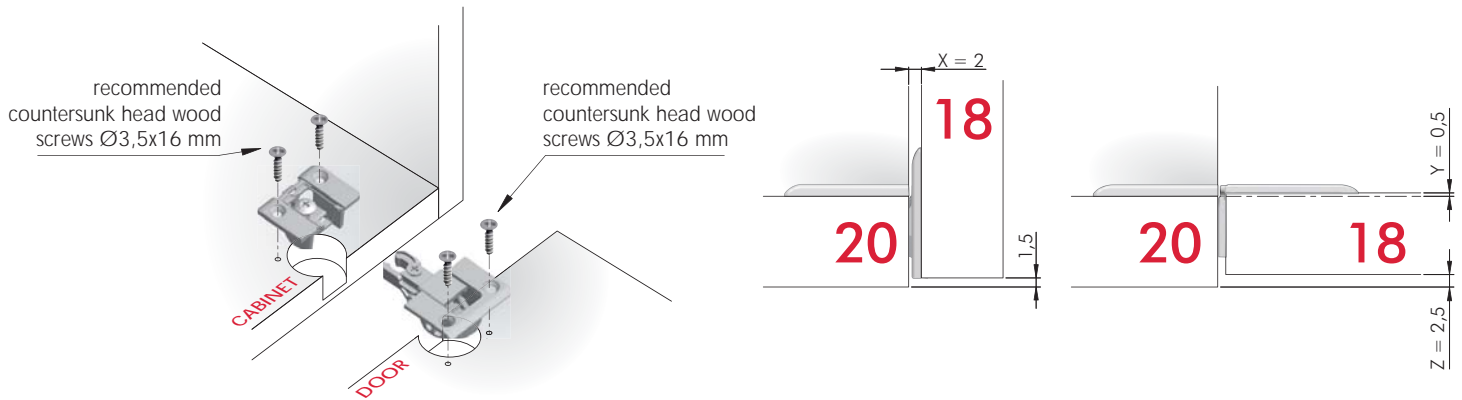

CABINET 20 mm WITHOUT ADAPTER - DOOR 19 mm WITHOUT ADAPTER

0 + 2 mm FURTHER VERTICAL ADJUSTMENT

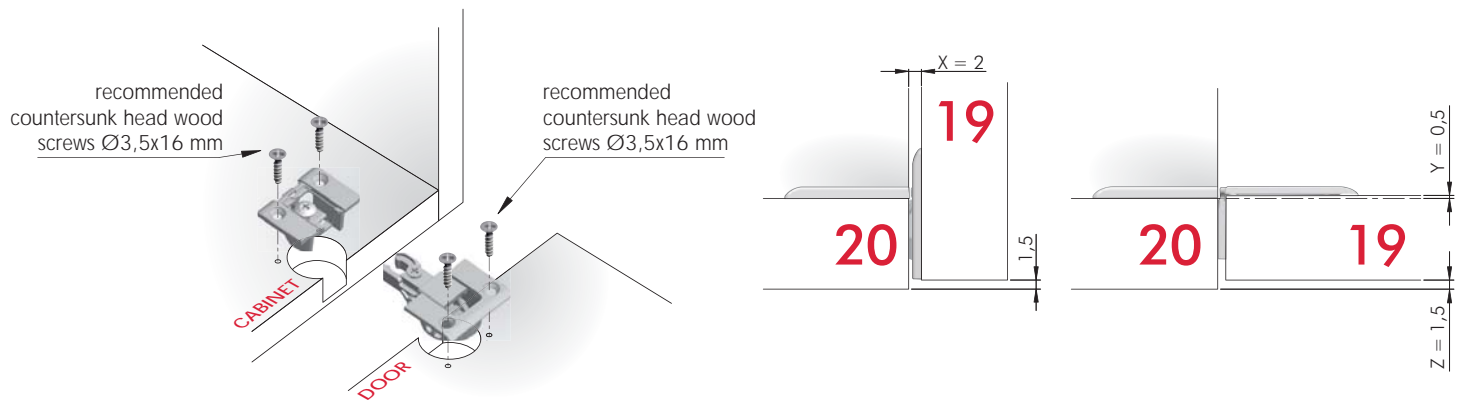

CABINET 20 mm WITHOUT ADAPTER - DOOR 20 mm WITHOUT ADAPTER

0 + 2 mm FURTHER VERTICAL ADJUSTMENT

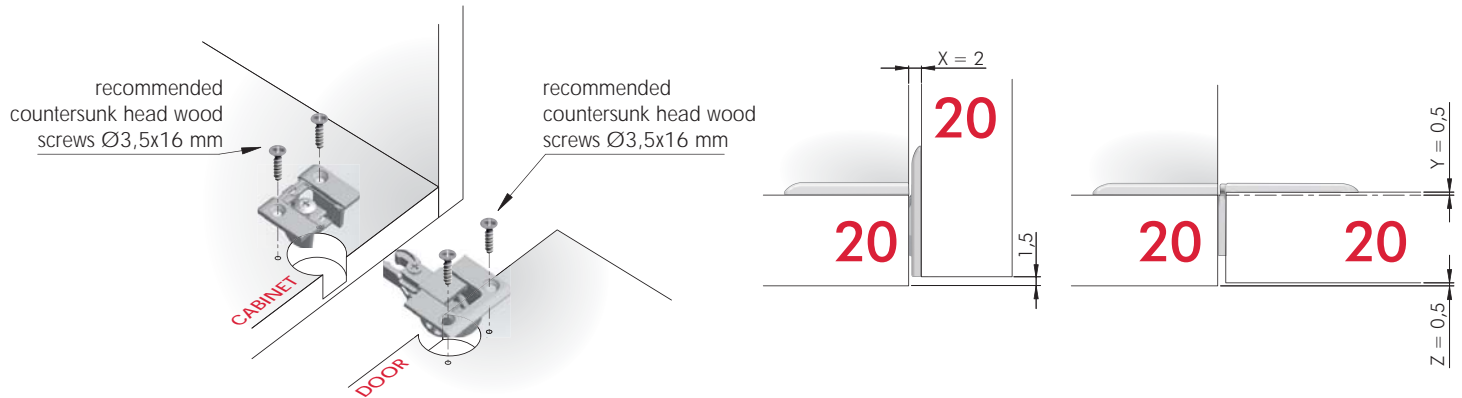



KIMANA SKIN



STANDARD INSTALLATION (Application shown for minimum thickness 18 mm)

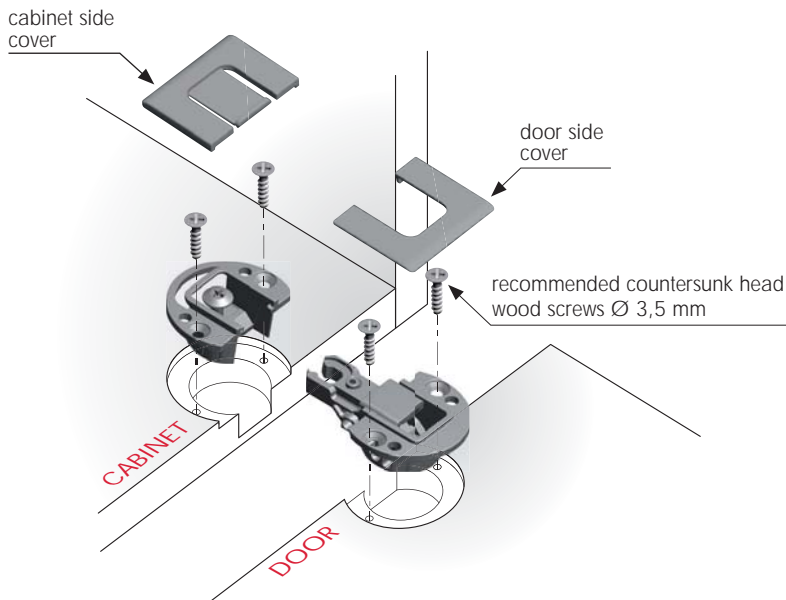

INSTALLATION WITH ADAPTERS

VERY IMPORTANT
If adapters are used it is necessary to apply the bespoke covers.

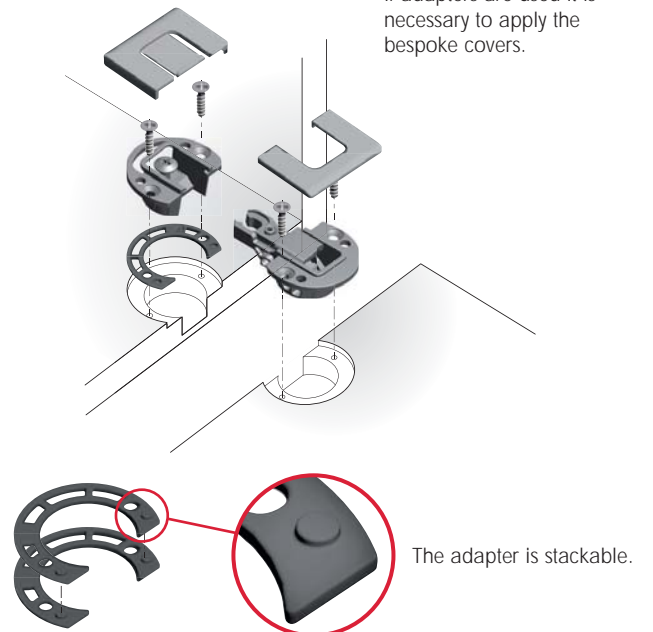

OVERLAY WITH STANDARD DRILLING PLAN

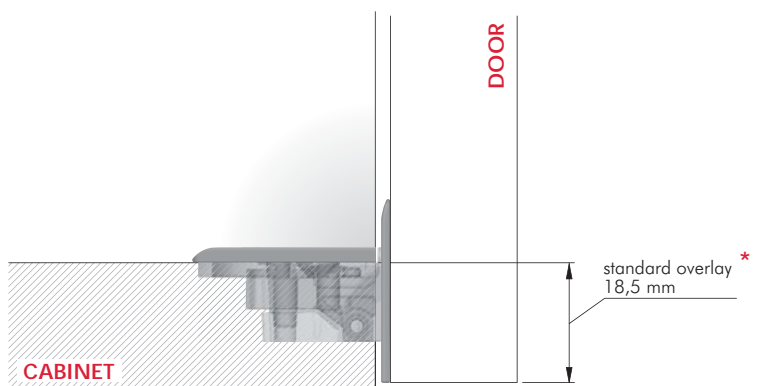

* this dimension can be changed by modifying the drilling plane or by using the spacers.

RECOMMENDED NUMBER OF KIMANA SKIN PER DOOR

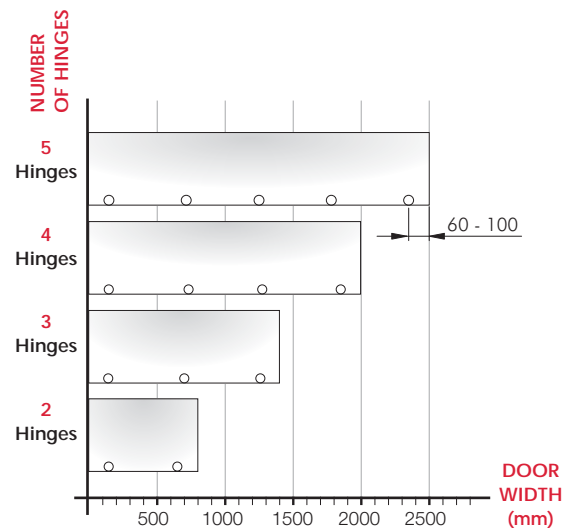

Due to various factors, the quantities stated in the chart are indicative.

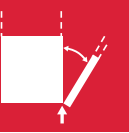

DOOR INSTALLATION

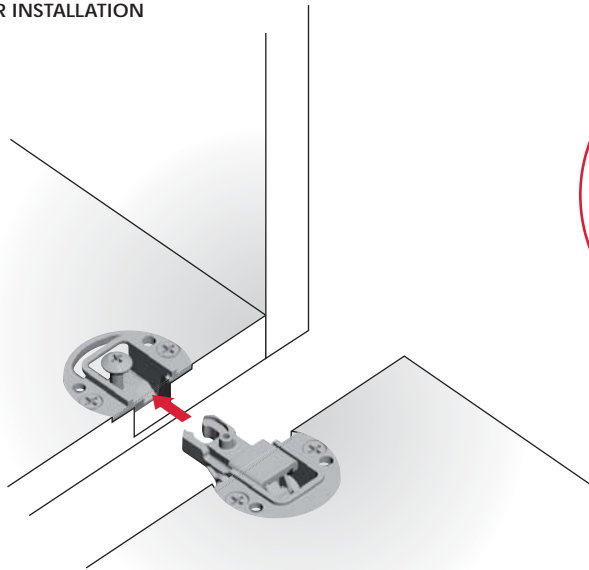

LOCKING SCREW

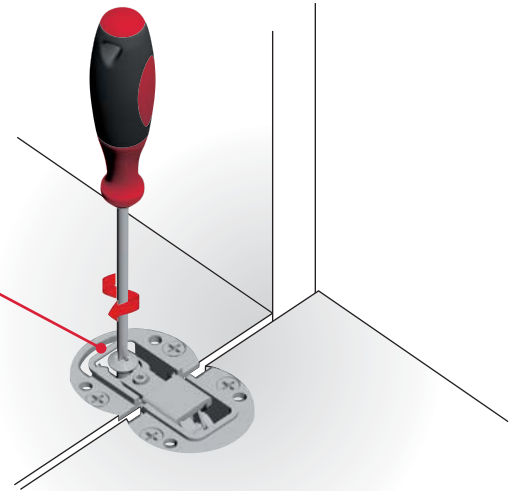
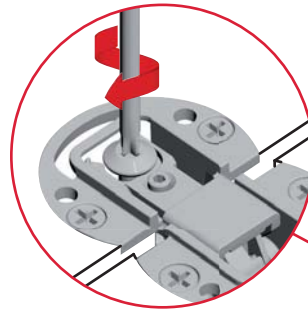

ADJUSTMENTS AND ASSEMBLING

IN-DEPTH ADJUSTMENT 0 ± 2 mm

⚠ TO BE MADE BEFORE LOCKING SCREW OPERATION ⚠

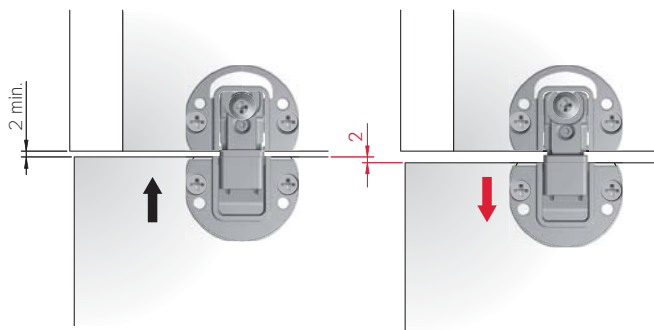

LATERAL ADJUSTMENT 0 ± 1 mm

⚠ TO BE MADE BEFORE LOCKING SCREW OPERATION ⚠

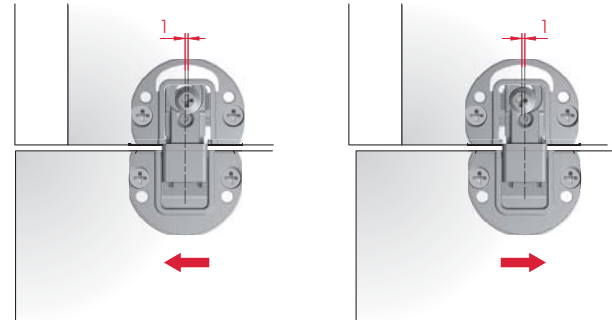

OVERLAP ADJUSTMENT

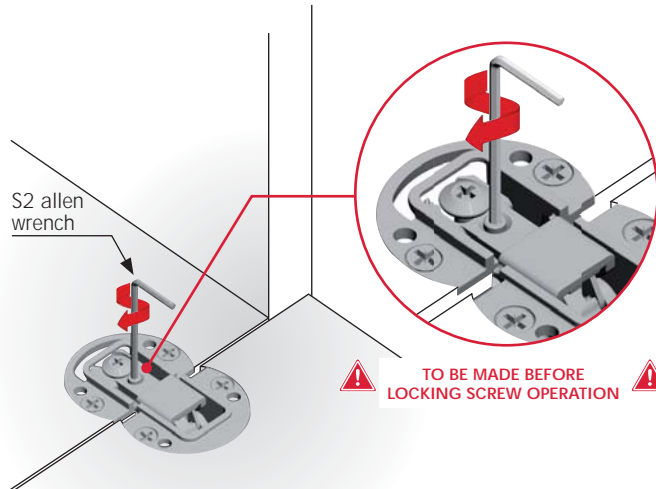

+2 mm vertical adjustment

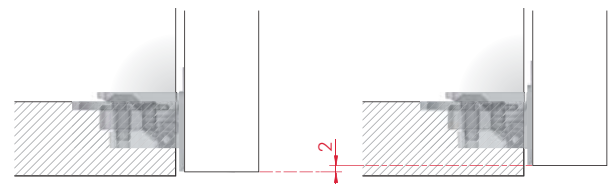

COVERS ASSEMBLING

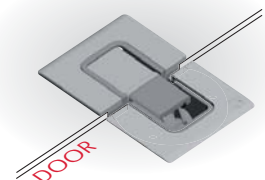
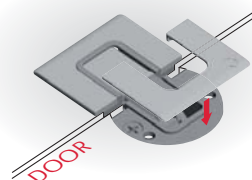
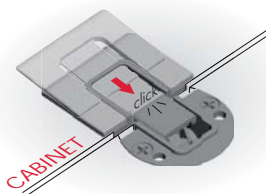
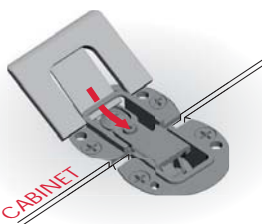

[Back to table of contents](#)



HINGES

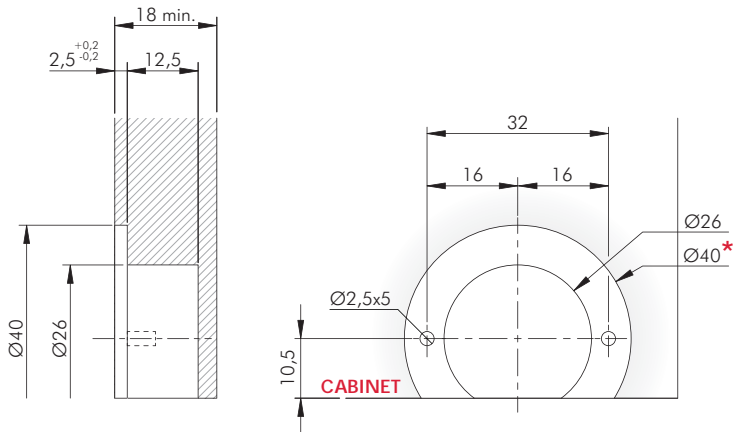

ZA	ST	= 200 pcs.
40130000YA		
40130000YQ		

* Ø40 not necessary under certain conditions, for further information refer to section "SPECIAL DRILLING PLANS" on page 11.18.

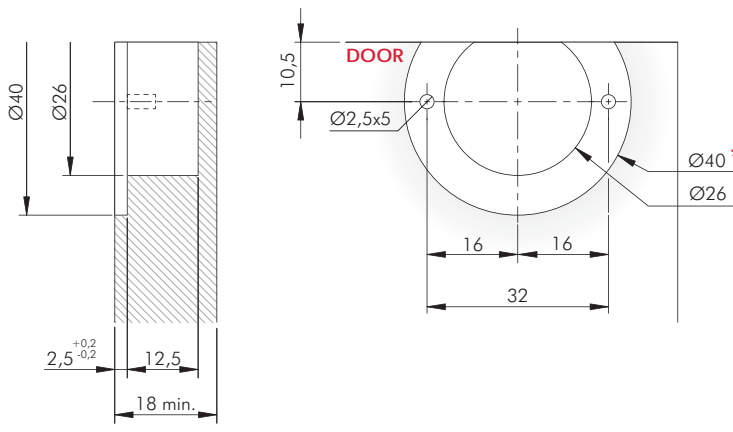

ZA	ST	= 200 pcs.
40130010YA		
40130010YQ		



* Ø40 not necessary under certain conditions, for further information refer to section "DRILLING PLANS" on page 11.18.



CABINET SIDE COVER

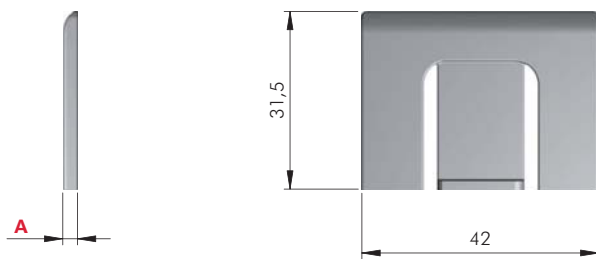
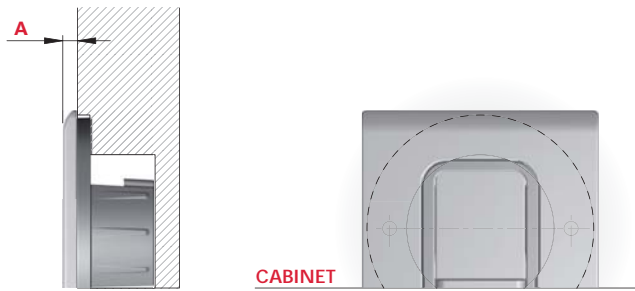

EP		= 200 pcs.		
			H	A
40130400EE	EW	0	2,5	
40130420EE	EW	1	3,5	
40130440EE	EW	2	4,5	
40130460EE	EW	4	6,5	
40130480EE	EW	6	8,5	

ZA		= 200 pcs.		
			H	A
40150400YA	YQ	0	2,5	

DOOR SIDE COVER

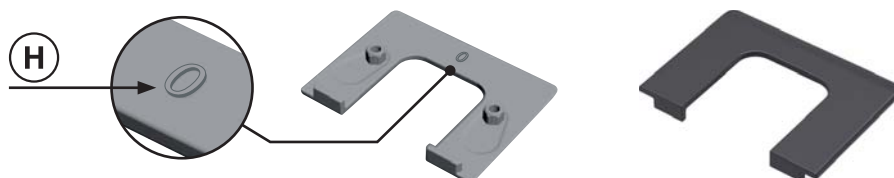
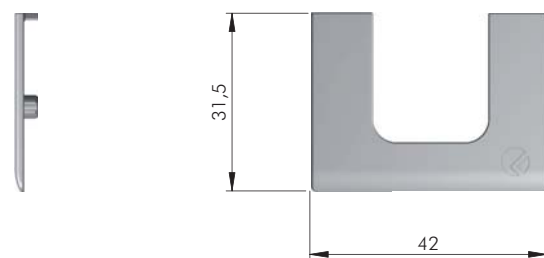
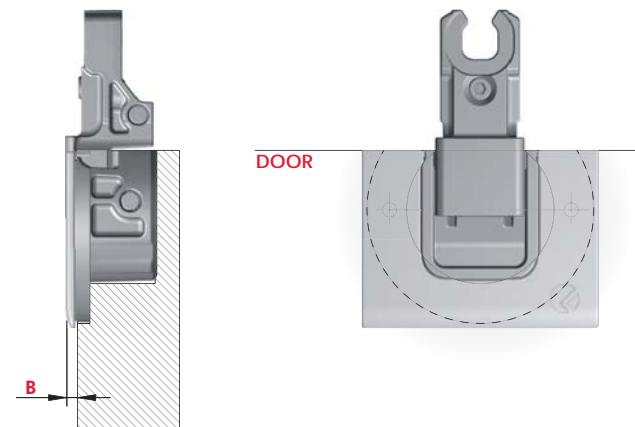

EP		= 200 pcs.		
			H	B
40130200EE	EW	0	1,5	
40130240EE	EW	2	4	

ZA		= 200 pcs.		
			H	B
40150200YA	YQ	0	1,5	

KIMANA SKIN ADAPTER

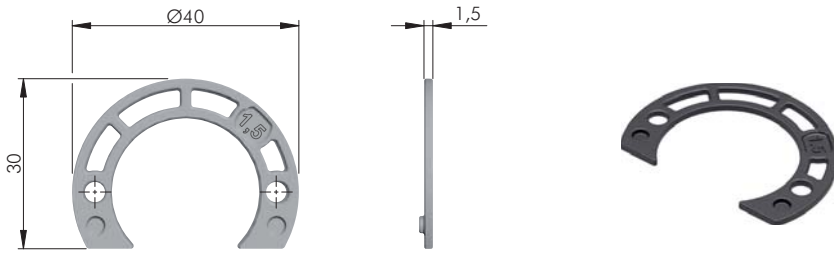

EP = 200 pcs.

40130620EE

FIXING ACCESSORIES

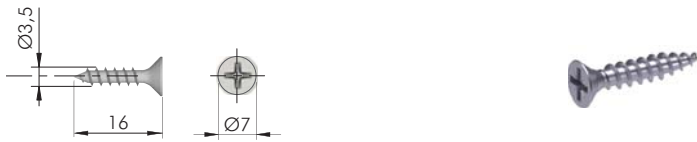

= Ø 2,5 mm +

= PZ2

ST = 10.000 pcs.

60101390ZN



= Ø 2,5 mm +

= PZ2

ST = 8.000 pcs.

60101400ZN



= S2

ST = 2500 pcs.

62501090ZN



DRILL BIT FOR KIMANA SKIN

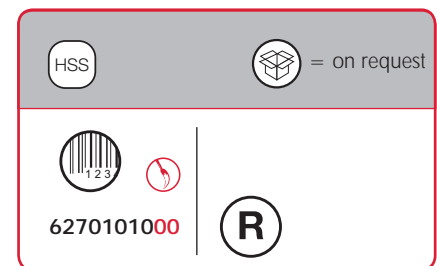
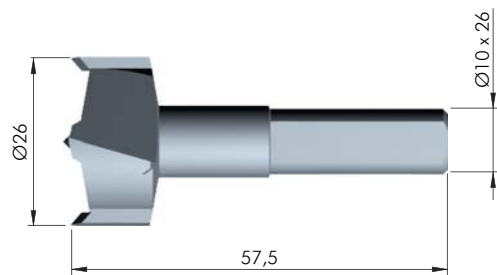
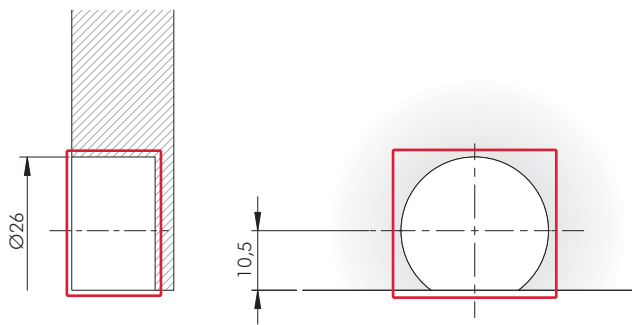
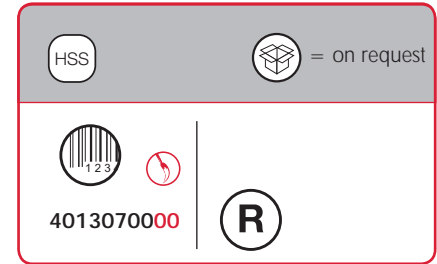
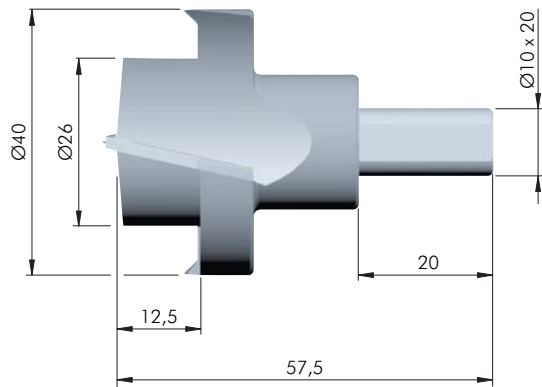
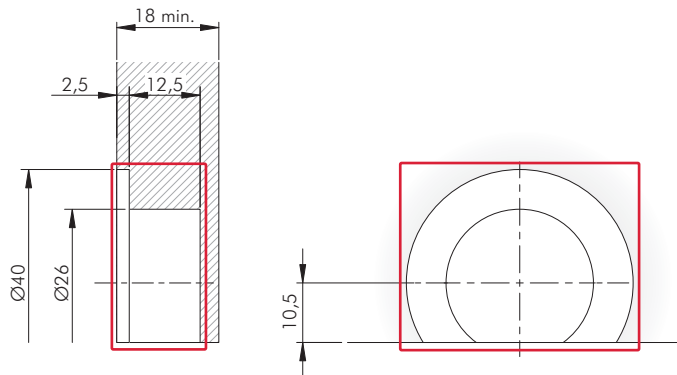



DOOR ALIGNMENT SPACER FOR KIMANA SKIN HINGES

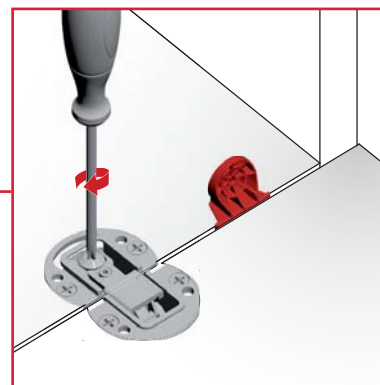
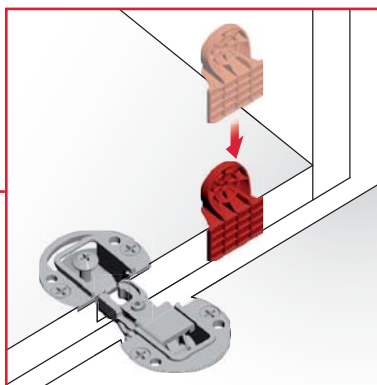
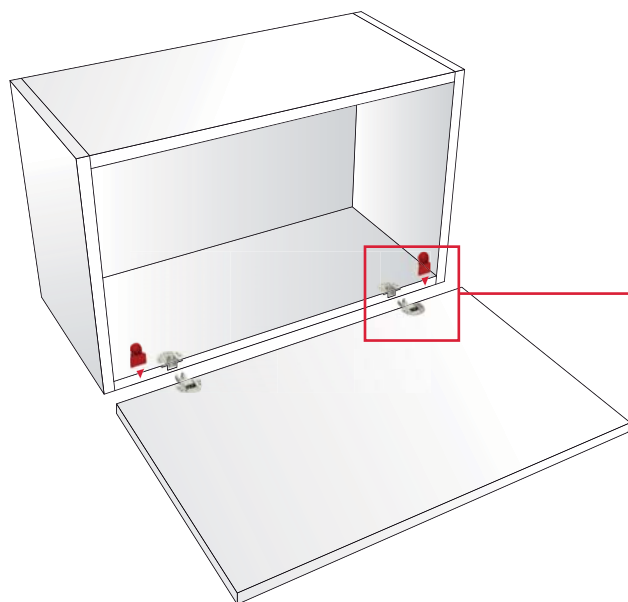

EP	= on request
40115630RO	

2 pcs featured in each polybag.

* For non-standard drilling plans 1,5, 2,5, 3 and 4 mm spacers are also available.



CABINET 16 mm THICK - DOOR 16 mm THICK

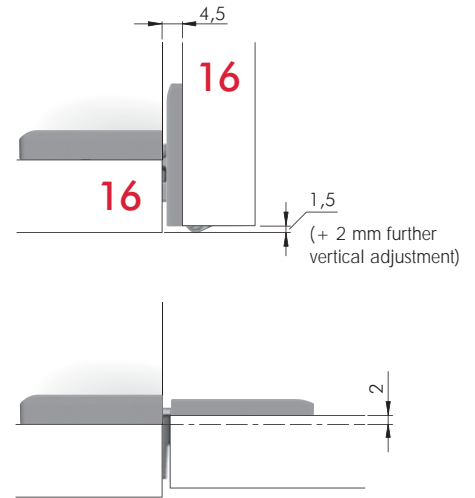
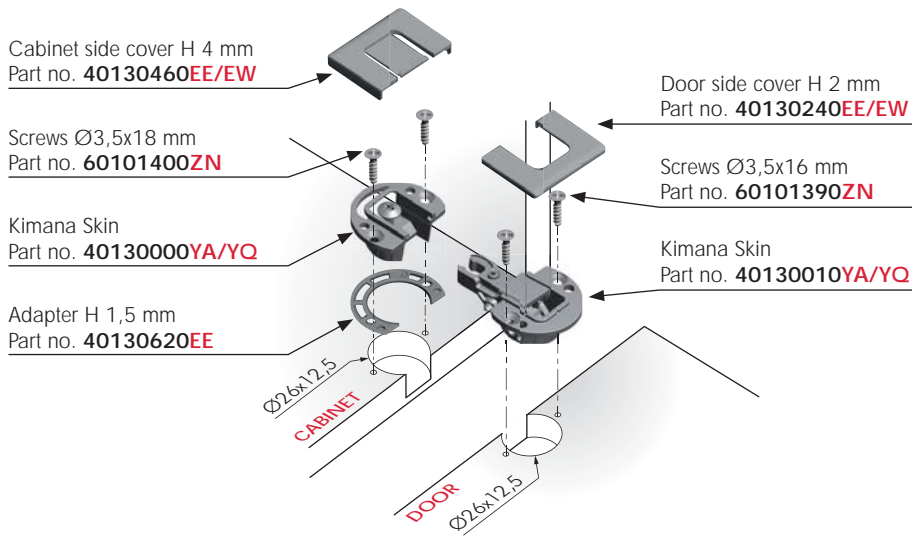

CABINET 16 mm THICK - DOOR 18-19-20 mm THICK

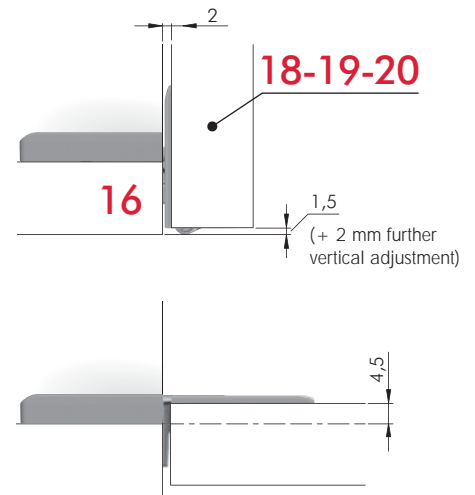
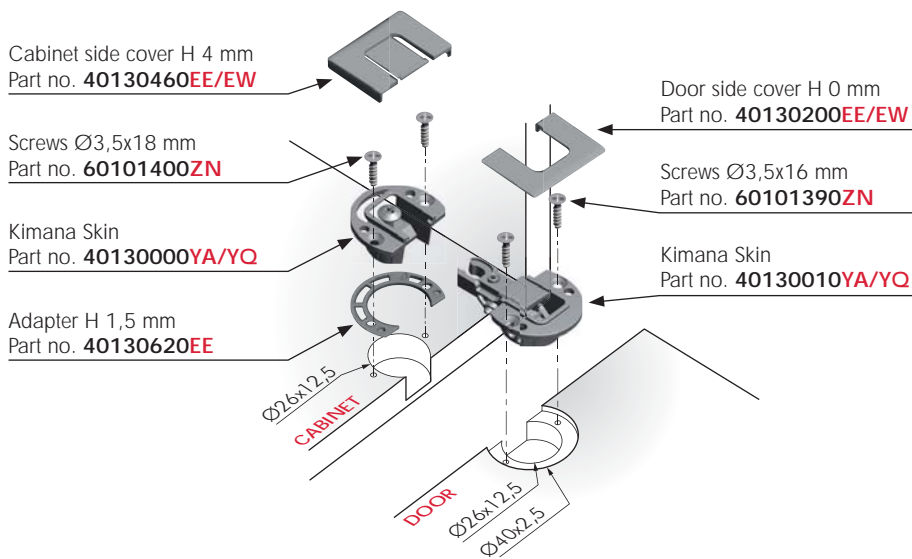

CABINET 18 mm THICK - DOOR 18-19 mm THICK

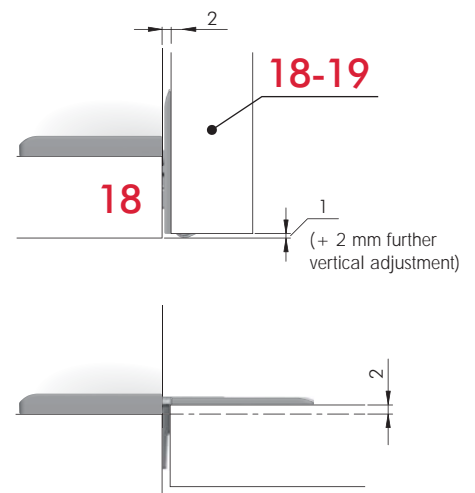
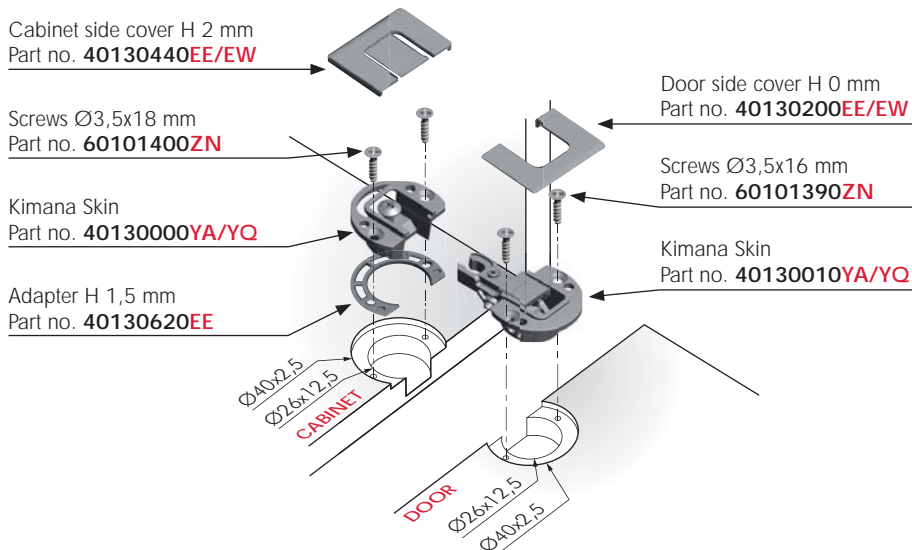

CABINET 18 mm THICK - DOOR 18-19-20 mm THICK

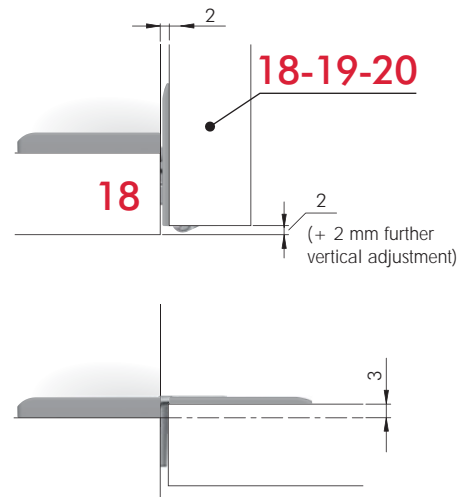
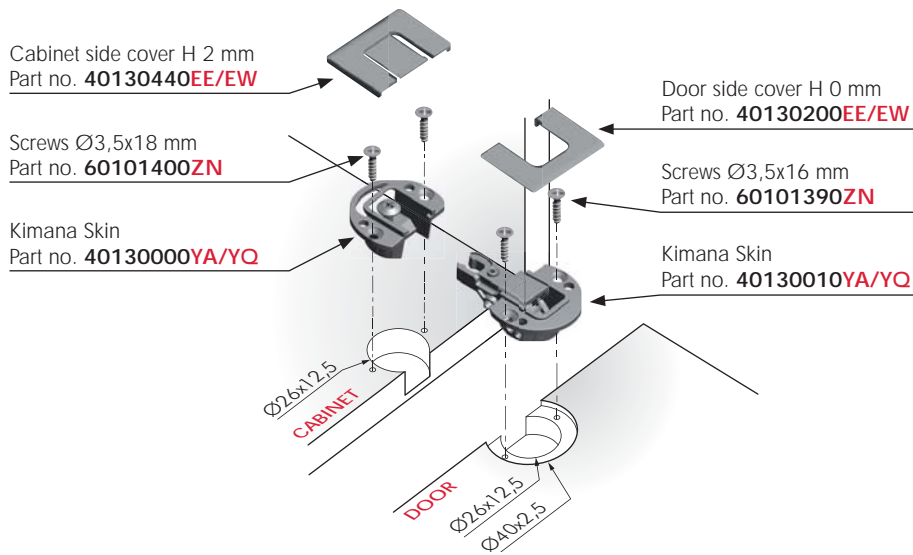

CABINET 19 mm THICK - DOOR 18 mm THICK

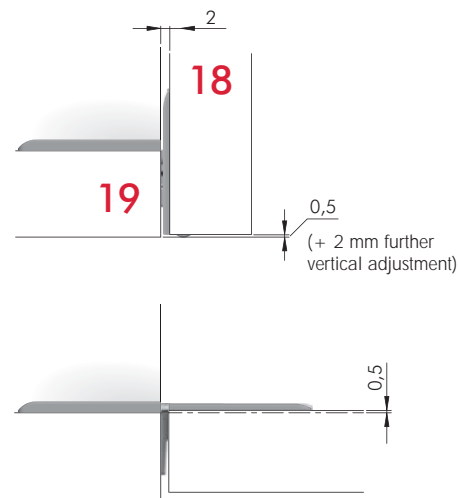
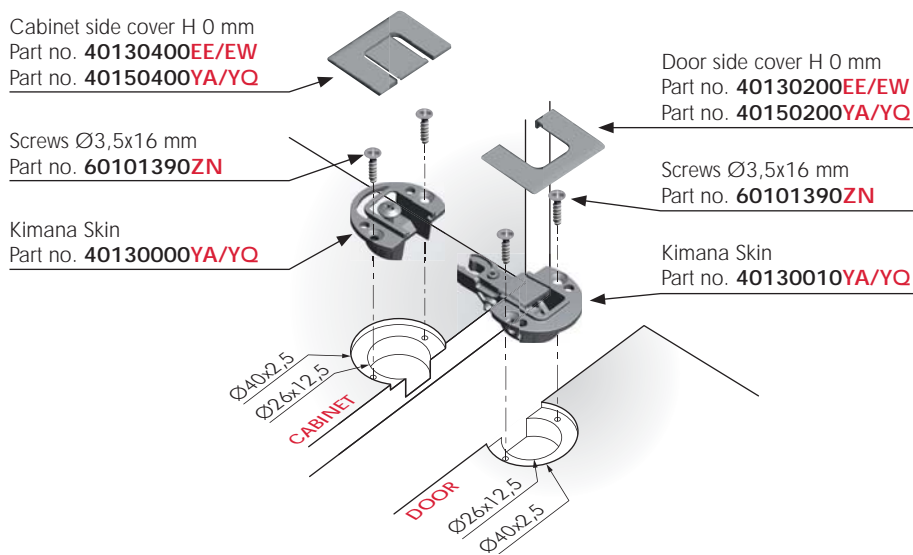

CABINET 19 mm THICK - DOOR 18-19-20 mm THICK

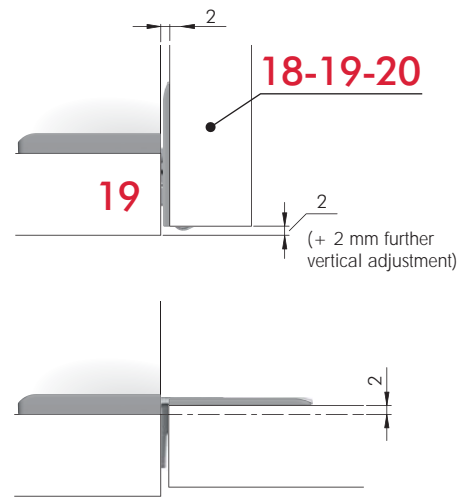
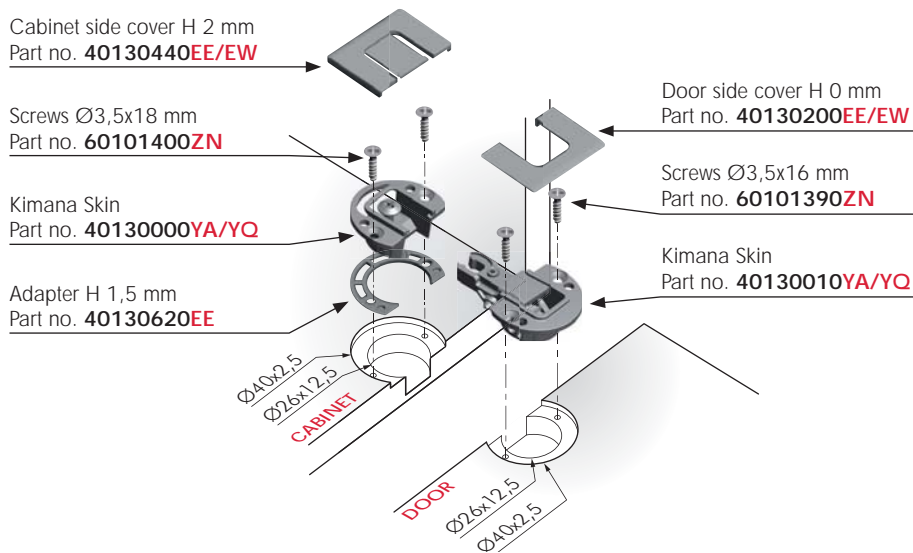



CABINET 20 mm THICK - DOOR 18-19-20 mm THICK

Cabinet side cover H 0 mm
 Part no. **40130400EE/EW**
 Part no. **40150400YA/YQ**

Screws $\varnothing 3,5 \times 18$ mm
 Part no. **60101400ZN**

Kimana Skin
 Part no. **40130000YA/YQ**

Door side cover H 0 mm
 Part no. **40130200EE/EW**
 Part no. **40150200YA/YQ**

Screws $\varnothing 3,5 \times 16$ mm
 Part no. **60101390ZN**

Kimana Skin
 Part no. **40130010YA/YQ**

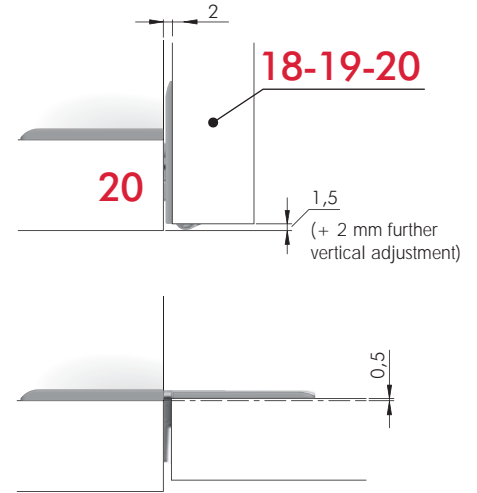
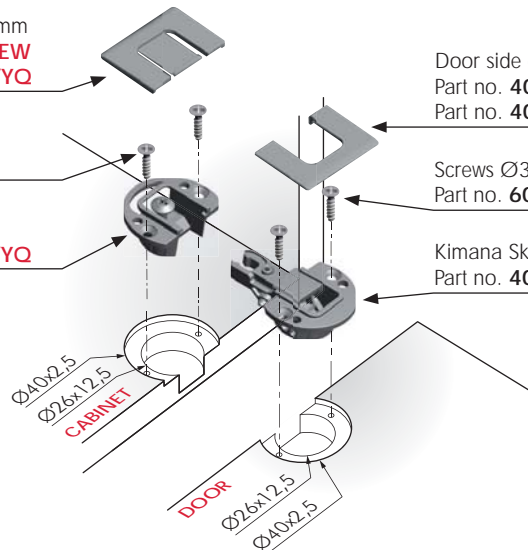

DRILLING PLANS TO MANAGE OVERLAY AND GAP BETWEEN DOOR AND CABINET

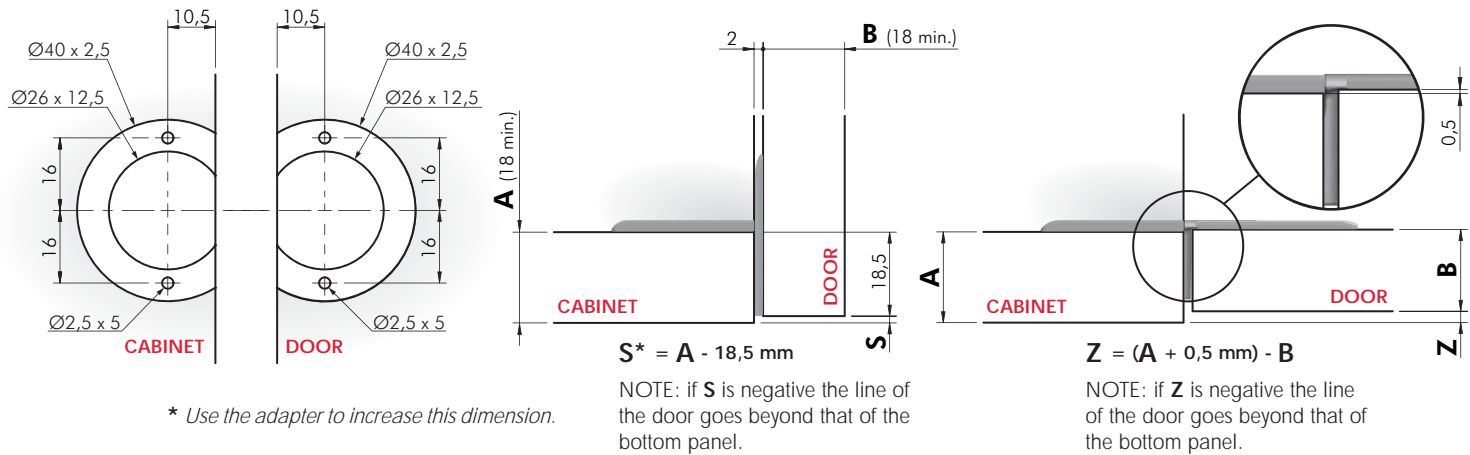

* Use the adapter to increase this dimension.

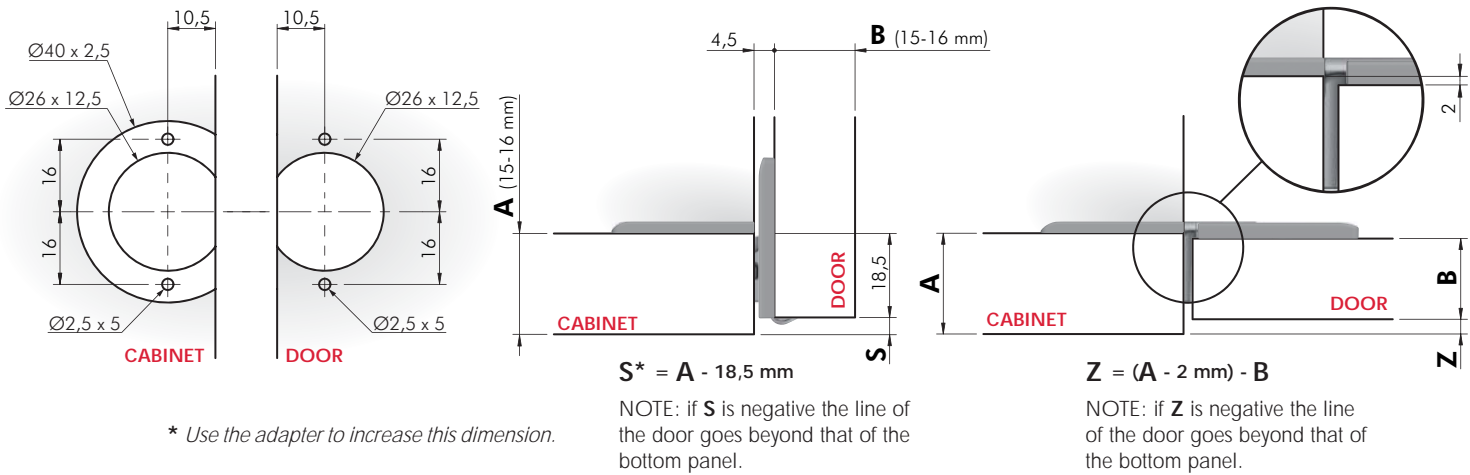

* Use the adapter to increase this dimension.

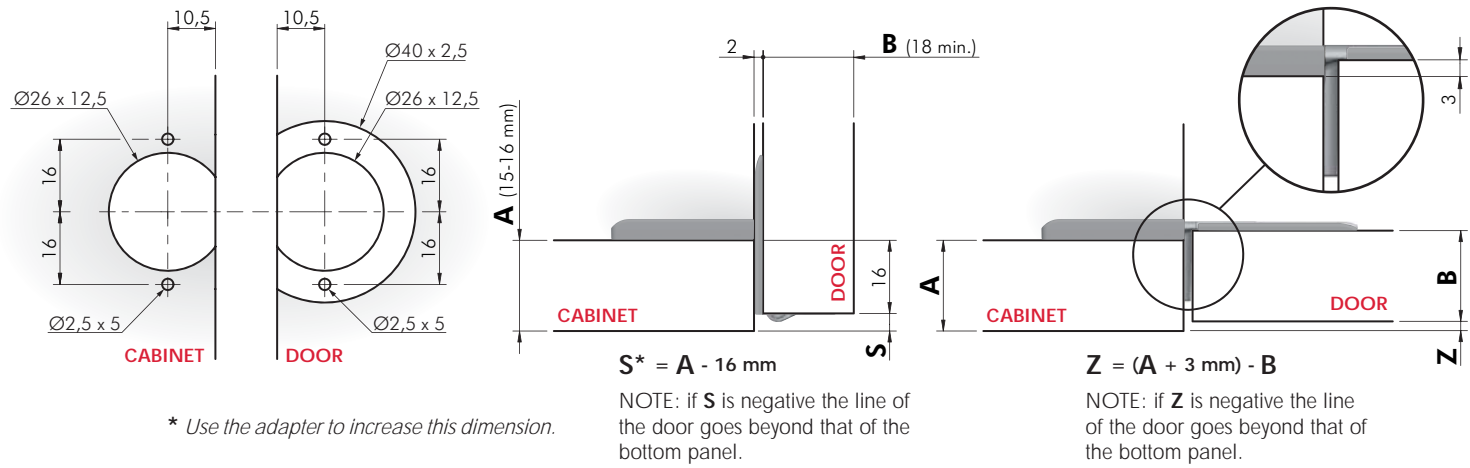

* Use the adapter to increase this dimension.

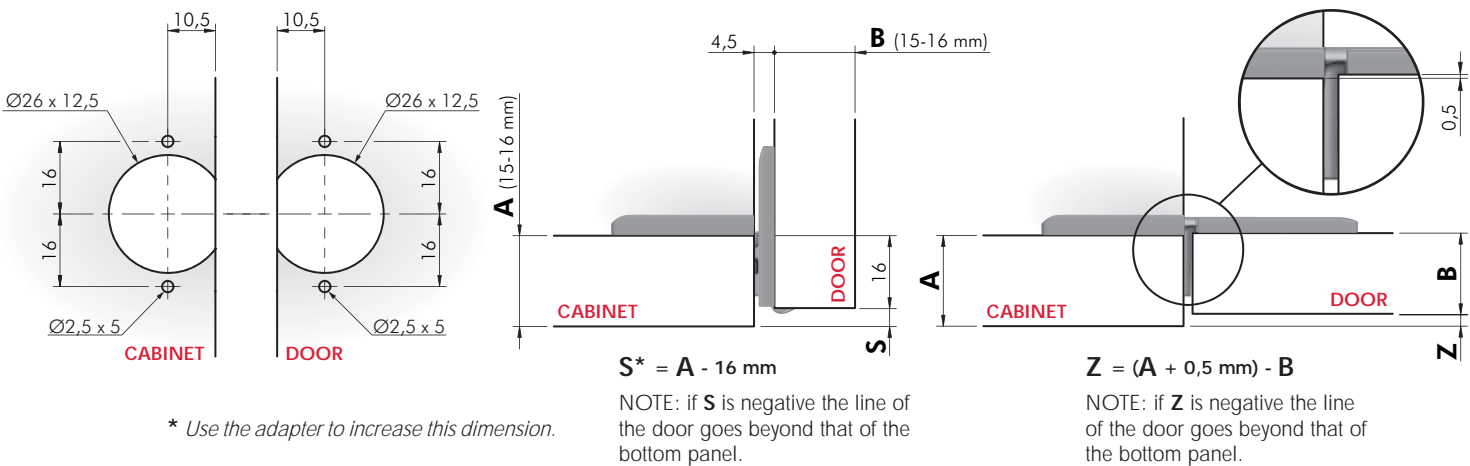

* Use the adapter to increase this dimension.