



PS66

**Sistema scorrevole
per ante a scomparsa**
Sliding system for
retractable doors





PS66

Sistema scorrevole per ante a scomparsa
Sliding system for retractable doors

Accessori complementari
Additional accessories

- **B-moved - Sistema elettrico per l'apertura e la chiusura delle ante.**
B-moved - Electric system for opening and closing of the doors.

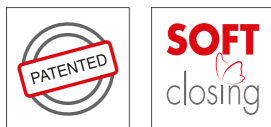
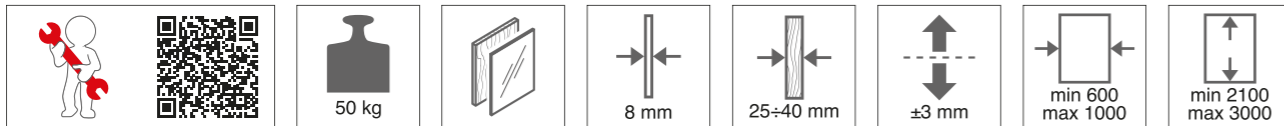



Organizzare lo spazio senza interruzioni, ostacoli o opere murarie. Grazie all'innovativa tecnologia che lavora senza binario superiore e inferiore, PS66 permette di ottenere un risultato pulito e lineare. Qui è rappresentata una classica applicazione di portale per cabina armadio. Un open space viene convertito in due stanze distinte con il solo utilizzo di pannelli in legno ed ante in vetro.

Organize the space without interruptions, obstacles or masonry works. Thanks to the innovative technology that works without upper and lower rails, PS66 allows you to obtain a clean and linear result. Here we represent a classic portal application for walk-in closet. An open space is converted into two separate rooms only using wooden panels and glass doors.

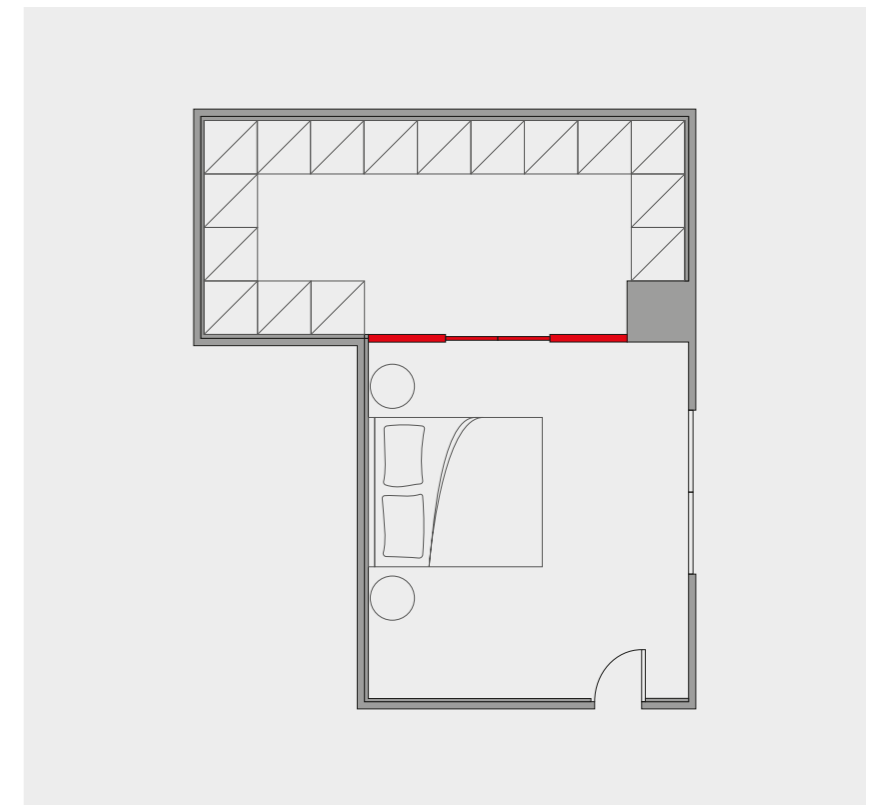

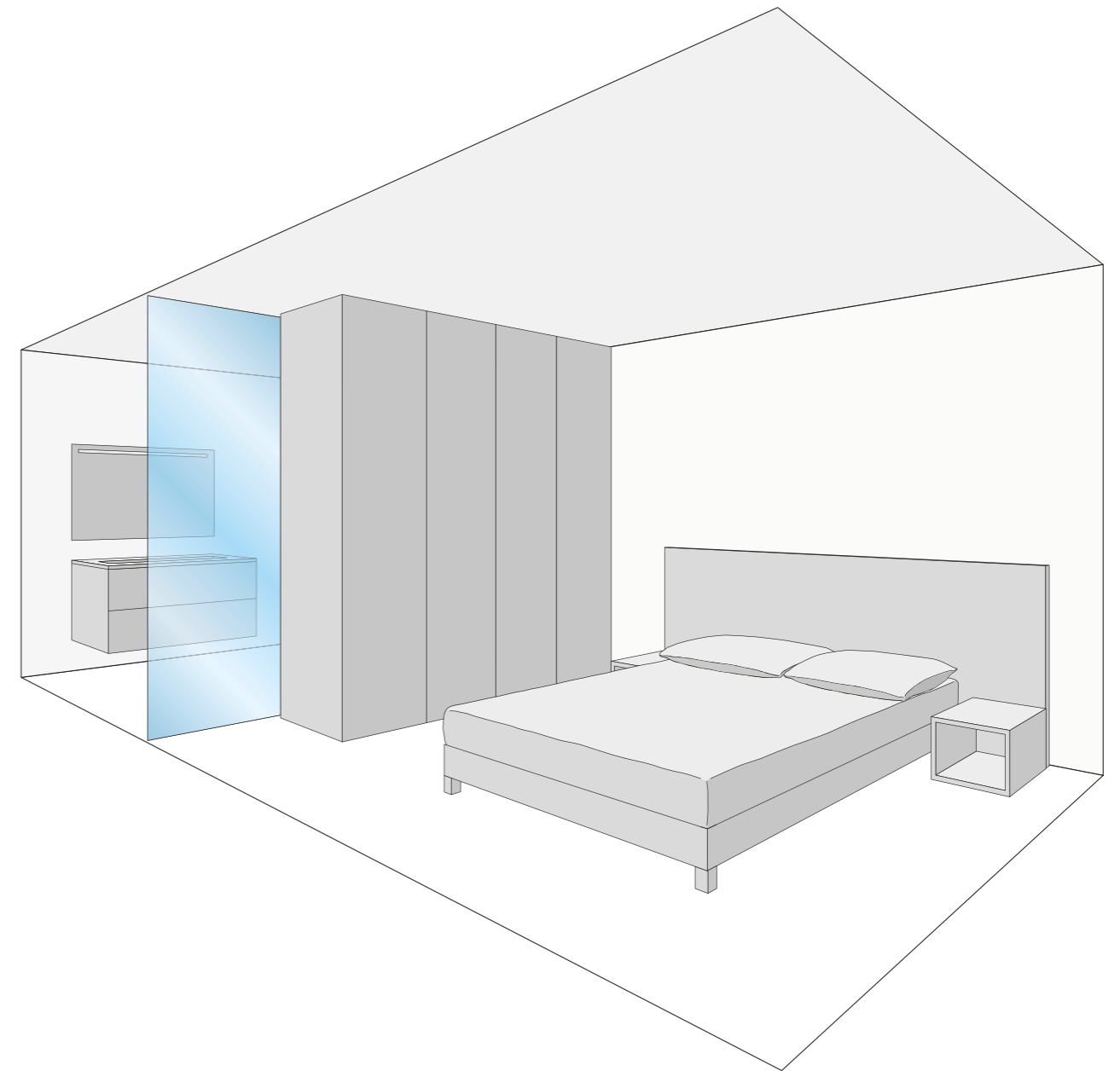
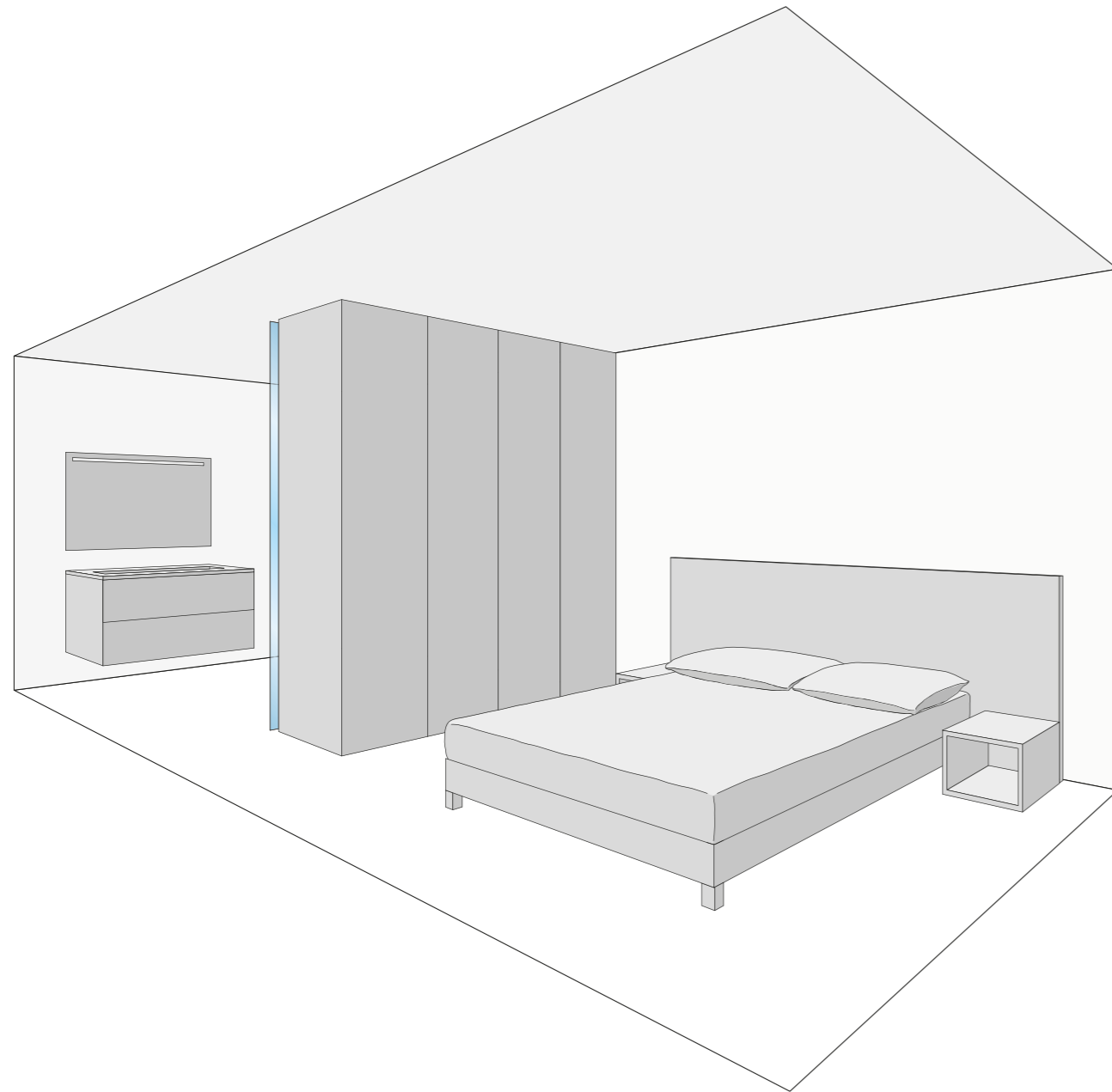

Una nuova idea di stanza, facile da creare e trasformare. Qui vediamo rappresentata una stanza divisa in due da un armadio e da PS66, applicato alla struttura stessa del mobile. L'assenza di muratura o di strutture permanenti rendono più semplice modificare il layout della stanza qualora si rendesse necessario.

A new idea of room, easy to create and transform. Here we represent a room divided in two by a wardrobe and by PS66, applied to the structure of the cabinet itself. The absence of masonry or permanent structures make it easier to change the layout of the room if necessary.

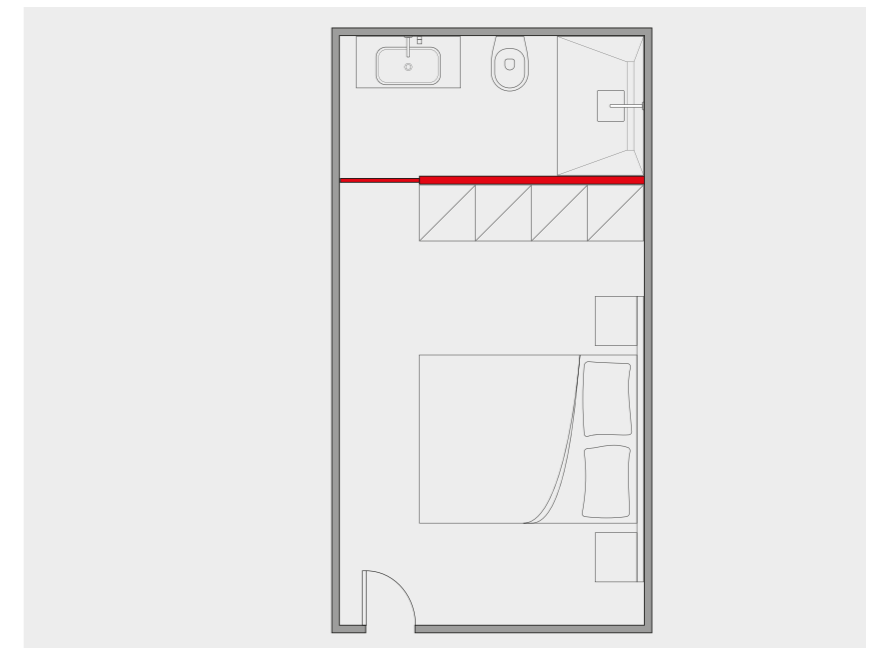

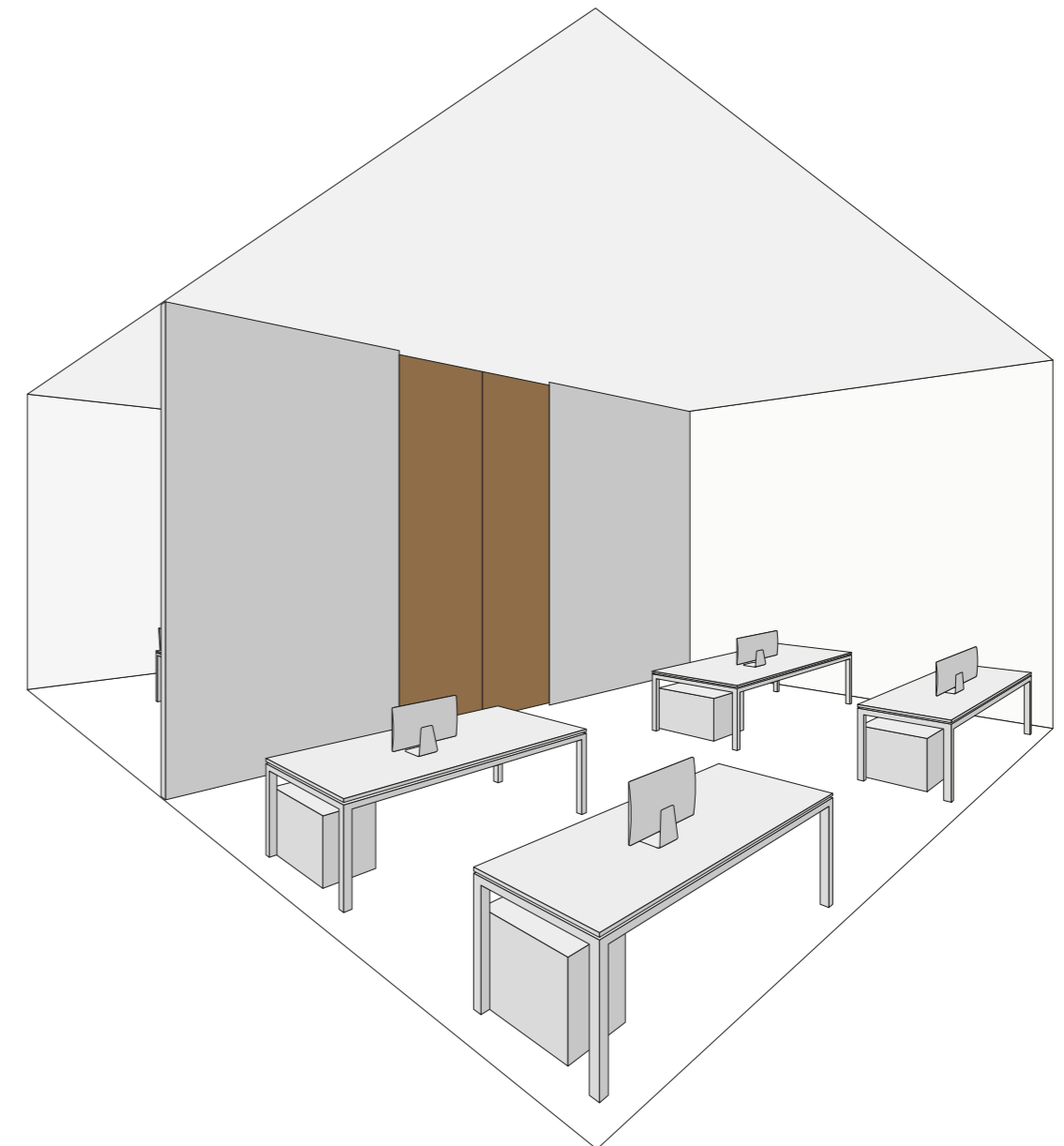
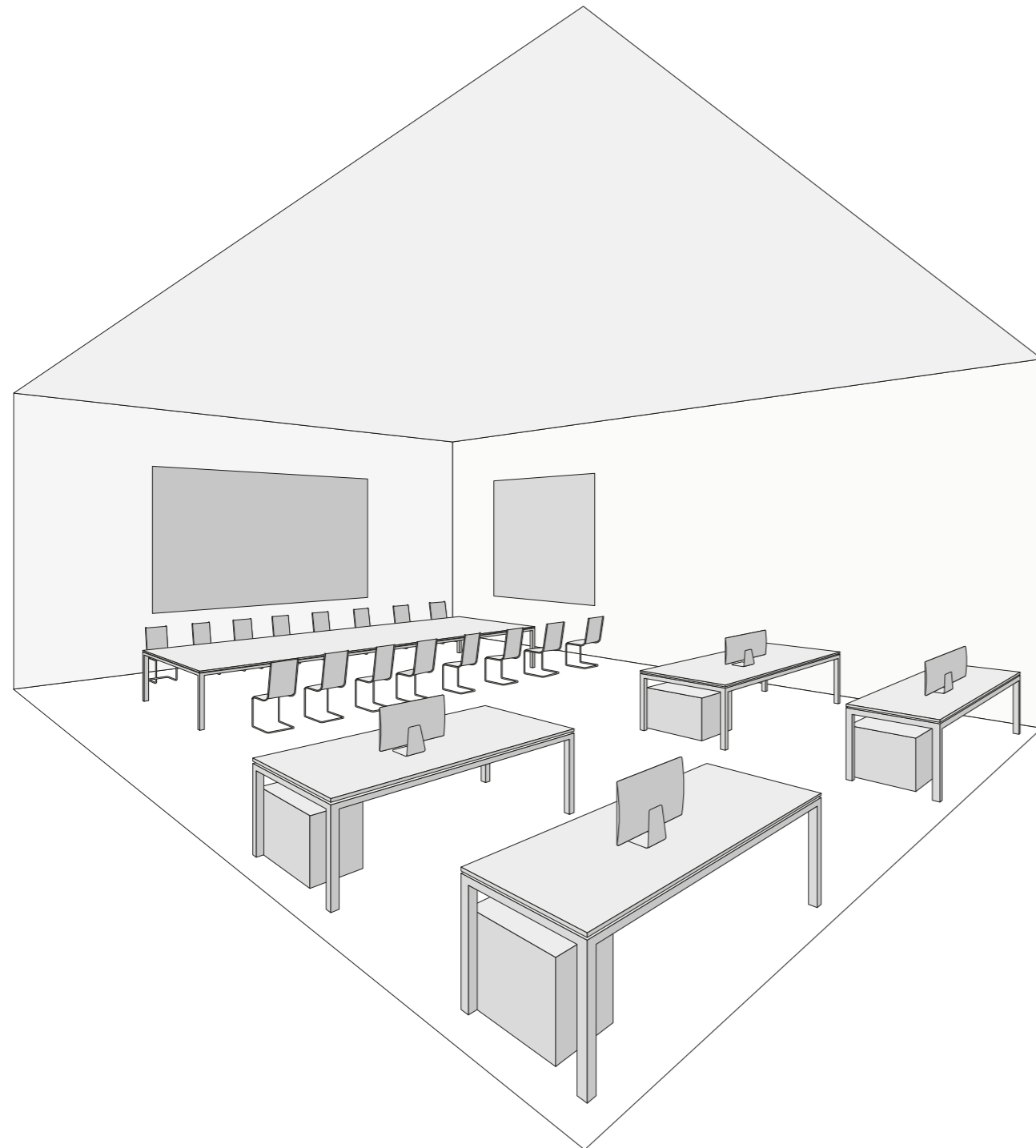

Progetta un nuovo ambiente su misura per te. Reinventa anche grandi spazi grazie a PS66 e alla sua flessibilità. Questo sistema infatti permette di realizzare ante, vetro o legno, con un'altezza minima di 2100 mm fino ad un massimo di 3000 mm. Qui rappresentiamo PS66 nella versione con anta legno, utilizzato per dividere un ambiente ufficio da una nuova sala riunioni.

Design a new environment tailored for you. Reinvents also large spaces thanks to PS66 and its flexibility. In fact, this system makes possible to create glass or wooden doors with a minimum height of 2100 mm up to a maximum of 3000 mm. Here we represent PS66 in the version with wooden door, used to divide an office environment from a new meeting room.

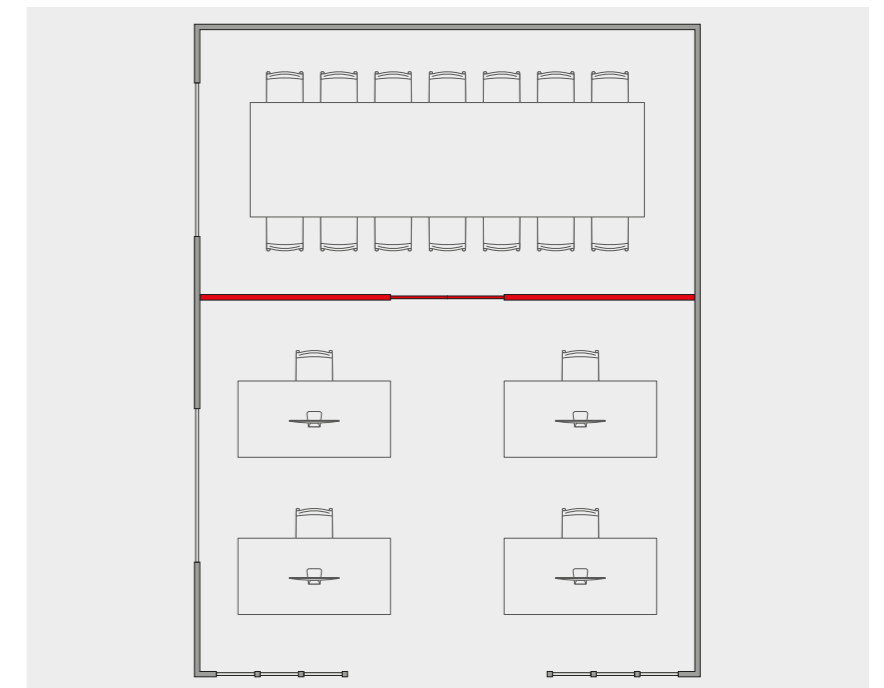



Unire l'utile al dilettevole. PS66 permette di ottenere un design ottimale senza rinunciare alla praticità. Qui illustriamo PS66 usato come accesso ad uno spazio "segreto", in questo caso la dispensa di una cucina. Grazie alle speciali caratteristiche del sistema, che lavora sospeso, l'anta rispetta le dimensioni dei moduli circostanti, integrandosi perfettamente nel design della cucina.

Combine useful and pleasant. PS66 allows to obtain an optimal design without sacrificing practicality. Here we illustrate PS66 used as an access to a "secret" space, in this case the pantry of a kitchen. Thanks to the features of the system, which works suspended, the door respects the dimensions of the surrounding modules, integrating perfectly into the design of the kitchen.

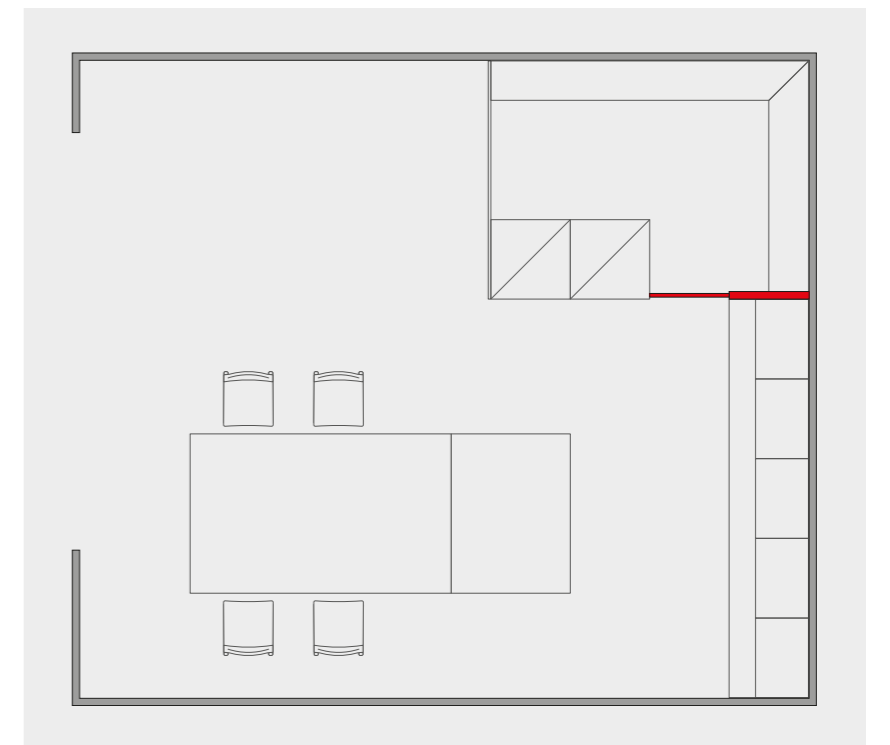

Senza binario superiore e inferiore
Without upper and lower profile

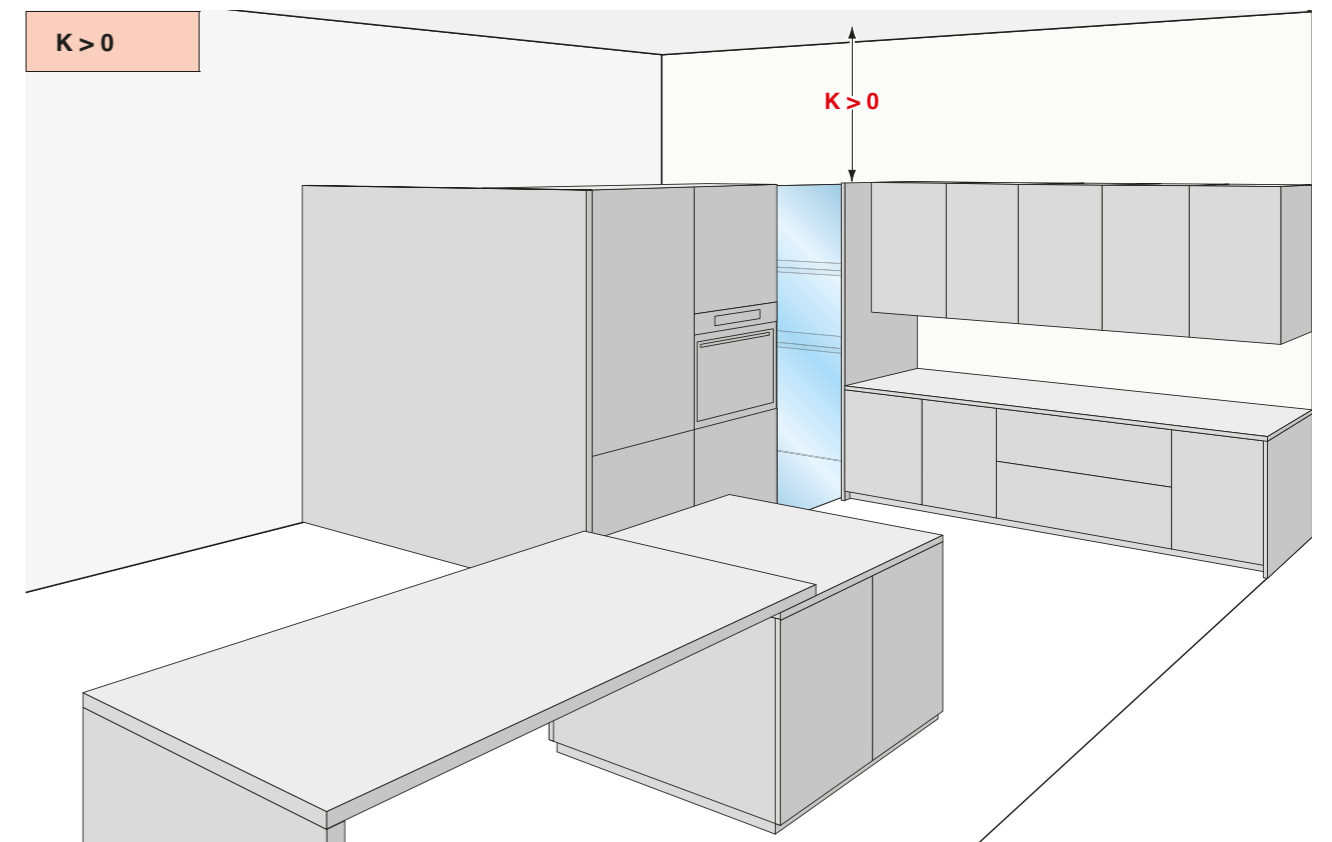
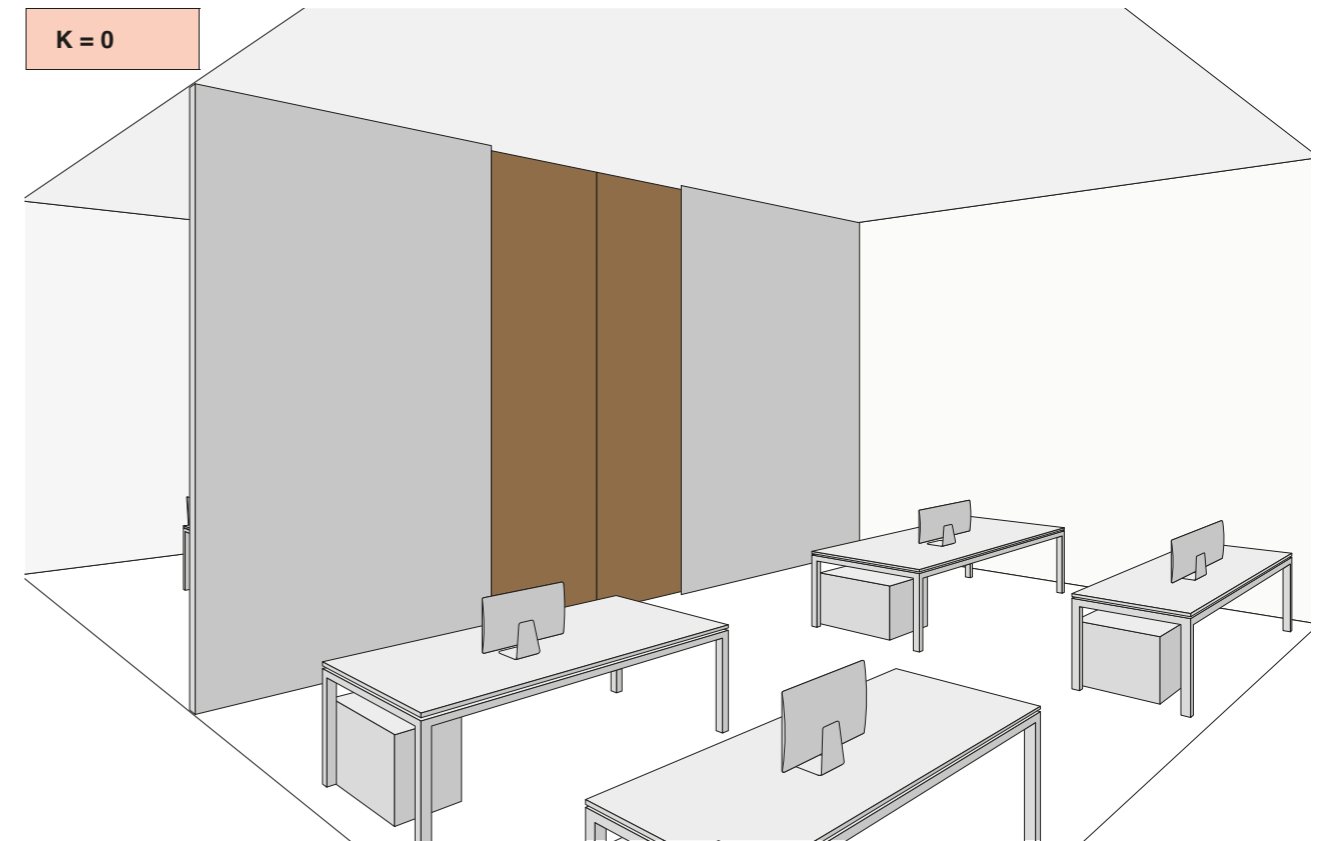
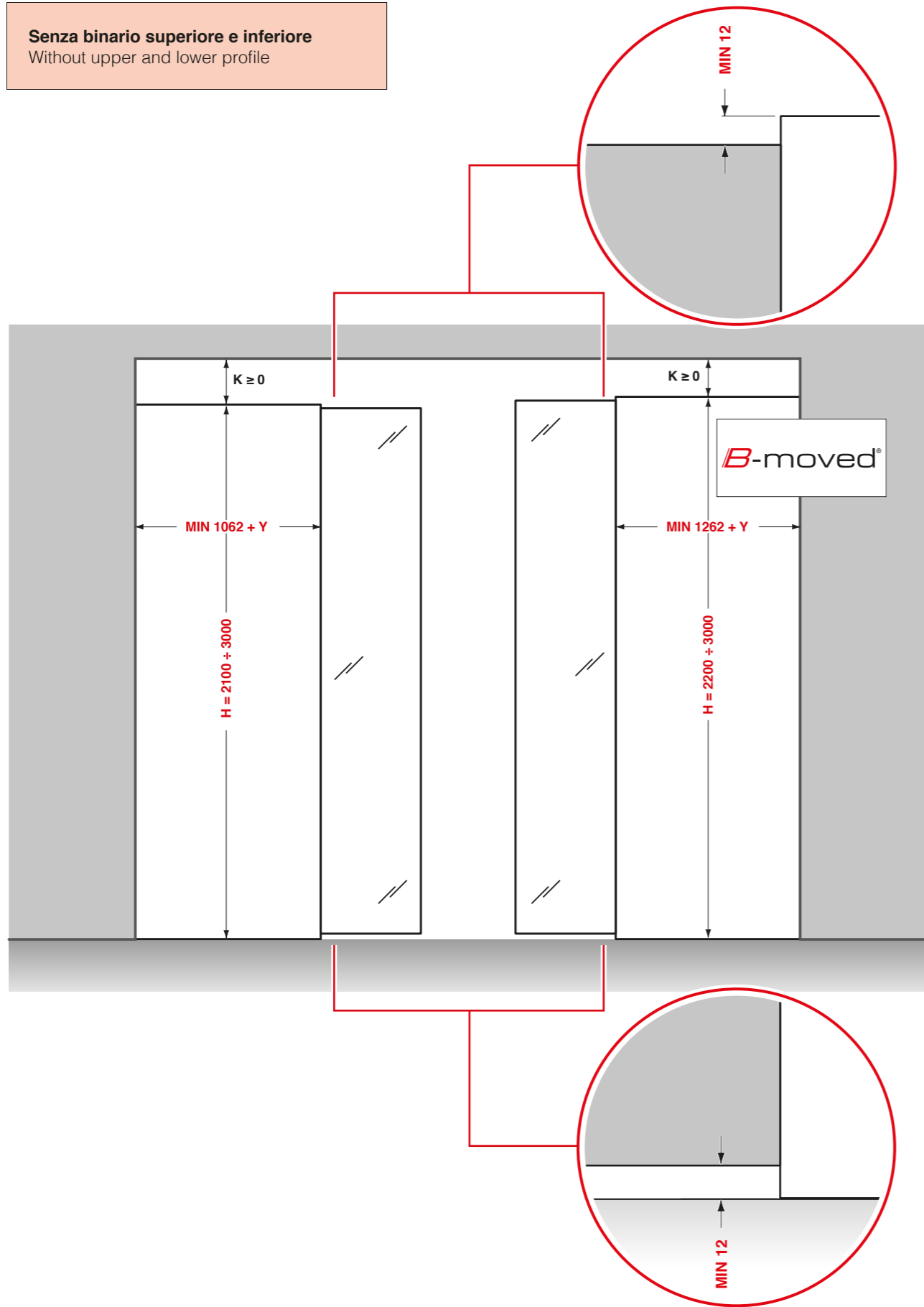

PS66 - wood

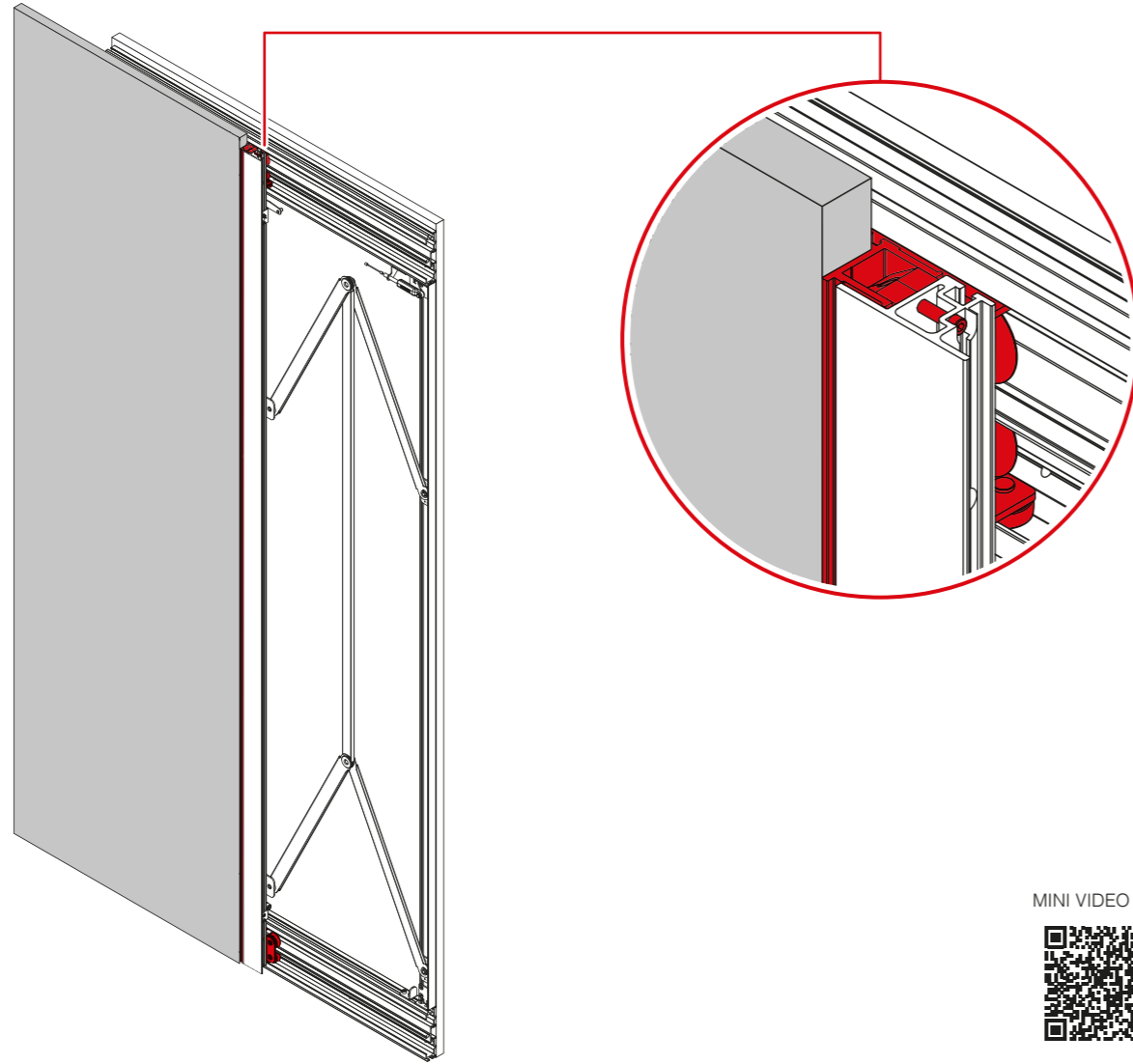
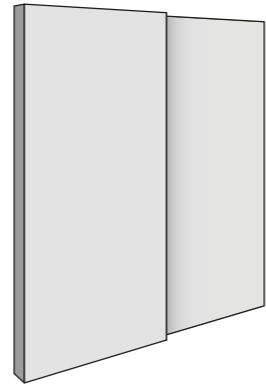
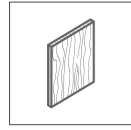

MINI VIDEO



page 20

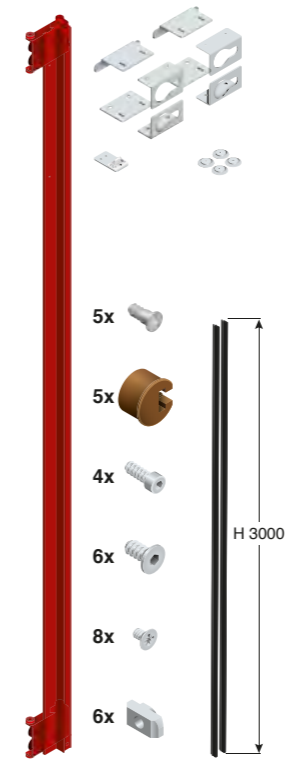
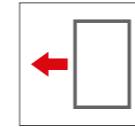
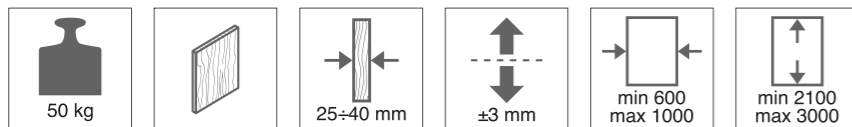

Confezione di montaggio per anta destra in legno Right wooden door assembly kit		
SMALL	H = 2100 ÷ 2400	PS66PDLE7000001
MEDIUM	H = 2400 ÷ 2700	PS66PDLE7000002
LARGE	H = 2700 ÷ 3000	PS66PDLE7000003

+

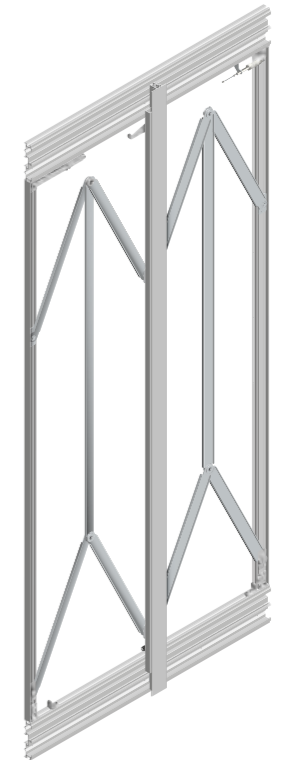

Meccanismo per anta destra Mechanism for right door		
SMALL	H = 2100 ÷ 2400	PS66MDSM7000001
MEDIUM	H = 2400 ÷ 2700	PS66MDSM7000002
LARGE	H = 2700 ÷ 3000	PS66MDSM7000003

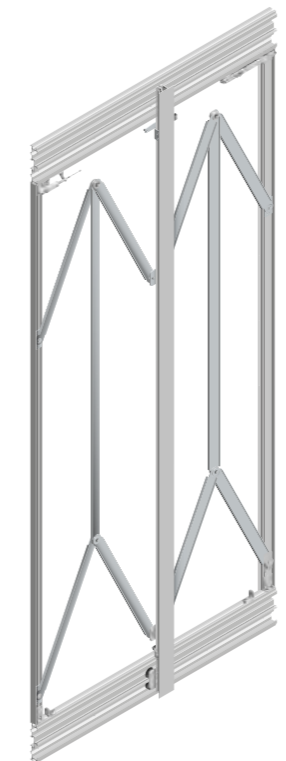
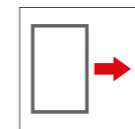

+

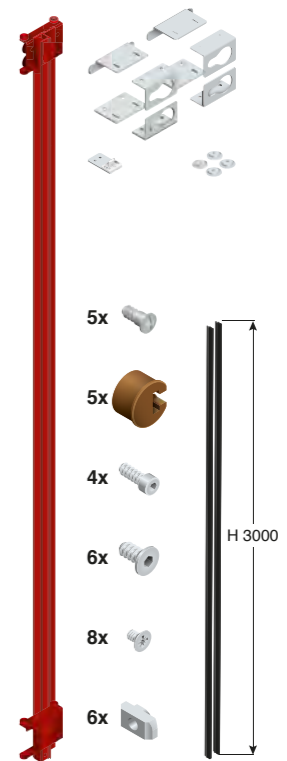

Meccanismo per anta sinistra Mechanism for left door		
SMALL	H = 2100 ÷ 2400	PS66MSSM7000001
MEDIUM	H = 2400 ÷ 2700	PS66MSSM7000002
LARGE	H = 2700 ÷ 3000	PS66MSSM7000003

Confezione di montaggio per anta sinistra in legno Left wooden door assembly kit		
SMALL	H = 2100 ÷ 2400	PS66PSLE7000001
MEDIUM	H = 2400 ÷ 2700	PS66PSLE7000002
LARGE	H = 2700 ÷ 3000	PS66PSLE7000003

PS66 - glass

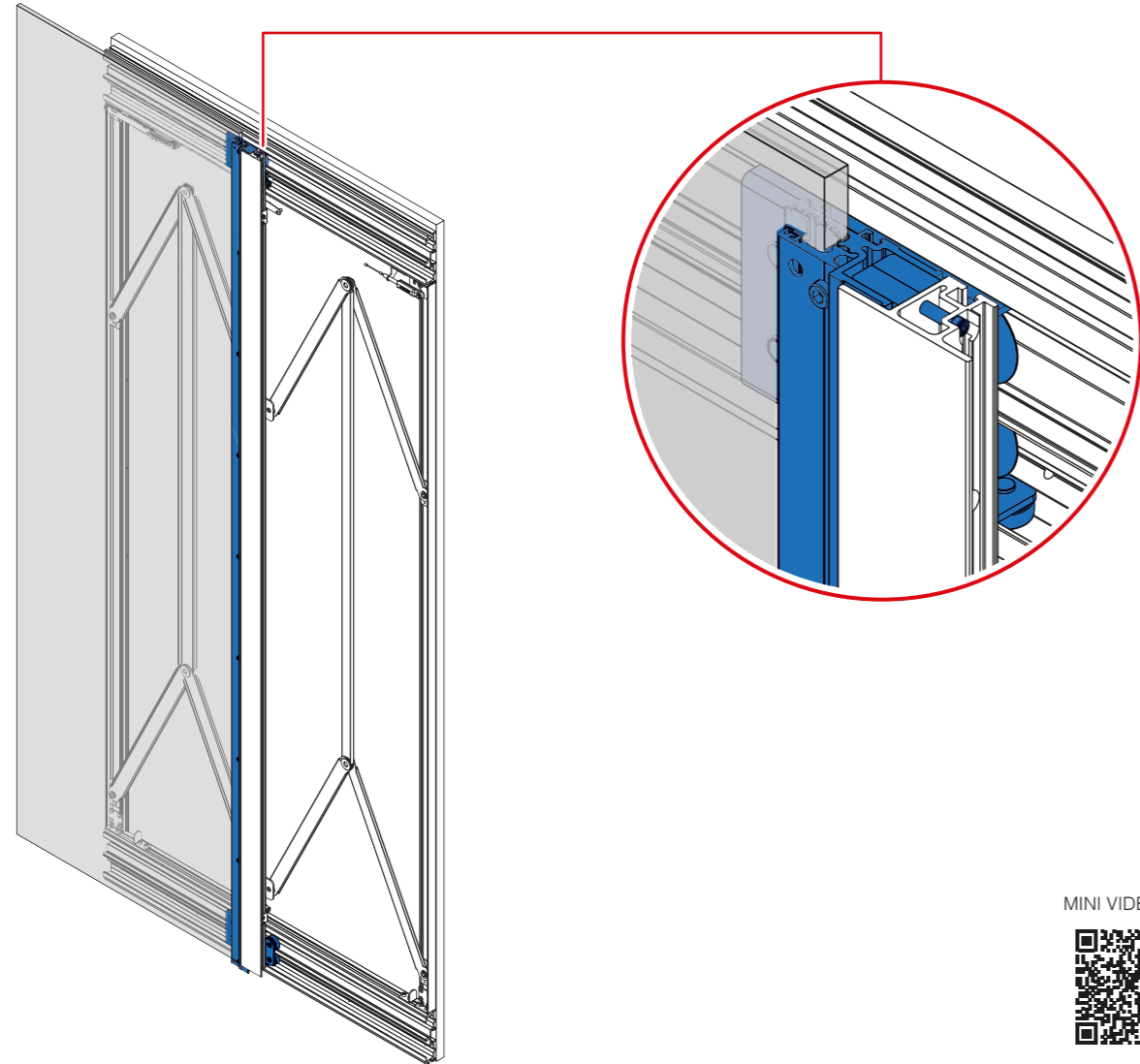
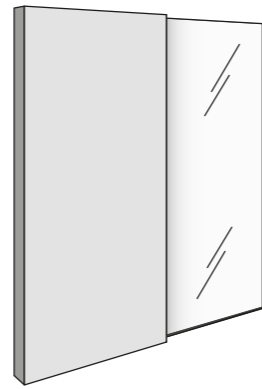
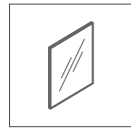

MINI VIDEO



page 24

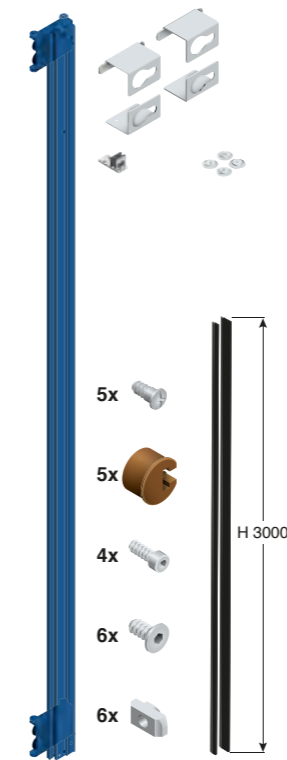
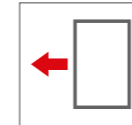
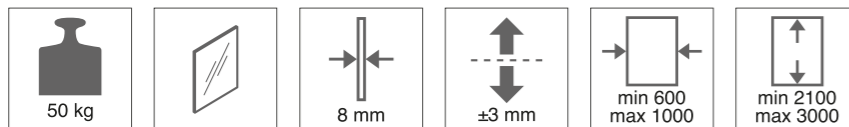

+

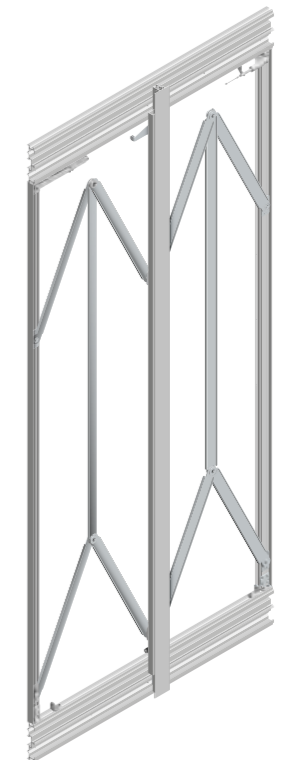

Confezione di montaggio per anta destra in vetro Right glass door assembly kit		
SMALL	H = 2100 ÷ 2400	PS66PDVE7000001
MEDIUM	H = 2400 ÷ 2700	PS66PDVE7000002
LARGE	H = 2700 ÷ 3000	PS66PDVE7000003

Meccanismo per anta destra Mechanism for right door		
SMALL	H = 2100 ÷ 2400	PS66MDSM70000001
MEDIUM	H = 2400 ÷ 2700	PS66MDSM70000002
LARGE	H = 2700 ÷ 3000	PS66MDSM70000003

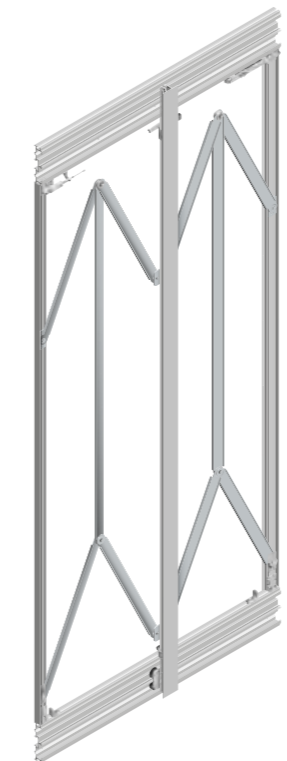
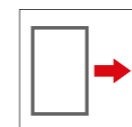

+

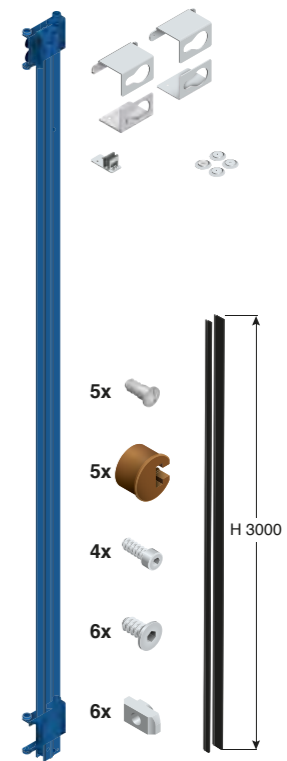

Meccanismo per anta sinistra Mechanism for left door		
SMALL	H = 2100 ÷ 2400	PS66MSSM70000001
MEDIUM	H = 2400 ÷ 2700	PS66MSSM70000002
LARGE	H = 2700 ÷ 3000	PS66MSSM70000003

Confezione di montaggio per anta sinistra in vetro Left glass door assembly kit		
SMALL	H = 2100 ÷ 2400	PS66PSVE70000001
MEDIUM	H = 2400 ÷ 2700	PS66PSVE70000002
LARGE	H = 2700 ÷ 3000	PS66PSVE70000003

PS66 & B-moved

Sistema elettrico per l'apertura e la chiusura delle ante.
Electric system for opening and closing of the doors.

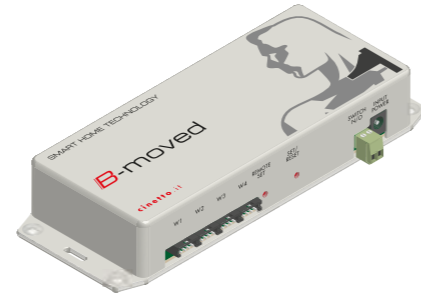

Possibili configurazioni.
Possible configurations.

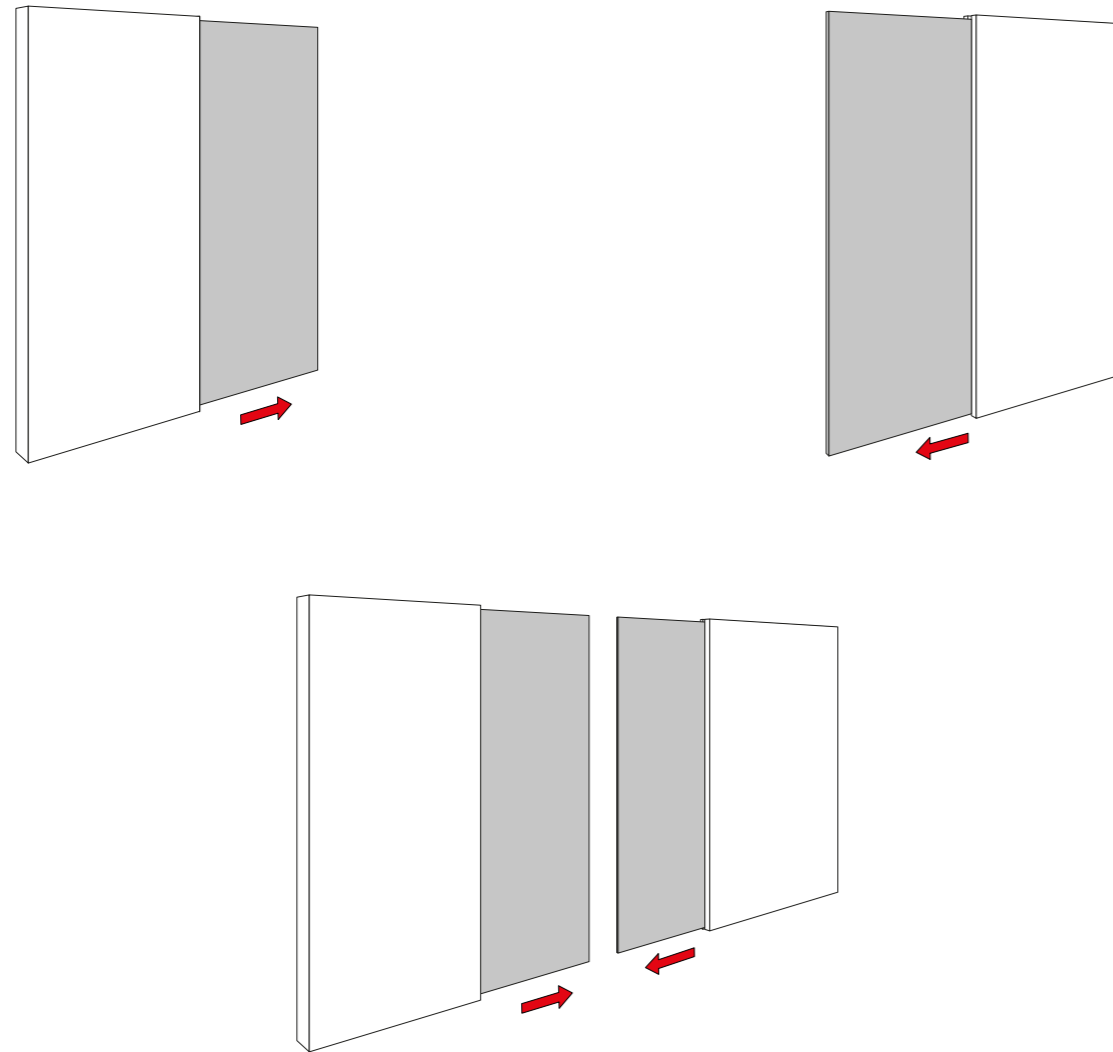

Sistemi di apertura.
Opening ways.

■ **Configurazione standard.**
Standard configuration.

Apertura standard con input manuale o con l'uso del telecomando.
Standard opening with manual input or by using the remote control.

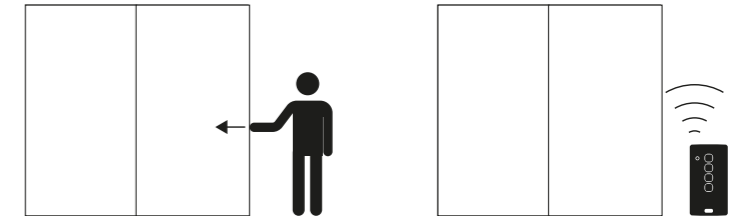

■ **Sensore di prossimità Wireless.**
Wireless proximity sensor.

Possibilità di apertura tramite l'utilizzo di sensori di prossimità wireless.
Possibility of opening using a wireless proximity sensor.

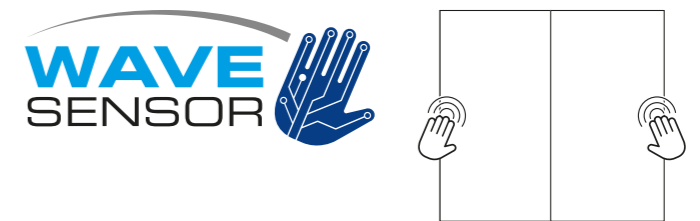

■ **Smart Home.**

Compatibilità con i sistemi "HOME ASSISTANT".
"HOME ASSISTANT" systems compatible.



Accessori complementari
Additional accessories

■ **B-moved - Sistema elettrico per l'apertura e la chiusura delle ante.**
B-moved - Electric system for opening and closing of the doors.



PS66 - wood

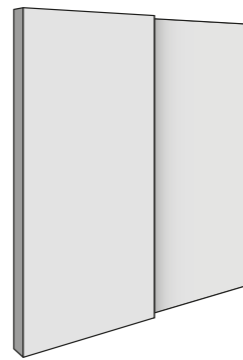
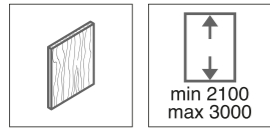

1

R

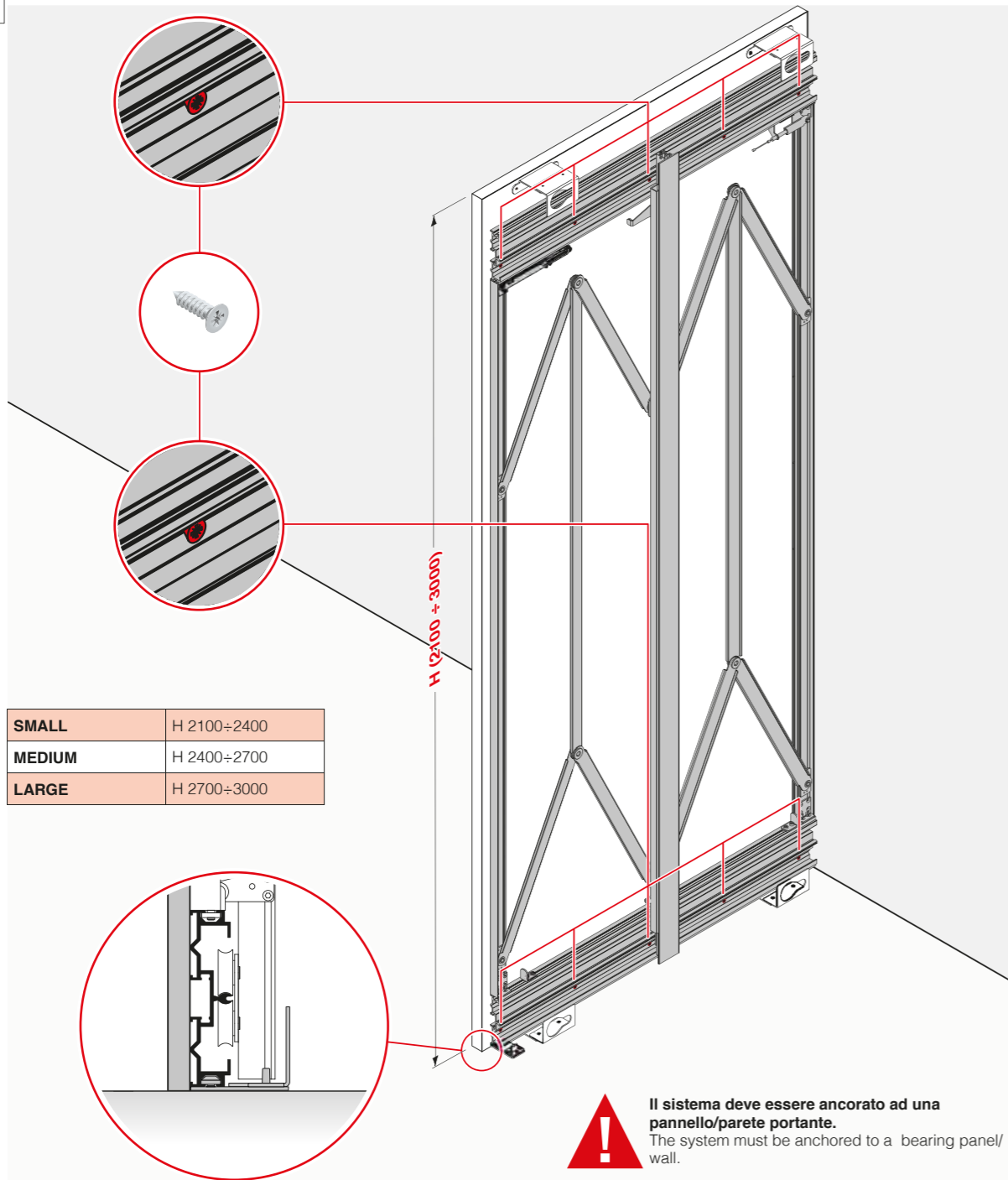
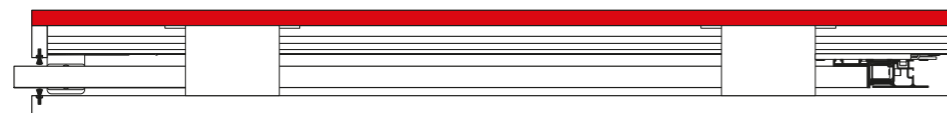

SMALL	H 2100÷2400
MEDIUM	H 2400÷2700
LARGE	H 2700÷3000



Il sistema deve essere ancorato ad una pannello/parete portante.
The system must be anchored to a bearing panel/wall.

2

R

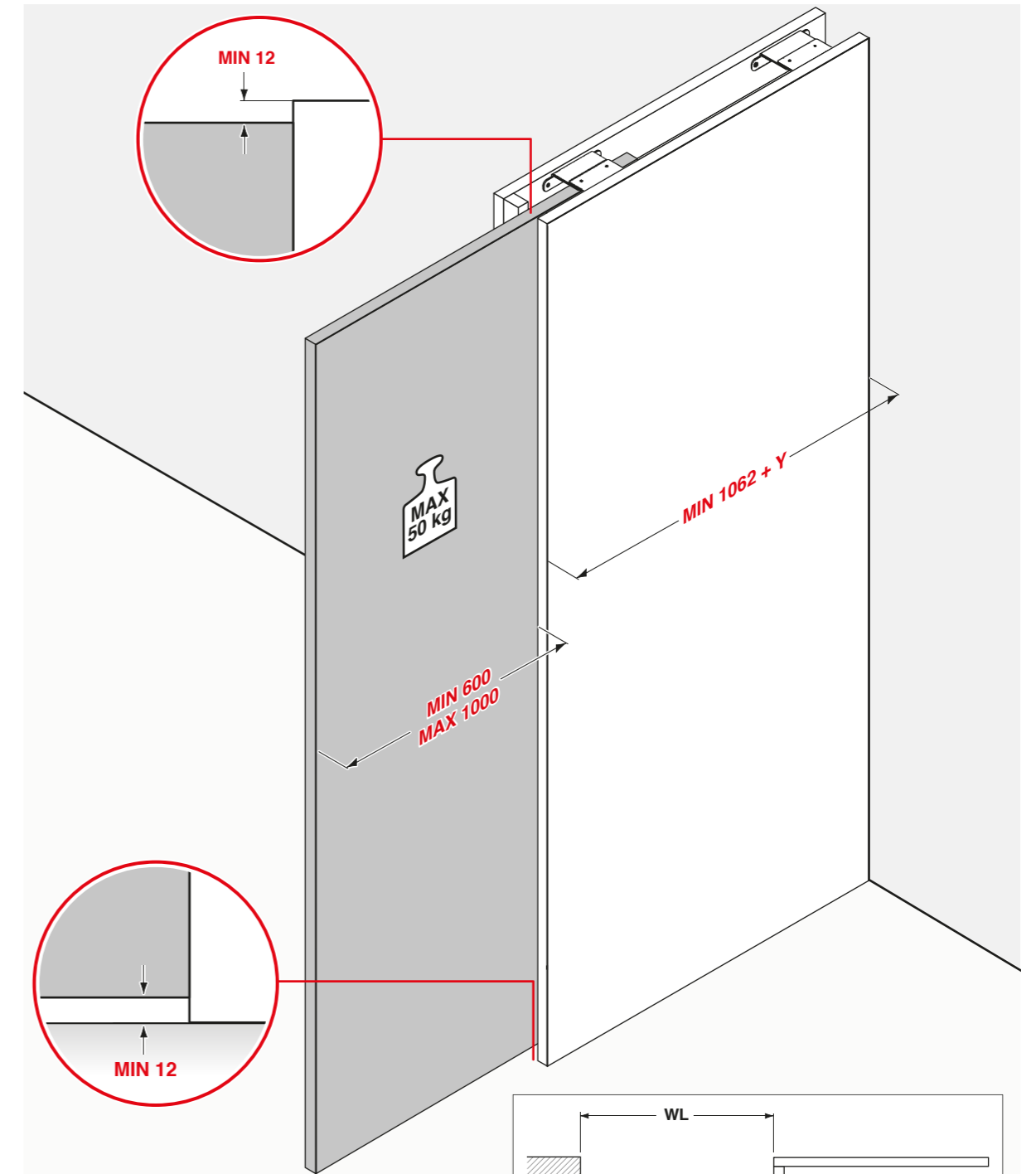

ABBREVIAZIONI:
WL = luce vano
X = porzione di porta sempre a vista

ABBREVIATIONS:
WL = clear opening
X = portion of door always visible

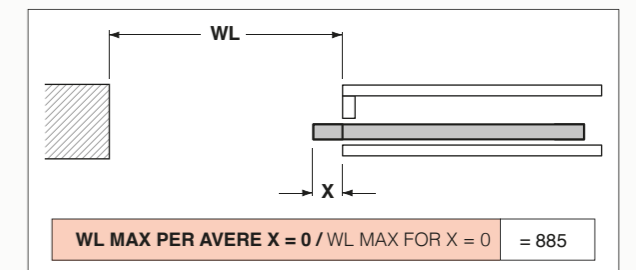

3

R

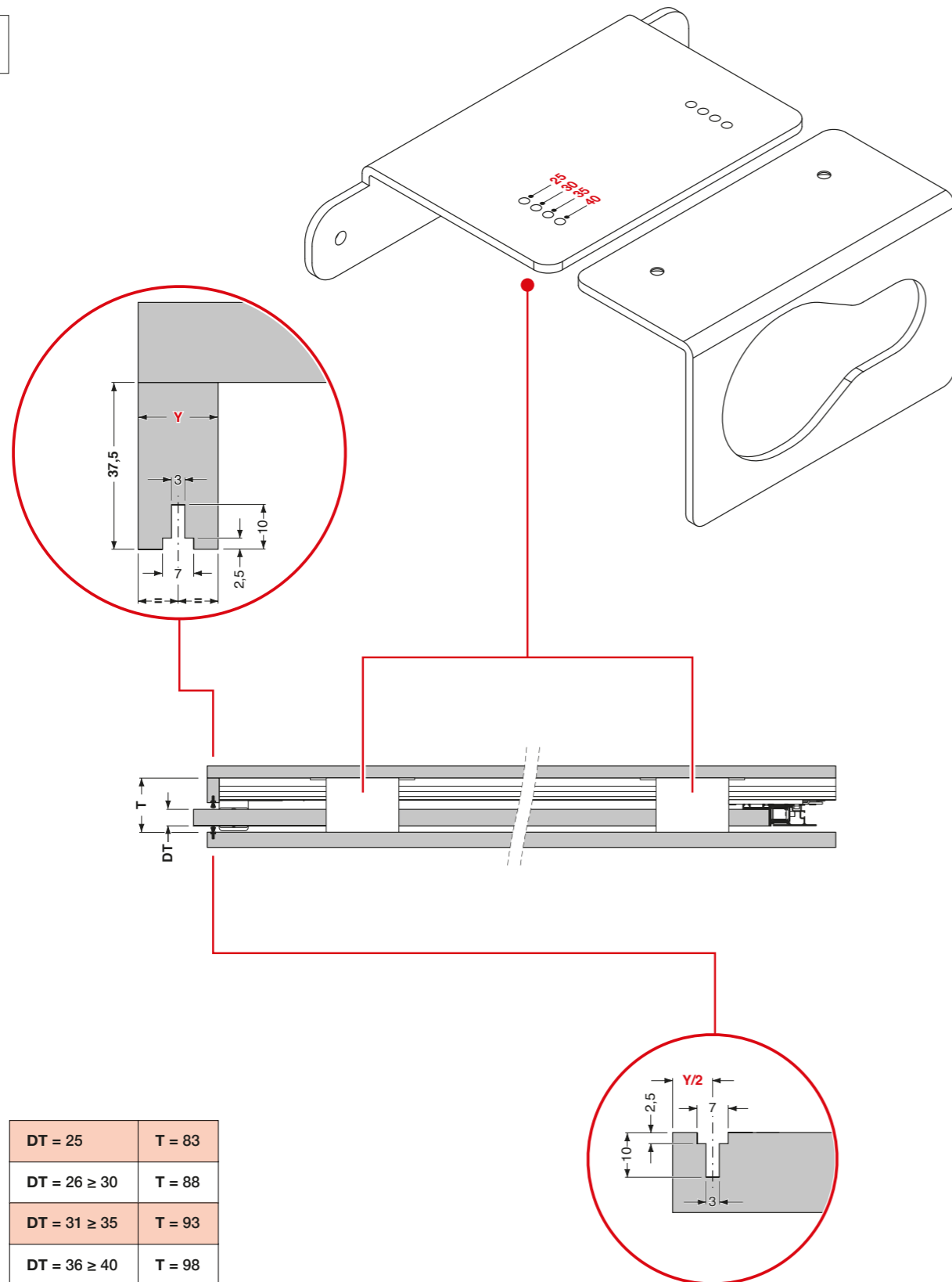

DT = 25	T = 83
DT = 26 ≥ 30	T = 88
DT = 31 ≥ 35	T = 93
DT = 36 ≥ 40	T = 98

4

L=R

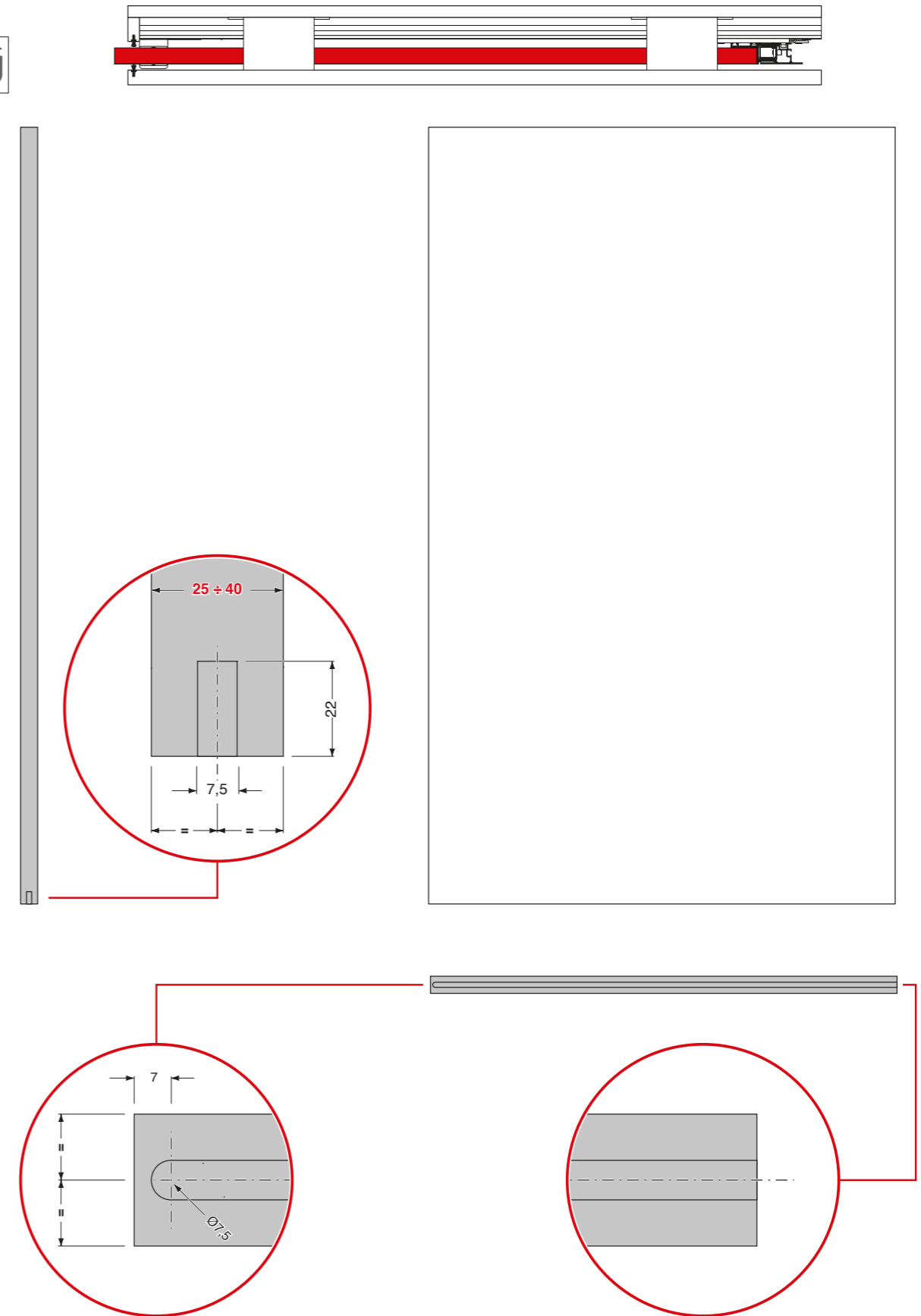

PS66 - glass

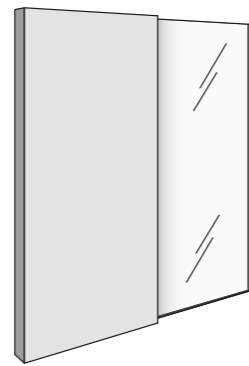
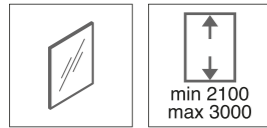

1

R

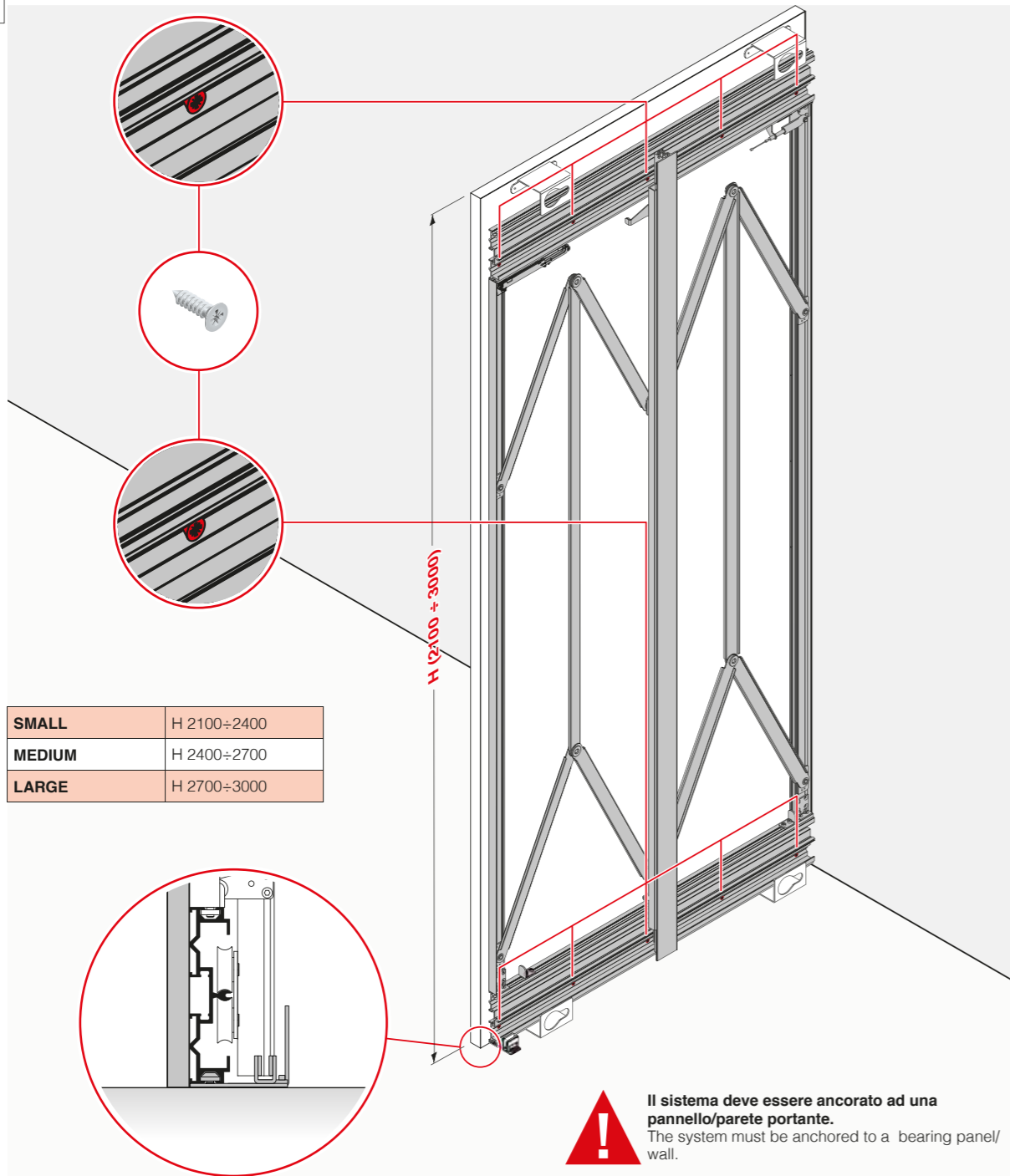
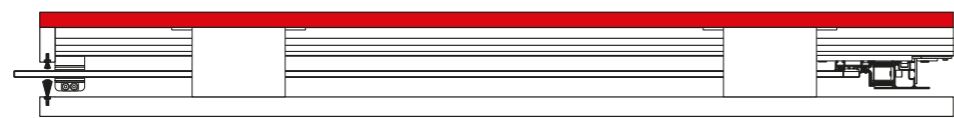

H (2100 + 3000)

SMALL	H 2100÷2400
MEDIUM	H 2400÷2700
LARGE	H 2700÷3000

! Il sistema deve essere ancorato ad una pannello/parete portante.
The system must be anchored to a bearing panel/wall.

2

R

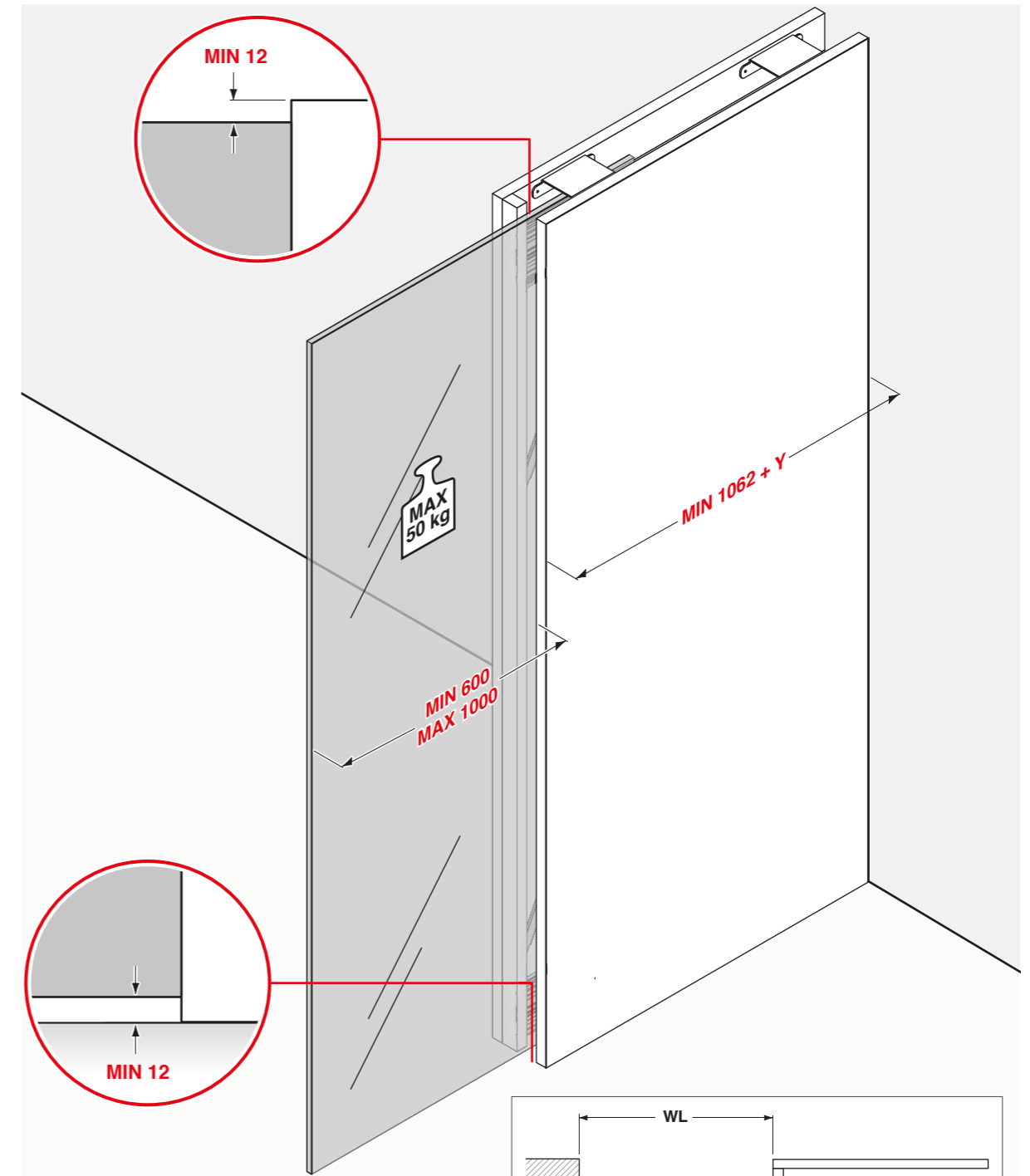
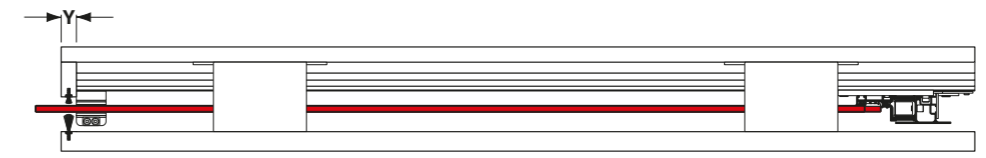

ABBREVIAZIONI:
WL = luce vano
X = porzione di porta sempre a vista
ABBREVIATIONS:
WL = clear opening
X = portion of door always visible

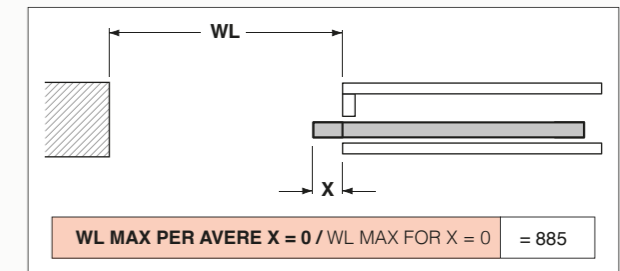

PS66 & B-moved

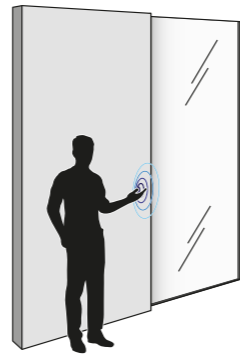

1

R

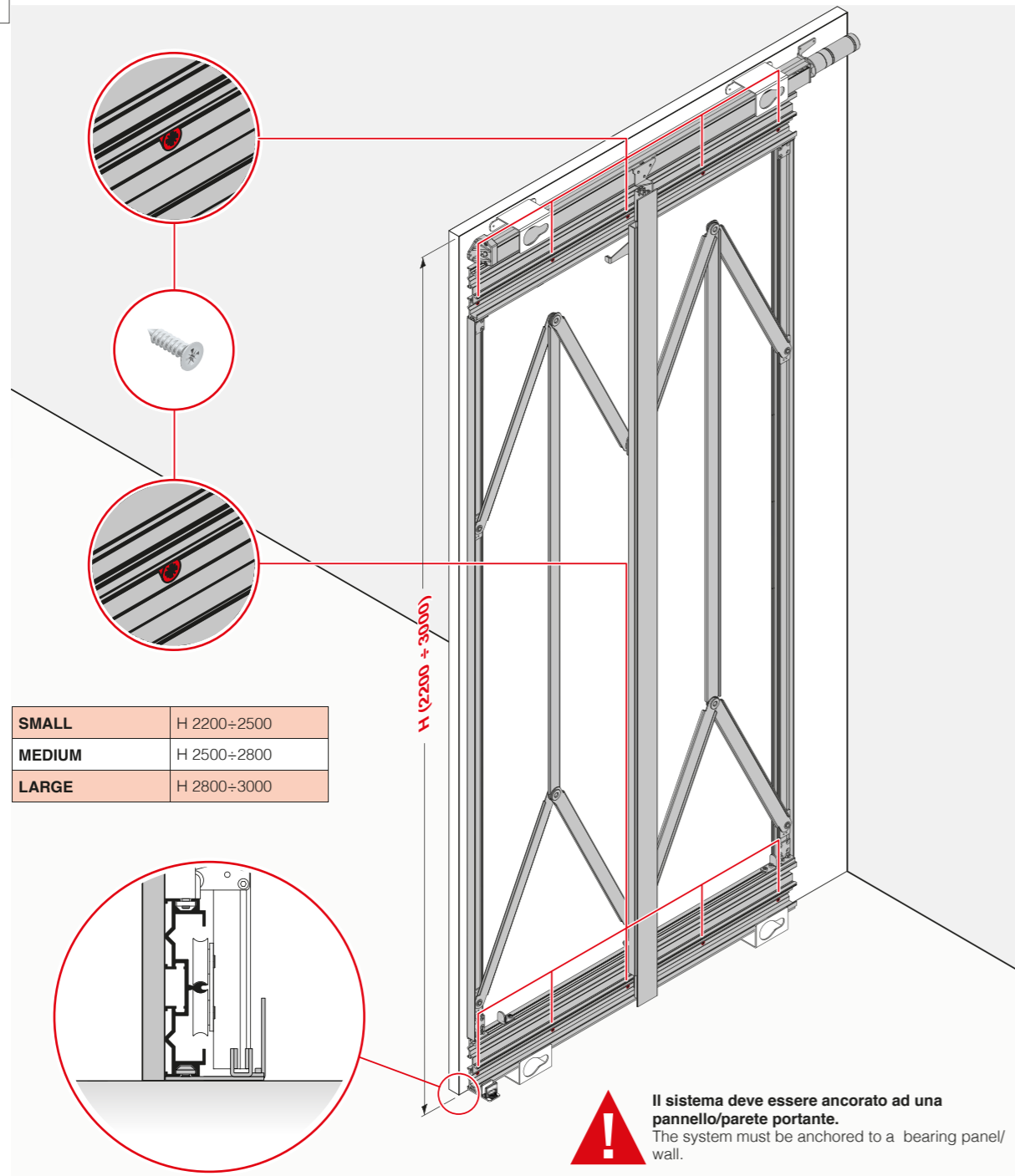

SMALL	H 2200+2500
MEDIUM	H 2500+2800
LARGE	H 2800+3000

! Il sistema deve essere ancorato ad una pannello/parete portante.
The system must be anchored to a bearing panel/wall.

2

R

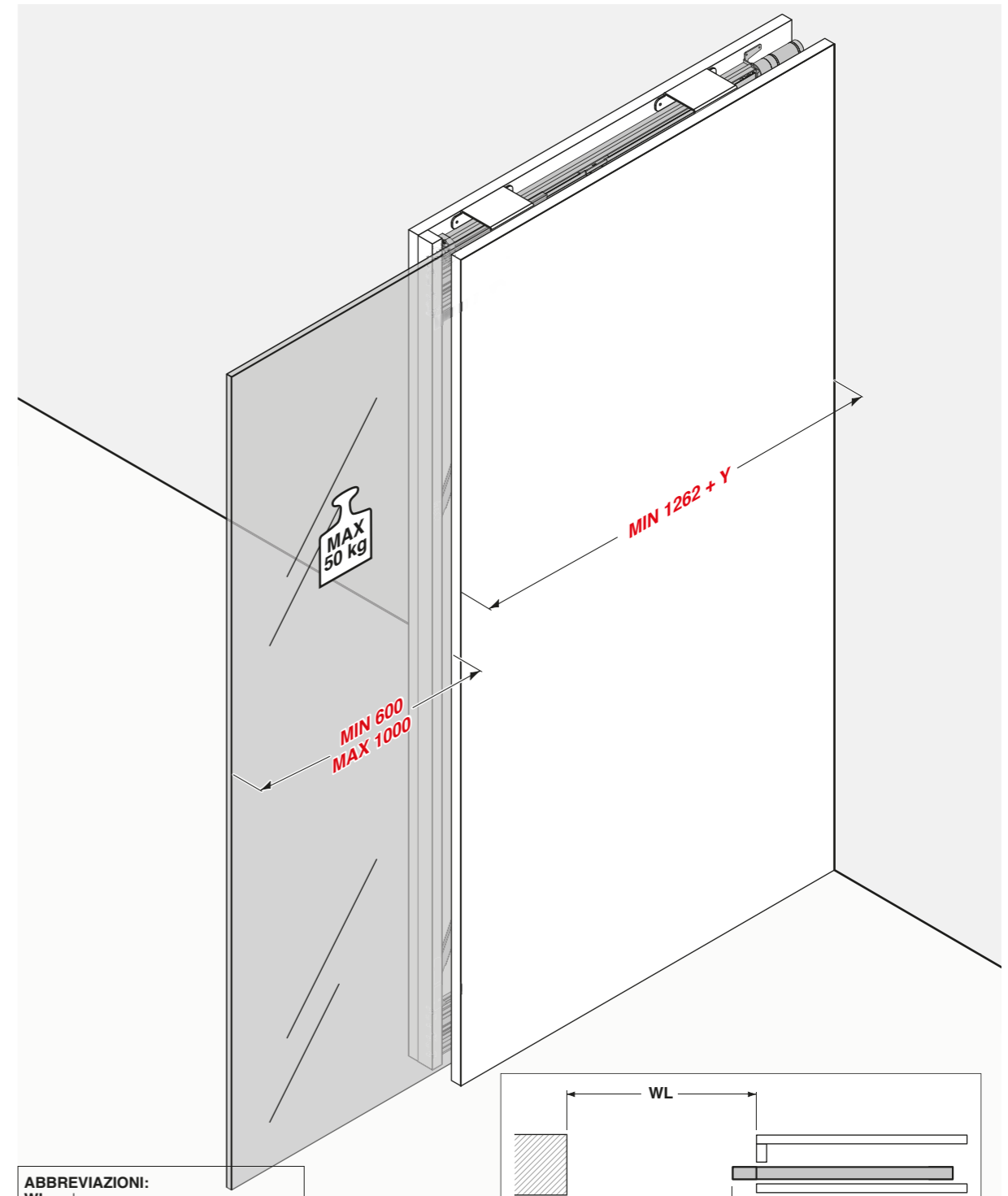

ABBREVIAZIONI:
WL = luce vano
X = porzione di porta sempre a vista
ABBREVIATIONS:
WL = clear opening
X = portion of door always visible

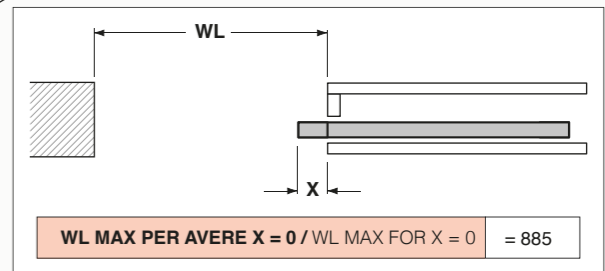

B-moved[®]

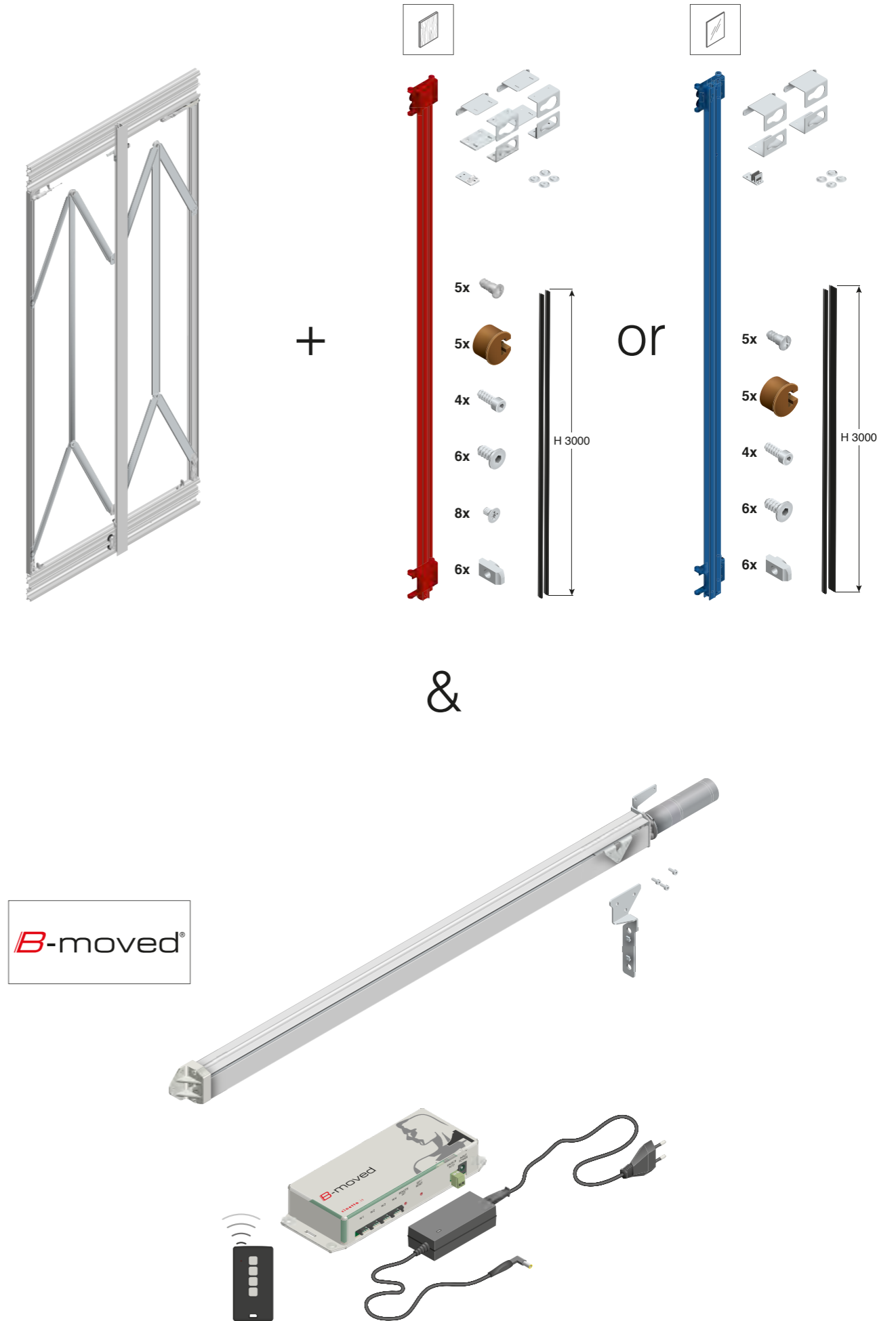
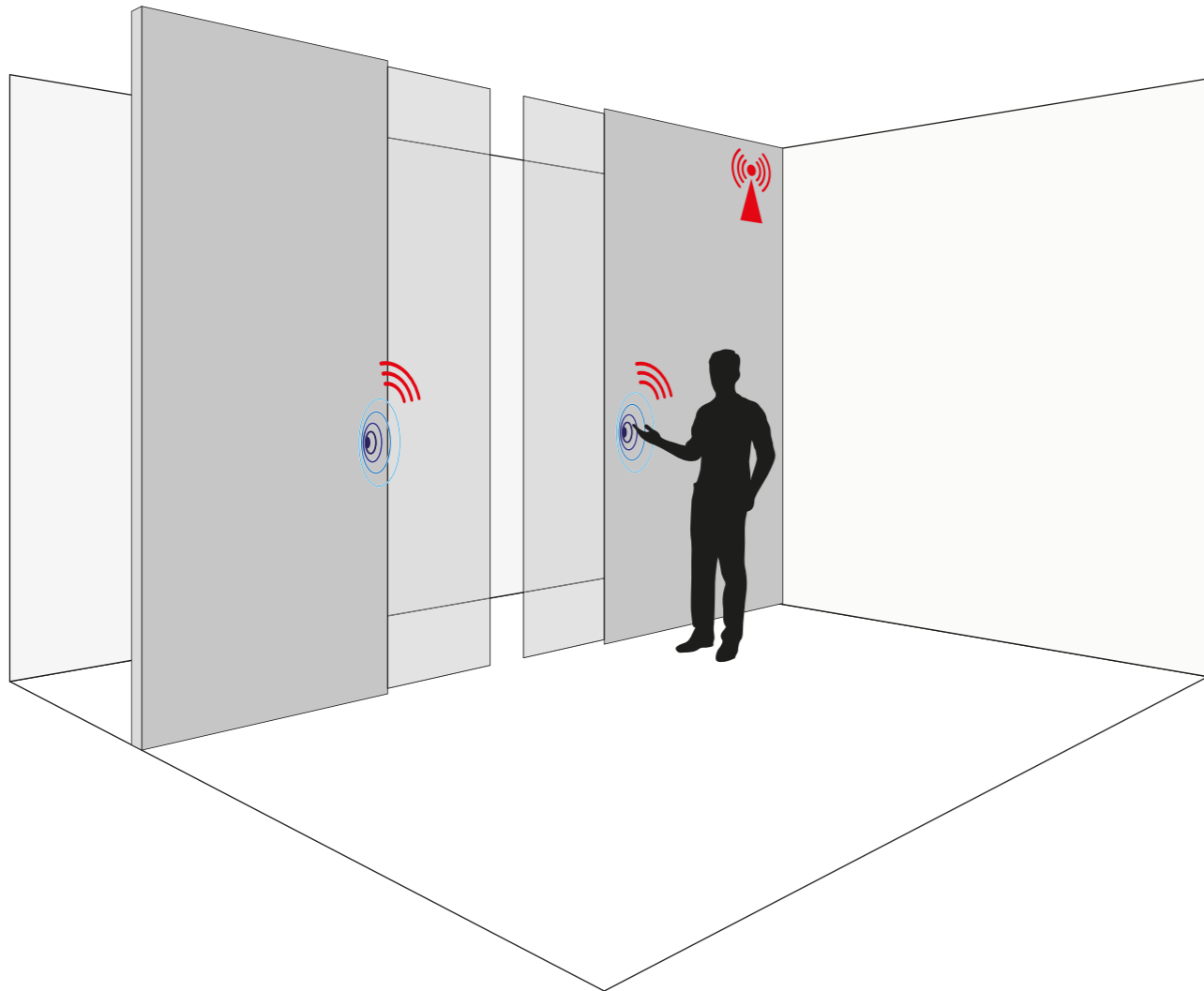

B-moved[®]

Lista componenti / Parts list

PS66MDSM70000001	SMALL
PS66MDSM70000002	MEDIUM
PS66MDSM70000003	LARGE

Meccanismo dx per porta scorrevole a scomparsa.
Finitura: Grezzo

Right system for concealed sliding door.
Finish: Raw



Version	Manual	& B-moved
SMALL	H 2100÷2400	H 2200÷2500
MEDIUM	H 2400÷2700	H 2500÷2800
LARGE	H 2700÷3000	H 2800÷3000



PS66MSSM70000001	SMALL
PS66MSSM70000002	MEDIUM
PS66MSSM70000003	LARGE

Meccanismo sx per porta scorrevole a scomparsa.
Finitura: Grezzo

Left system for concealed sliding door.
Finish: Raw



Version	Manual	& B-moved
SMALL	H 2100÷2400	H 2200÷2500
MEDIUM	H 2400÷2700	H 2500÷2800
LARGE	H 2700÷3000	H 2800÷3000

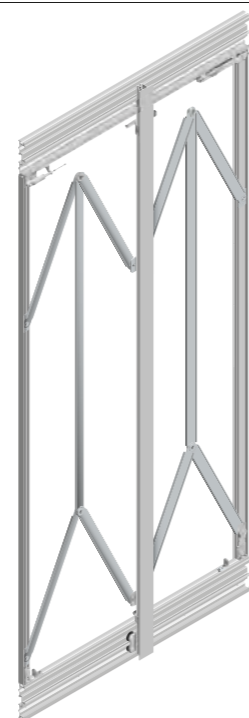

PS66. Lista componenti / Parts list

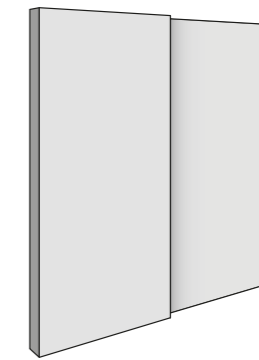
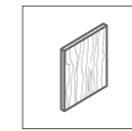

PS66PDLE70000001	H 2100÷2400
PS66PDLE70000002	H 2400÷2700
PS66PDLE70000003	H 2700÷3000

Confezione di montaggio per porta legno dx.
Finitura: Grezzo

Assembly kit for right wooden door.
Finish: Raw



Version	Manual	& B-moved
SMALL	H 2100÷2400	H 2200÷2500
MEDIUM	H 2400÷2700	H 2500÷2800
LARGE	H 2700÷3000	H 2800÷3000

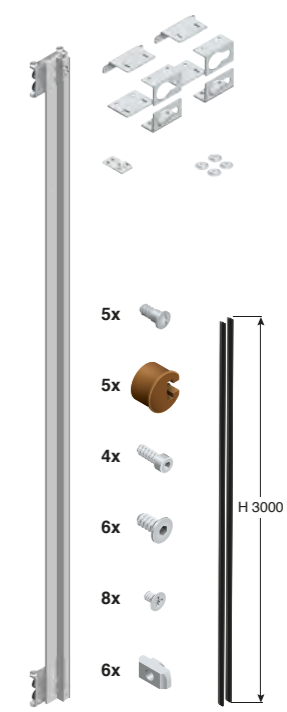

PS66PSLE70000001	SMALL
PS66PSLE70000002	MEDIUM
PS66PSLE70000003	LARGE

Confezione di montaggio per porta legno sx.
Finitura: Grezzo

Assembly kit for left wooden door.
Finish: Raw



Version	Manual	& B-moved
SMALL	H 2100÷2400	H 2200÷2500
MEDIUM	H 2400÷2700	H 2500÷2800
LARGE	H 2700÷3000	H 2800÷3000

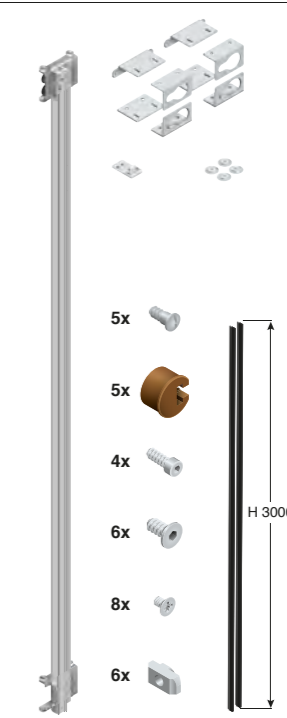

PS66. Lista componenti / Parts list

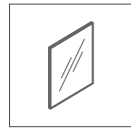

- PS66PDVE7000001** SMALL
- PS66PDVE7000002** MEDIUM
- PS66PDVE7000003** LARGE

Confezione di montaggio per porta vetro dx.
Finitura: Grezzo

Assembly kit for right glass door.
Finish: Raw



Version	Manual	& B-moved
SMALL	H 2100÷2400	H 2200÷2500
MEDIUM	H 2400÷2700	H 2500÷2800
LARGE	H 2700÷3000	H 2800÷3000

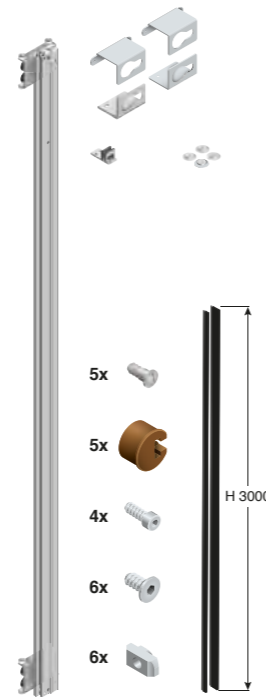

- PS66PSVE7000001** SMALL
- PS66PSVE7000002** MEDIUM
- PS66PSVE7000003** LARGE

Confezione di montaggio per porta vetro sx.
Finitura: Grezzo

Assembly kit for left glass door.
Finish: Raw



Version	Manual	& B-moved
SMALL	H 2100÷2400	H 2200÷2500
MEDIUM	H 2400÷2700	H 2500÷2800
LARGE	H 2700÷3000	H 2800÷3000

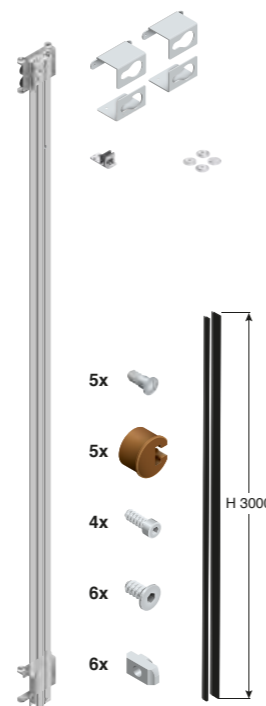

PS66. Lista componenti / Parts list

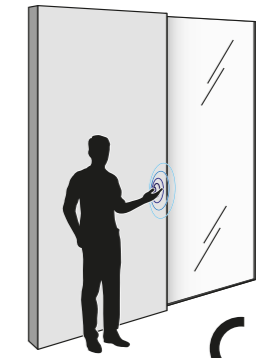

PS66KE70020001

Confezione sistema B-moved per porta dx.
Finitura: Anodizzato argento chimico

B-moved system kit for right door.
Finish: Chemical silver anodized



PS66KE70020002

Confezione sistema B-moved per porta sx.
Finitura: Anodizzato argento chimico

B-moved system kit for left door.
Finish: Chemical silver anodized

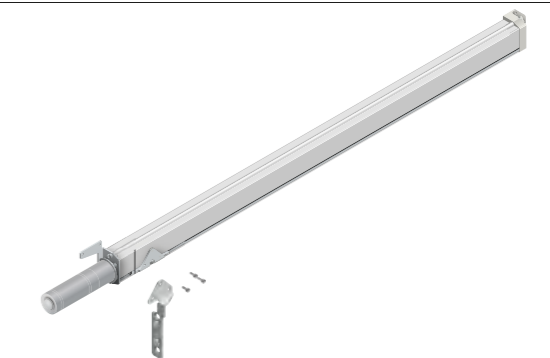

BM01CE8B000007

Unità di controllo elettronico con telecomando per sistema PS66 & B-moved.

Electronic unit control with remote control for PS66 & B-moved system.



BM01SE8B000002

Unità ricevente Wave Sensor.

Wave Sensor receiver unit.



BM01CO9000001

Connettore per ingresso ausiliario di controllo.
Finitura: Nero

Connector for auxiliary control input.
Finish: Black

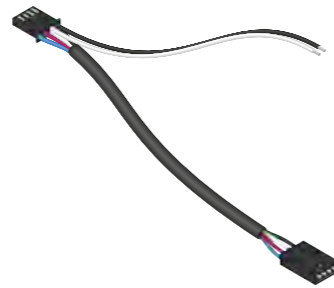

BM01SE9000001

Wave Sensor con adattatore per il montaggio. Batterie non incluse.
Finitura: Nero

Wave Sensor with assembling accessory. Batteries not included.
Finish: Black

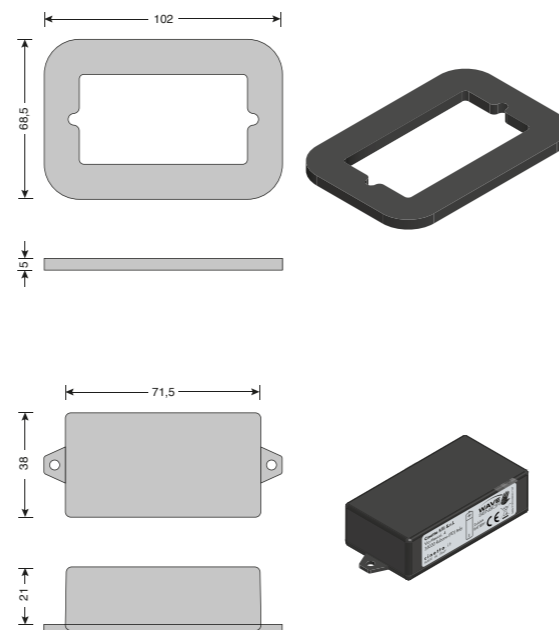



Non utilizzare spray ed oli anti frizione o sblocca filetti sui cuscinetti o sulle ruote con O-ring dei pattini scorrevoli. Questo provoca lo scioglimento dei grassi dei cuscinetti rendendoli rumorosi oppure la rottura dell'O-ring.

Do not use any anti-friction oil or grease or thread-release spray on ball bearing or on wheels with O-ring, it can cause the melting of the inside ball bearing grease, making them noisy or causing the break of the O-ring of the wheels.

Tutte le parti del catalogo sono di proprietà della Cinetto F.Ili S.r.l.

È vietata qualsiasi imitazione e copia delle illustrazioni, della grafica e la riproduzione, anche parziale, del presente catalogo senza autorizzazione.

I disegni tecnici e le informazioni dimensionali, incluse le illustrazioni, riportate in questo catalogo non sono vincolanti. L'azienda si riserva il diritto di apportare modifiche a fini migliorativi. Tutte le dimensioni sono in mm, se non diversamente specificate.

Si declina ogni responsabilità per errori di stampa.

All constituents of the catalogue are the property of Cinetto F.Ili S.r.l.

Reprint of the catalogue or extracts thereof, reprinting or imitation of the illustrations or imitation of the design is forbidden without permission.

The technical representations and dimensional information in this catalogue are non-binding, including those in the illustrations and drawings. Right reserved to make design improvements. All dimensions are in mm unless otherwise specified.

No liability accepted for printing errors of the catalogue.

Rilasciato da - Issued by
Cinetto F.Ili S.r.l.
Via Meucci, 4 - 35030 Rubano (PD) Italy

Tel. +39 049 8977211 - Fax +39 049 635822

Internet: www.cinetto.it - Email: info@cinetto.it

Giugno 2022
© by Cinetto F.Ili S.r.l.
All rights reserved.
Printed in Padova - Italy



Sede Legale e Officina di Produzione

Via Meucci, 4 - 35030 Rubano (PD) Italy

www.cinetto.it - info@cinetto.it

Sede Amministrativa, Magazzino e Punto Vendita

Via Rossi, 5/A - 35030 Rubano (PD) Italy
Tel. +39 049 8977211 - Fax +39 049 635822
C.F./P.I. (VAT) (IT) 00277120283

